

Want more light? We've got it!

Now available in three high-output models.

X34[®]

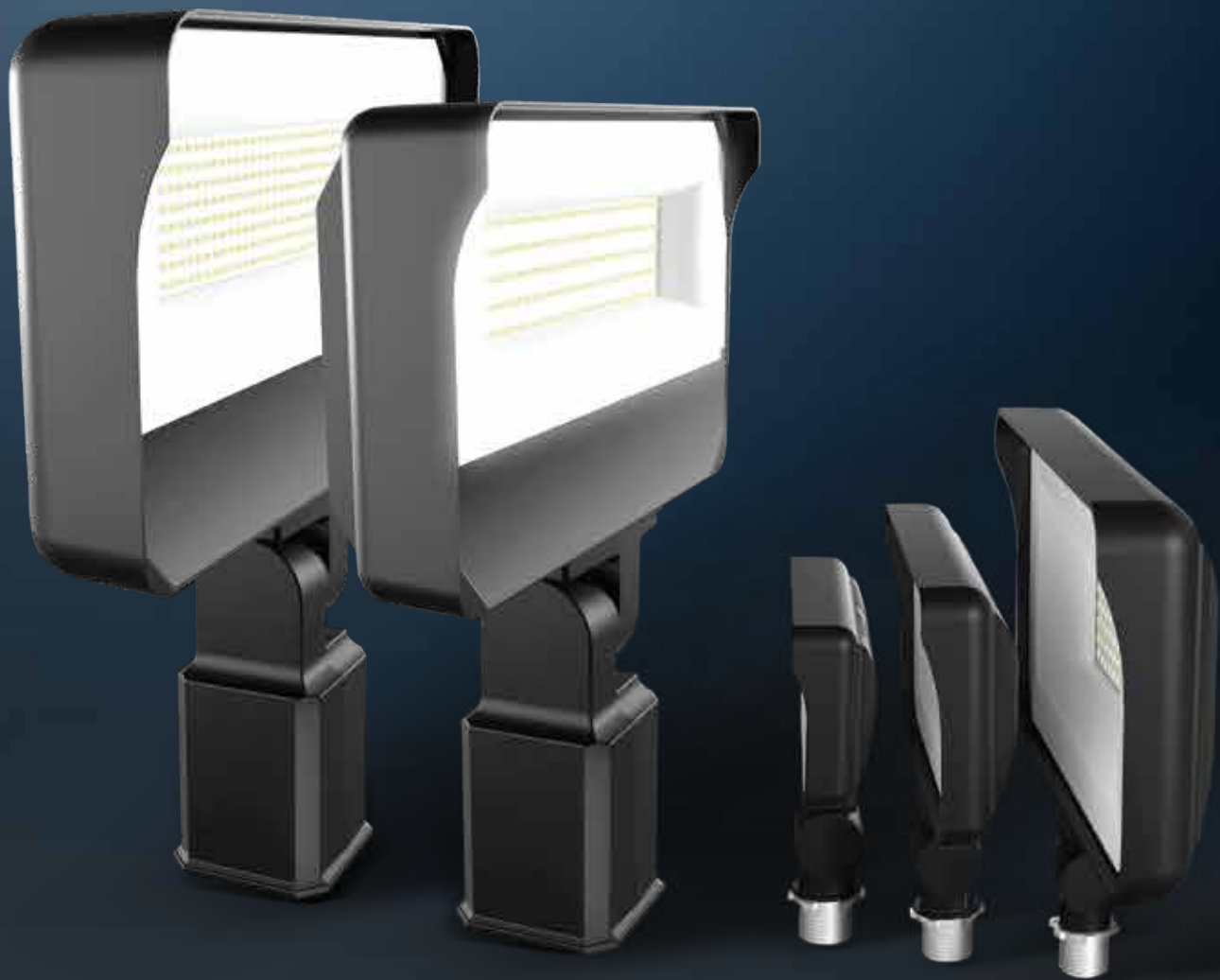

RAB

X34® FLOODLIGHT

- General purpose floodlight
- Replaces up to 400W MH
- Available in 8 lumen packages:
 - 19,500lm (160W)
 - 15,000lm (130W)
 - 10,000lm (87W)
 - 6,500lm (64W)
 - 5,500lm (55W)
 - 3,500lm (35W)
 - 2,500lm (25W)
 - 1,600lm (15W)
- Universal voltage and 0-10V dimming come standard on the 10,000lm, 15,000lm and 19,500lm models
- IP65 rating protects against dust and water
- 50,000-Hour LED lifespan confirmed by TM-21 reported values



RAB's warranty is subject to all terms and conditions found at rablighting.com/warranty.



Visit rablighting.com to see which models are DLC listed.



High-reflectance white reflector maximizes output, and the tempered glass lens won't yellow.



With 8 lumen packages, the versatile X34 is suitable for various applications (*including ground mounting*).



The 16L, 25L, 35L, 55L and 65L models come with a robust 1/2 NPSM knuckle mount. The 100L, 150L and 195L models are available with either a trunnion or slipfitter mount.

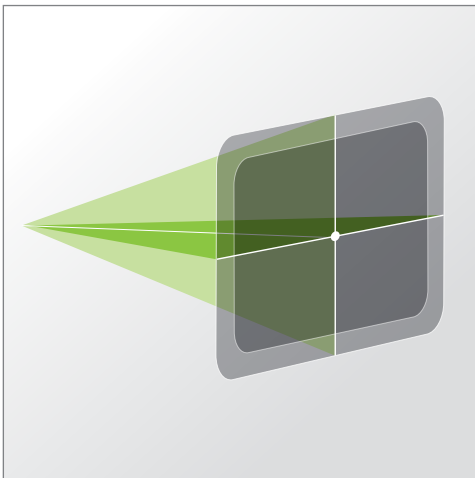

Very wide NEMA 7H x 7V beam spread is ideal for general purpose lighting.



All models have an integrated visor that reduces observable glare.



IP65 rating for complete protection against dust and low-pressure water jet ingress.

X34 - 1,600lm

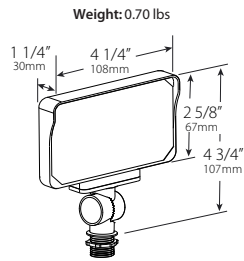

X34 1,600lm - 15W (Replaces up to 70W MH)

Color Temperature	5000K	3000K
Input Watts	15	15
Output Lumens (lm)	1522	1505
Efficacy (lm/W)	103	102
Color Accuracy (CRI)	85	84

15W - 1600lm

15' Mounting Ht, aimed 30° below horizon

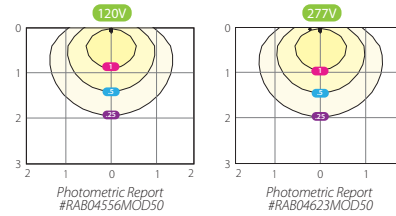

X34 - 2,500lm & 3,500lm

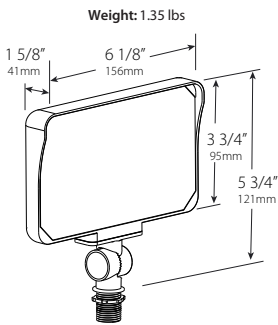

X34 2,500lm - 25W (Replaces up to 100W MH)

Color Temperature	5000K	3000K
Input Watts	24	25
Output Lumens (lm)	2446	2416
Efficacy (lm/W)	103	97
Color Accuracy (CRI)	84	84

25W - 2500lm

15' Mounting Ht, aimed 30° below horizon

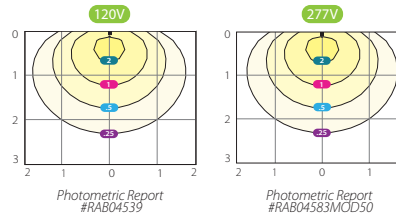

X34 3,500lm - 35W (Replaces up to 150W MH)

Color Temperature	5000K	3000K
Input Watts	34	36
Output Lumens (lm)	3501	3463
Efficacy (lm/W)	103	97
Color Accuracy (CRI)	85	84

35W - 3500lm

15' Mounting Ht, aimed 30° below horizon

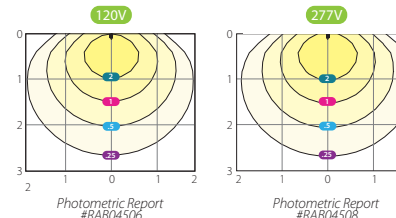

X34 - 5,500lm & 6,500lm

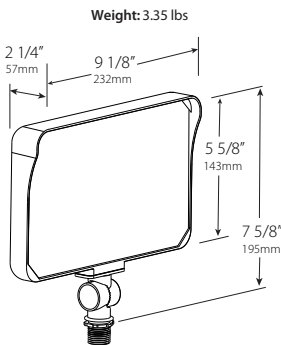

X34 5,500lm - 55W (Replaces up to 175W MH)

Color Temperature	5000K	3000K
Input Watts	55	55
Output Lumens (lm)	5514	5459
Efficacy (lm/W)	100	99
Color Accuracy (CRI)	83	84

64W - 6500lm

15' Mounting Ht, aimed 30° below horizon

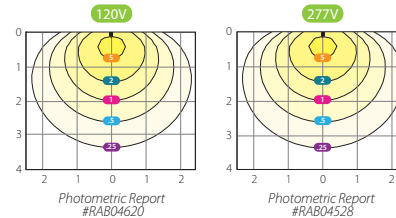

X34 6,500lm - 64W (Replaces up to 250W MH)

Color Temperature	5000K	3000K
Input Watts	64	65
Output Lumens (lm)	6496	6303
Efficacy (lm/W)	101	97
Color Accuracy (CRI)	85	84

55W - 5500lm

15' Mounting Ht, aimed 30° below horizon

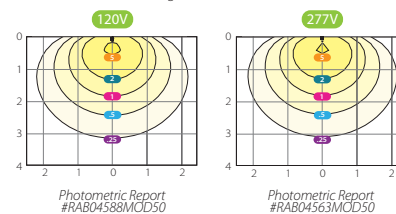

Details and Performance (Cont'd)

X34 - 10,000lm

SLIPFITTER

Weight: 7.11 lbs

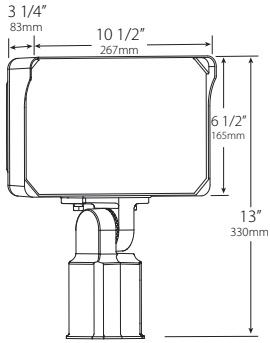

TRUNNION

Weight: 7.44 lbs

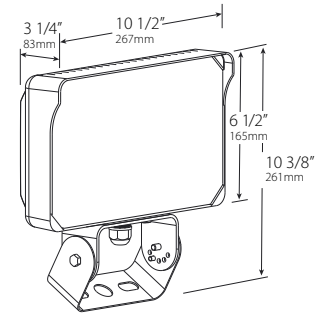

X34 10,000lm - 87W (Replaces up to 250W MH)

Color Temperature	5000K	3000K
Input Watts	87	87
Output Lumens (lm)	10,619	10,460
Efficacy (lm/W)	122	121
Color Accuracy (CRI)	83	82

87W - 10,000lm

20' Mounting Ht, aimed 30° below horizon

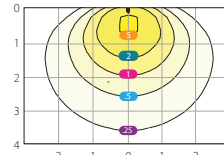

Photometric Report
#X34-100LSF-U DLF1907101-2A C.I.E.S

X34 - 15,000lm & 19,500lm

SLIPFITTER

Weight: 10.05 lbs

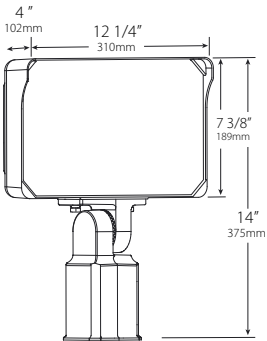

X34 15,000lm - 130W (Replaces up to 400W MH)

Color Temperature	5000K	3000K
Input Watts	131	130
Output Lumens (lm)	16,651	16,152
Efficacy (lm/W)	127	124
Color Accuracy (CRI)	83	82

130W - 15,000lm

25' Mounting Ht, aimed 30° below horizon

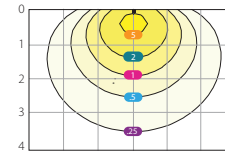

Photometric Report
#X34-155LSF-U DLF1907101-4A C.I.E.S

TRUNNION

Weight: 10.41 lbs

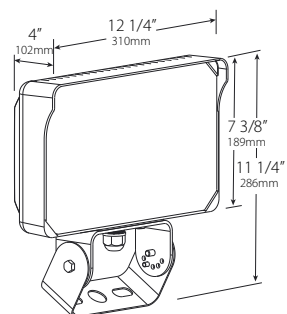

X34 19,500lm - 160W (Replaces up to 400W MH)

Color Temperature	5000K	3000K
Input Watts	161	160
Output Lumens (lm)	20,381	19,544
Efficacy (lm/W)	127	122
Color Accuracy (CRI)	83	82

160W - 19,500lm

25' Mounting Ht, aimed 30° below horizon

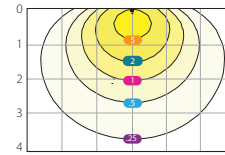

Photometric Report
#X34-195LSF-U DLF1907101-6A C.I.E.S

Note: based on 120V. Values are typical. +/-10% tolerance.

Specifications

UL:

Suitable for wet locations

LEDs:

Long-life, high-efficacy, surface-mount LEDs

Lifespan:

All have minimum 50,000 hrs. LED lifespan @ L70 based on LM80 test data and TM21 reported results

IP Rating:

Ingress Protection rating of IP65 for dust and water

Driver:

X34-16L (15W): 0.13A @ 120V; 0.06A @ 277V

X34-25L (25W): 0.21A @ 120V; 0.09A @ 277V

X34-35L (35W): 0.30A @ 120V; 0.13A @ 277V

X34-55L (55W): 0.47A @ 120V; 0.20A @ 277V

X34-65L (64W): 0.55A @ 120V; 0.24A @ 277V

Constant Current, Class 2, 120-277V, 50/60 Hz

X34-100L (87W): 0.73A @ 120V; 0.42A @ 208V;
0.37A @ 240V; 0.33A @ 277A

X34-150L (130W): 1.10A @ 120V; 0.64A @ 208V;
0.55A @ 240V; 0.47A @ 277A

X34-195L (160W): 1.34A @ 120V; 0.78A @ 208V;
0.67A @ 240V; 0.58A @ 277A

(Wattage values listed above are approximate, see performance tables or product specification sheets for actuals)

Housing:

Die-cast aluminum

Mounting:

16L-65L models: Robust knuckle mount with 180° adjustable swivel arm. Tilt angle in 10° increments.

100L-195L models: Trunnion with tilt angle in 30° increments or slipfitter with tilt angle in 10° increments.

Lens:

Tempered glass

Finish:

Formulated for high durability and long-lasting color

NEMA Type:

NEMA Beam Spread of 7H x 7V

Ambient Operating Temperature:

-40°C (-40°F) to 40°C (104°F)

Color Uniformity:

RAB's range of CCT (Correlated Color Temperature) follows the guidelines of the American National Standard for Specifications for the Chromaticity of Solid State Lighting (SSL) Products, ANSI C78.377-2017

Green Technology:

Mercury and UV free. RoHS-compliant components.

Ordering information

Product Family	Lumen Packages	Mounting	CRI & CCT	Voltage
X34	195L 19500lm, 160W 150L 15000lm, 130W 100L 10000lm, 87W 65L 6500lm, 64W 55L 5500lm, 55W 35L 3500lm, 35W 25L 2500lm, 25W 16L 1600lm, 15W	Blank Knuckle Mount* SF Slipfitter** T Trunnion**	Blank 80 CRI, 5000K (Cool) 830 80 CRI, 3000K (Warm)	/120 120V* /277 277V* /U 120-277V**

*Knuckle Mount available only for 16L, 25L, 35L, 55L and 65L models. Must specify voltage, 120V or 277V.

**Slipfitter and Trunnion Mounts available only for 100L, 150L and 195L models. Universal voltage standard, 120-277V.

Note: Lumen values are nominal

For more details contact:
888.722.1000 • salesinquiry@rablighting.com

Learn more:
rablighting.com
lightcloud.com

For the latest product literature and catalogs:
download the rabdrive app

Get the app



Follow us



RAB[®]

RAB is continually improving our products. Specifications may change without notice.
The designs of RAB fixtures are protected under U.S. and international intellectual property laws.