

HAZX for Hazardous Locations



HAZX40/HAZX80
(w/YOKE MOUNT)



HAZX40/HAZX80
(w/STANCHION MOUNT)



PROJECT:

DATE:

TYPE:

PREPARED BY:

HAZX100/HAZX150/HAZX200
(w/YOKE MOUNT)



HAZX100/HAZX150/HAZX200
(w/STANCHION MOUNT)



KEY FEATURES

- Available in following sized and five wattages
Small: 40W and 80W
Large: 80W, 100W and 150W
 - Available CCT: 5000K
 - Voltage rating 120-277V. 480V also offered in 100W, 150W, 200W models.
 - Designed to perform in the areas with **hazardous vapor and gases**
 - Wire guards** provided on all models
 - All fixtures comes with standard **yoke** mount. **Stanchion** mounting kit included.
 - Certified for use in:
Class I, Division 1 (Groups B, C, D), Class I, Division 2 (Groups A, B, C, D),
Class II, Division 1 (Groups E, F, G), Class II, Division 2 (Groups F, G)
 - Class III
- 5-Year, no-compromise warranty

HAZX Hazardous Locations Light



0-10V

* 480V Only
120-277V Models are
1-10V dimming



100,000
HOURS



IP RATING



WET
RATED



IK10 RATED
WITH GUARDS
IK08 RATED
WITHOUT GUARD

PERFORMANCE

MODEL#	HAZX40CF	HAZX80CF	HAZX100CF	HAZX150CF	HAZX200CFW
WATTAGE	40W	80W	100W	150W	200W
INPUT WATTS	39.0W	80.6W	100.0W	152.6W	197.4W
LUMENS	5,394	11,203	15,613	23,666	29,520
EFFICACY	138.3	139.0	156.1	155.1	149.5
CRI	80	80	80	80	80
VOLTAGE RATINGS	120-277V				

MODEL#	HAZX100CF	HAZX150CF	HAZX200CFW
WATTAGE	100W	150W	200W
INPUT WATTS	100.3W	149.1W	200.7W
LUMENS	15,707	23,715	31,312
EFFICACY	156.6	159.1	156.0
CRI	80	80	80
VOLTAGE RATINGS	480V		

HAZX for Hazardous Locations



PERFORMANCE

MODEL# w/Wire Guards	HAZX40CF	HAZX80CF	HAZX100CF	HAZX150CF	HAZX200CFW
WATTAGE	40W	80W	100W	150W	200W
INPUT WATTS	39.0W	80.6W	100.0W	152.6W	197.4W
LUMENS	4,777	9,929	13,186	19,981	24,987
EFFICACY	122.5	123.2	131.9	130.9	126.6
CRI	80	80	80	80	80
VOLTAGE RATINGS	120-277V				

MODEL# w/Wire Guards	HAZX100CF	HAZX150CF	HAZX200CFW
WATTAGE	100W	150W	200W
INPUT WATTS	101.1W	148.8W	198.6W
LUMENS	12,769	19,436	25,355
EFFICACY	126.3	130.6	127.7
CRI	80	80	80
VOLTAGE RATINGS	480V		

TECHNICAL SPECIFICATIONS

COMPLIANCE

Hazardous Location Classifications

Class I: A hazardous location in which flammable gases or vapors may be present in the air in sufficient quantities to be explosive or ignitable, such as petroleum refineries, aircraft hangars, dry cleaning plants, utility gas plants or storage areas for liquified petroleum or natural gas, and spray finishing areas.

Class II: A hazardous location in which combustible dust may be present

Class III: A hazardous location in which easily ignitable fibers or flyings may be present

Division 1: Ignitable concentrations of hazards exist under normal operation condition and /or where the hazard is caused by frequent maintenance or repair work or frequent equipment failure.

Division 2: Abnormal condition, where ignitable concentrations of flammable gases, vapors or liquids are not like to exist under normal operating conditions, for example:

Closed storage drums containing flammable liquids in an inside storage room would not normal allow the hazardous vapors to escape into the atmosphere. But if one of the containers is leaking, you've got an abnormal condition.

Groups A - D: The gases and vapors of Class 1 locations are broken into four groups by the Code: A,B,C, and D. These materials are grouped according to the ignition temperature of the substance, its explosion pressure, and other flammable characteristics.

Group A - The only substance in group A is acetylene because it is a gas with extremely high explosion pressures.

Group B - This group includes hydrogen and other materials with similar characteristics.

Group C & D - The most usual Class 1 groups. They comprise the greatest percentage of all Class I hazardous locations. Found in Group C is ethylene. Found in Group D are many of the most common flammable substances such as butane, gasoline, natural gas and propane

Group E: Combustible metal dusts: aluminum, commercial alloys and coke dusts

COMPLIANCE

Group F: Combustible carbonaceous dusts: carbon black, charcoal, coal and coke dusts

Group G: Other combustible dusts: Chemicals, flour, grain, plastic and wood.

UL 844:

Electric lighting fixtures for use in hazardous (classified) locations

UL 1598:

Electric lighting fixtures for use in non-hazardous locations

UL 1598A:

Electric lighting fixtures for use on marine vessels

UL Listed:

Suitable for wet locations

IESNA LM-79 & LM-80 Testing:

RAB LED luminaires and LED components have been tested by an independent laboratory in accordance with IESNA LM-79 and LM-80.

IP Rating:

Ingress protection rating of IP66 for dust and water

IK Ratings:

Models with Guard: IK10 rated for protection against impact

Models without Guards: IK08 rated for protection against impact

DLC Listed:

This product is on the Design Lights Consortium (DLC) Qualified Products

MODEL#	PRODUCT ID	MODEL#	PRODUCT ID
HAZX40CF	S-QKSMP0	HAZX100CF/480	S-23GMNM
HAZX80CF	S-JJLN47	HAZX150CF/480	S-K2ZTPH
HAZX100CF	S-SJ3QKH	HAZX200CF/480	S-0V6ZFH
HAZX150CF	S-HTGC80		
HAZX200CF	S-YKN82T		

HAZX for Hazardous Locations



TECHNICAL SPECIFICATIONS

CONSTRUCTION

Maximum Ambient / ColdWeather Starting Temperature:

MODEL#	Max Ambient Temp	Cold Weather Starting Temp	T-Code
HAZX40CF	131°F (55°C)	-40 °C (-40°F)	T6
HAZX80CF	104°F (40°C)	-40 °C (-40°F)	
HAZX100CF	149°F (65°C)	-40 °C (-40°F)	
HAZX100CF/480	149°F (65°C)	-40 °C (-40°F)	
HAZX150CF	122°F (50°C)	-40 °C (-40°F)	T5
HAZX150CF/480	131°F (55°C)	-40 °C (-40°F)	
HAZX200CF	104°F (40°C)	-40 °C (-40°F)	
HAZX200CF/480	"113°F (45°C) 131°F (55°C) due to two voltages-low & high voltage, so the testing voltage is different, so two temperatures	-40 °C (-40°F)	

Housing:

Die-cast aluminum

Mounting:

Surface and pendant mount. Remove yoke for pendant mount.

Lens/Globes:

Clear flat glass lens

Gaskets:

High-temperature silicone

Green Technology:

Mercury and UV free. RoHS-compliant.

Finish:

Formulated for high durability and long-lasting color

ELECTRICAL

Drivers:

Constant Current, Class 2, 120-277V, 50/60 Hz

HAZX40CF: 120V: 0.42A, 208V: 0.24A, 240V: 0.20A, 277V: 0.18A

HAZX80CF: 120V: 0.84A, 208V: 0.48A, 240V: 0.42A, 277V: 0.36A

Constant Current, Class 1, 120-277V, 50/60 Hz

HAZX100CF: 120V: 1.04A, 208V: 0.59A, 240V: 0.52A, 277V: 0.45A

HAZX150CF: 120V: 1.56A, 208V: 0.89A, 240V: 0.78A, 277V: 0.68A

HAZX200CF: 120V: 2.08A, 208V: 1.20A, 240V: 1.04A, 277V: 0.89A

Constant Current, Class 1, 480V, 50/60 Hz

HAZLED100CF/480: 480V: 0.29A

HAZLED150CF/480: 480V: 0.44A

HAZLED200CF/480: 480V: 0.57A

Dimming Driver:

120-277V: Driver includes wiring for 1-10V dimming systems.

480V: Driver includes wiring for 0-10V dimming systems.

THD:

HAZX40CF: 3.52% @120V, 11.73% at 277V

HAZX80CF: 4.72% @120V, 14.61% at 277V

HAZX100CF: 3.84% @120V, 11.41% at 277V

HAZX150CF: 5.40% @120V, 12.80% at 277V

HAZX200CF: 6.03% @120V, 8.70% at 277V

HAZX100CF/480: 11.15% @480V

HAZX150CF/480: 11.11% @480V

HAZX200CF/480: 7.90% @480V

ELECTRICAL

Power Factor:

HAZX40CF: 99.6% @120V, 92.0% at 277V

HAZX80CF: 99.7% @120V, 95.8% at 277V

HAZX100CF: 99.8% @120V, 96.6% at 277V

HAZX150CF: 99.5% @120V, 89.3% at 277V

HAZX200CF: 99.8% @120V, 91.0% at 277V

HAZX100CF/480: 93.1% @480V

HAZX150CF/480: 88.8% @480V

HAZX200CF/480: 93.1% @480V

Surge Protection

L-N: 6kV, L/N-FG: 10kV

LED CHARACTERISTICS

Color Consistency

7-step MacAdam Ellipse binning to achieve consistent fixture-to-fixture color

Color Uniformity

RAB's range of Correlated Color Temperature follows the guidelines of the American National Standard for Specifications for the Chromaticity of Solid State Lighting (SSL) Products, ANSI C78.377-2017.

OTHER

Warranty

The RAB 5-year, no-compromise warranty covers light output, color stability, driver performance, paint finish and labor. RAB's warranty is subject to all terms and conditions found at rablighting.com/warranty.

Lifespan

100,000-hour LED lifespan based on IES LM-80 results and TM-21 calculations

HAZX for Hazardous Locations



DIMENSIONS

HAZX40W / HAZX80W (Yoke mount)

Weight :-

HAZX40CF : 26.2 lbs

HAZX80CF : 27.6 lbs

HAZX100W / HAZX150W / HAZX200W (Yoke mount)

Weight :-

HAZX100CF : 44.8 lbs

HAZX150CF : 46.7 lbs

HAZX200CF : 47.18 lbs

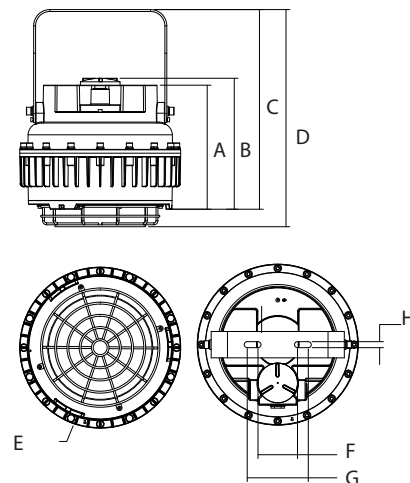
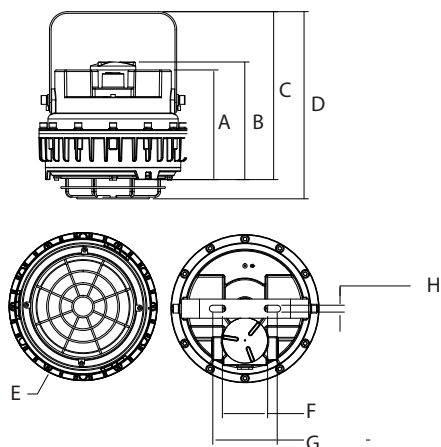

MODELS W/YOKE MOUNT	A	B	C	D	E	F	G	H
HAZX40CF/HAZ80CF	7 ⁷ / ₈ "	8 ⁷ / ₁₆ "	12 ¹ / ₁₆ "	16 ⁷ / ₁₆ "	Ø10 ⁵ / ₈ "	4 ⁵ / ₈ "	3 ¹ / ₄ "	1 ¹ / ₂ "
HAZX100CF/HAZX150CF/HAZX200CF	10 ³ / ₁₆ "	10 ³ / ₄ "	16 ⁷ / ₁₆ "	17 ¹³ / ₁₆ "	Ø13 ¹ / ₄ "	5"	3 ¹ / ₄ "	1 ¹ / ₂ "

HAZX40W / HAZX80W (Stanchion)

HAZX100W / HAZX150W / HAZX200W (Stanchion)

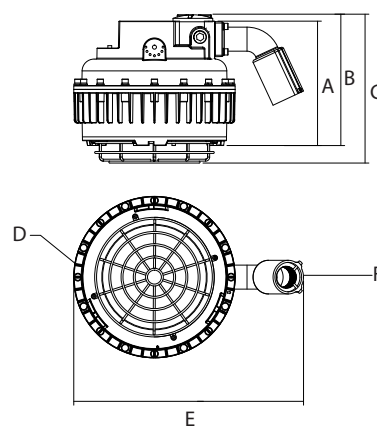
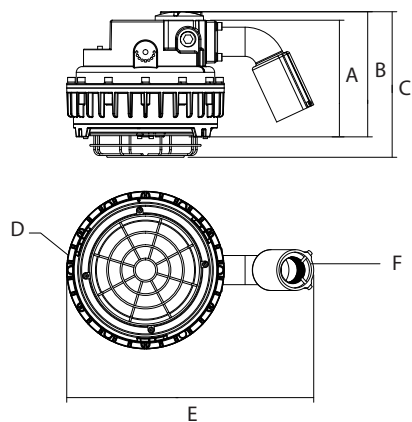

MODELS W/STANCHION	A	B	C	D	E	F (NPT)
HAZX40CF/HAZ80CF	7 ⁷ / ₈ "	8 ⁷ / ₁₆ "	9 ¹³ / ₁₆ "	Ø10 ⁵ / ₈ "	16 ⁵ / ₈ "	1 ¹ / ₂ " - 11 ¹ / ₂ "
HAZX100CF/HAZX150CF/HAZX200CF	10 ³ / ₁₆ "	10 ³ / ₆ "	12 ³ / ₁₆ "	Ø13 ¹ / ₄ "	18 ¹³ / ₁₆ "	1 ¹ / ₂ " - 11 ¹ / ₂ "

HAZX for Hazardous Locations

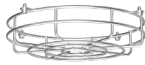
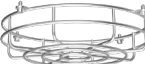

ACCESSORIES

IMAGE	CATALOG#	UPC	DESCRIPTION
	GDHAZXS	192552047876	HAZARDOUS LOCATION WIRED GUARD SMALL FOR 40W 80W
	GDHAZXL	192552047883	HAZARDOUS LOCATION WIRED GUARD LARGE FOR 100W 150W 200W

ORDERING MATRIX

HAZX

Family	Wattage		Color Temp		Mounting		Finish		Lens/Globe		Driver	
HAZX									CF			
40	40W	BLANK	5000K	BLANK	Yoke Mount	BLANK	Gray	CF	Clear Flat lens	BLANK	120-277V, 1-10V Dimming	
80	80W				Installed and					/480*	480V, 0-10V Dimming	
100	100W				Stanchion included							
150	150W											
200	200W											

*480V for 100W, 150W, and 200W model only