

# LED Ready Downlight Housings



NDCANIC4R



NDCANIC6R



RDCANIC4R



RDCANIC6R

## 4" & 6", IC Air-Tight LED Dedicated Housings, New Construction & Remodel



AIRTIGHT



IC RATED



DAMP  
RATED



120V

PROJECT:

DATE:

TYPE:

PREPARED BY:



### KEY FEATURES

- IC rated for direct contact with insulation
- Quick connect provided for electrical connection to the LED trim
- Air-tight in accordance to ASTM E283
- Damp location (*Wet location when used with compatible luminaire*)
- 24-1/2" bar hangers included with captive nails and alignment foot

## TECHNICAL SPECIFICATIONS

### CONSTRUCTION

#### Product Type

IC Air-Tight LED Dedicated Recessed housings

#### Size

4", 6"

#### Housing

0.040 aluminum housing with riveted cap adjusts for ceiling thicknesses from 5/8" to 1-1/4"

#### Nailer Bars

Two 13-3/4" to 24-1/2" adjustable bar hangers with captive nails are included on frame. Hanger bars have T-Bar slot and alignment feet. Bar hangers are parallel to junction box, but can be repositioned 90° perpendicular to junction box if desired. "L" Shaped bar hanger foot to align to bottom of construction joist. A T-Bar notch allows easy installation in a suspended ceiling.

#### Junction Box

Prewired 25 cubic inch 0.064" thick galvanized steel box with seven 1/2" trade size knockouts and snap on covers. All leads are #18AWG wire, the ground wire is connected to the bottom, and quick connectors are supplied on all leads. Maximum of 8 no. 12 AWG through branch circuit conductors suitable for at least 90°C permitted in junction box.

#### Romex Strain Relief

Junction box includes two Romex tabs with two slots at each tab for NM-cables of 12/2 to 14/2. The strain relief allows for easy installation and less materials.

#### Junction Box

ND - New construction housing

RD - Remodel housing

### ELECTRICAL

#### Dimmable

Specified by downlight

#### Input Voltage

120V

#### Operating Temperature

122°F (50°C) max.

#### Socket

Quick connect for LED downlights

### COMPLIANCE

#### Listings

UL Listed

#### Environment

Suitable for use indoors in dry and damp environments.

#### IC Rating

Suitable for direct contact with insulation.

Type IC inherently protected, suitable for direct contact to air permeable insulation and cULus listed for damp locations. Not for use in direct contact with spray foam insulation, consult NEMA LSD57-2013.

#### Air Tight

Airtight certified per ASTM-E283

#### California Title 24 JA8 Compliant

Can be used to conform with the requirements of California Title 24 Part 6.

#### California Energy Commission (CEC) Status

Lawful for Sale in California

#### RoHS

Mercury and UV free. RoHS-compliant components.

## TECHNICAL SPECIFICATIONS (CONT'D)

### INSTALLATION

#### Compatible Products

R34, R4R, R6R, R34X, SUMO, DISK34

### OTHER

#### Warranty

The RAB 5-year, limited warranty covers light output, driver performance and paint finish. RAB's warranty is subject to all terms and conditions found at [rablighting.com/warranty](http://rablighting.com/warranty).

## DIMENSIONS

### NDCANIC4R

Weight: 1.76 lb

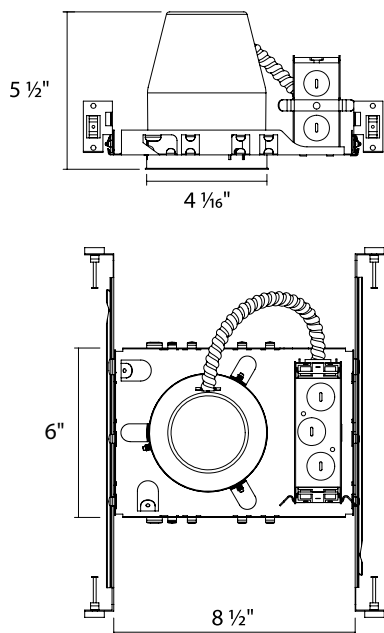

### NDCANIC6R

Weight: 2.12 lb

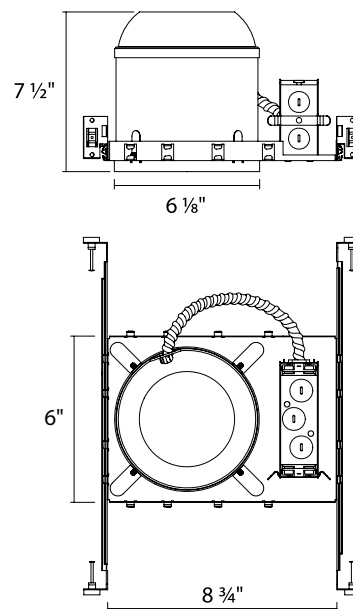

### RDCANIC4R

Weight: 1.1 lbs

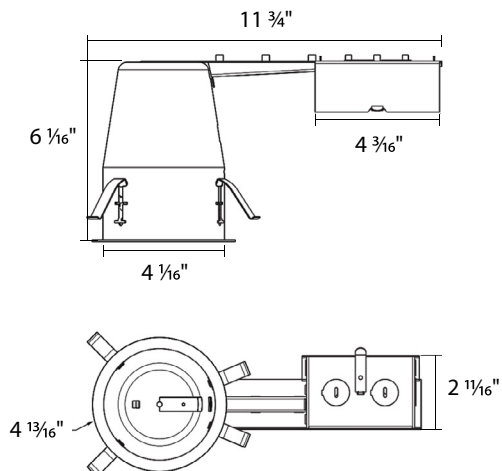

### RDCANIC6R

Weight: 1.19 lbs

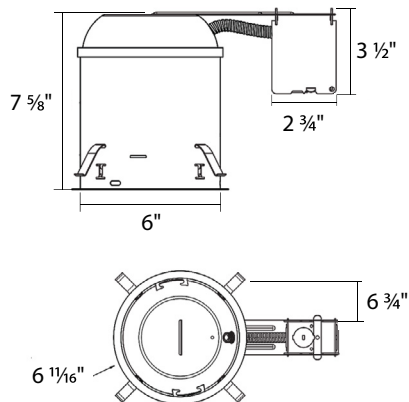

## ORDERING INFO

Catalog	UPC	Case Pack
NDCANIC4R	019813702346	6
NDCANIC6R	019813702353	6
RDCANIC4R	019813702322	6
RDCANIC6R	019813702339	6

## ORDERING MATRIX

Family	IC / Air-Tight		Size/Wattage		Shape	
NDCAN						
New Construction	IC	IC Rated & Air-Tight	4	4"	R	Round
RDCAN			6	6"		
Remodel						