

ARCTAPE COB Tape, Static White



TIC — 24V DC, Indoor-Rated COB Tape Light, Static White & Warm Dimming



* TIC/DW Only

PROJECT: _____

DATE: _____

TYPE: _____

PREPARED BY: _____



KEY FEATURES

- **Continuous band** of flawless light output with no pixelated hot spots — even without a lens.
- **Field-cuttable** every 2 in for shorter runs with a max run of 32 ft 9 5/8". Can be linked with connectors (*sold separately*).
- **Easy installation** to most surfaces by using pre-attached 3M® double-sided tape.
- Available in Static White 2700, 3000, 4000K, or Dim-to-Warm (3000K-1800K).
- 60W & 96W indoor or outdoor rated drivers available (*sold separately*).
- **50,000-hr rated life**, Title 24 Compliant, and 5-year limited warranty.

PERFORMANCE

Catalog Number	Input Voltage	Color Temperature	Length	Input Wattage	Lumens	Efficacy	IP Rating	CRI	Cutting	Max Run
TICYY	24DC	2700K	32 ft 9 5/8" 10m	2.5 W/ft	208 lm/ft	81 lm/W	IP20	90	2"	32 ft 9 5/8"
TICY	24DC	3000K	32 ft 9 5/8" 10m	2.5 W/ft	225 lm/ft	90 lm/W	IP20	90	2"	32 ft 9 5/8"
TICN	24DC	4000K	32 ft 9 5/8" 10m	2.5 W/ft	238 lm/ft	95 lm/W	IP20	90	2"	32 ft 9 5/8"
TIC/DW	24DC	3000K-1800K	32 ft 9 5/8" 10m	2.5 W/ft	225 lm/ft	90 lm/W	IP20	90	2"	32 ft 9 5/8"

ACCESSORIES



Catalog Number	Description	Packaging includes
TUJ2	2-Pin indoor connector kits	1 PCB-PCB connector 1 PCB-Wire connector 1 PCB-Wire-PCB connector

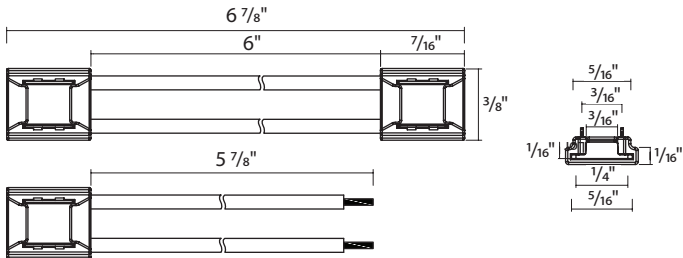

RAB®

ACCESSORIES (CONT.)



Catalog Number	Description	Packaging includes
TIJ2/DW	2-Pin indoor connector kits for dim to warm	1 PCB-PCB connector 1 PCB-Wire connector 1 PCB-Wire-PCB connector

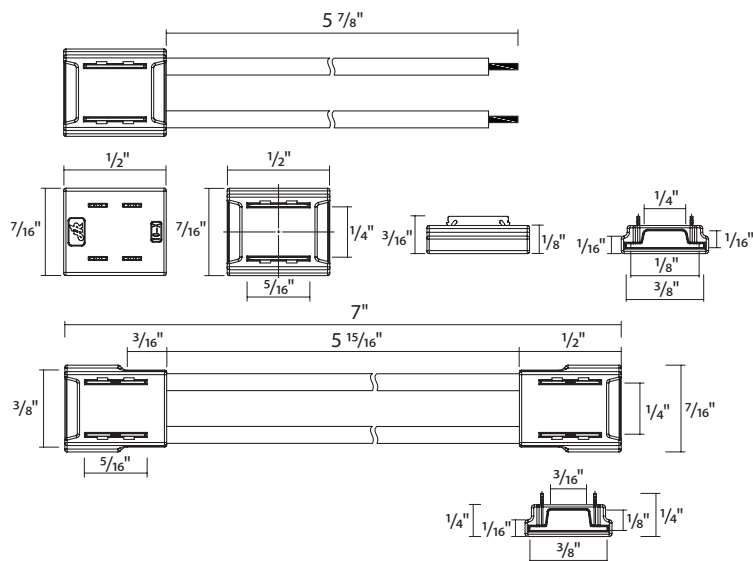

Catalog Number	Description	Packaging includes
TAP12	12mm wide aluminum channel kits	2 clips & screws for mounting Milky frosted diffuser 1 endcap with hole 1 endcap without hole

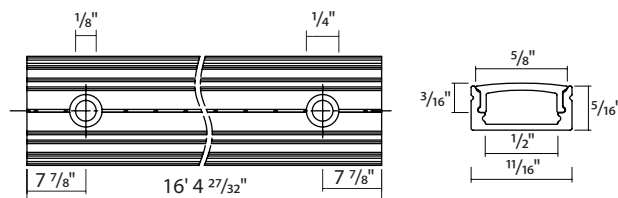

DRIVERS



Catalog Number	Description	Max/Min Load	Input Voltage	Output Voltage	Rated Current	Dimmable
TID-60	60W Linear Driver	60W/6W	100-277V AC	24V DC	2.5A	Yes*
TID-96	96W Linear Driver	96W/9.6W	100-277V AC	24V DC	4A	Yes*
TOD-96	96W Outdoor Constant Voltage Hardwire Driver IP65	96W/9.6W	100-277V AC	24V DC	4A	Yes*

**Phase dimming compatible with most MLV, ELV, and TRIAC dimmers*

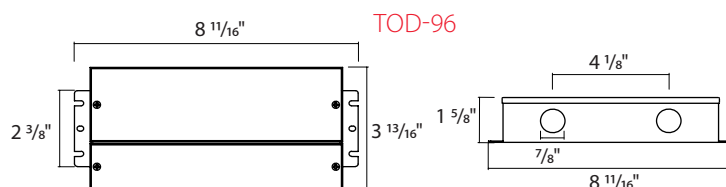
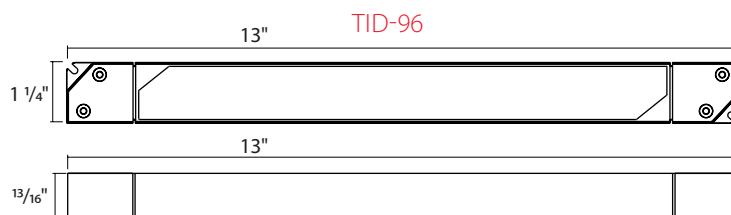
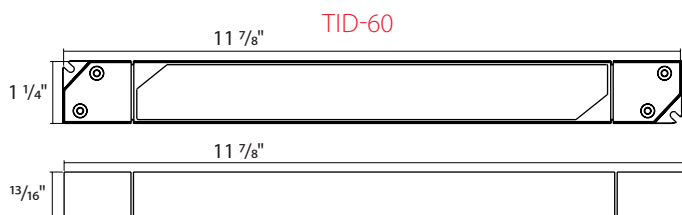

ARCTAPE COB Tape, Static White



TECHNICAL SPECIFICATIONS

CONSTRUCTION

Product Type

No-Pixel COB Tape Static White Damp Rated

Width

1/2 in

Length

32 ft 9 5/8"

Light Source

COB LED White

Material Construction

Super flexible bending, ultra thin appearance, premium wall structure & thick copper to ensure consistency in voltage and brightness

Light Effect

Continuous band light output with no pixelated hot spots

Packaging

Recyclable cardboard reel packaged in anti-static paper bag

INSTALLATION

Field Cuttable Increment

Cuttable every 2 in

Max Run Length

32 ft 9 5/8"

Mounting

Easy installation to most surfaces by using pre-attached 3M® double-sided tape

ELECTRICAL

Dimmable

PWM Dimming Signal, dimmable down to 1% with LED Driver (*sold separately*)

Input Voltage

24V DC

Input Current

6 mA per Chip at 120V

Operating Temperature

-4° to 113°F (-20° to 45°C)

Storage Temperature

-4° to 140°F (-20° to 60°C)

Flicker

Flicker Free – Pst LM<1, SVM<0.4, Percent Flicker≤5%@≤200Hz

LED CHARACTERISTICS

Chip Density

128 chips/ft

Beam Angle

150°

Color Temperature

2700K, 3000K, 4000K, or Dim-to-warm (1800-3000K)

Color Accuracy (CRI)

90

R9 Value

High color performance with R9 greater than 50

Color Consistency

3 step in 1 bin

COMPLIANCE

Safety Listing

UL Listed

Environment

Suitable for use indoors in dry and damp environments.

IP Rating

IP20

California Title 24 JA8 Compliant

Can be used to conform with the requirements of California Title 24 Part 6.

California Energy Commission (CEC) Status

Lawful for Sales in California

NEC Compliant

Suitable for use in closets when used in an enclosed extrusion based on NFPA 70, NEC section 410.16 (A)(1) and 410.16 (C)(1)

IESNA LM-79 & LM80 Testing

RAB LED luminaires and LED components have been tested by an independent laboratory in accordance with IESNA LM-79 and LM-80.

RoHS

Mercury and UV free. RoHS-compliant components.

FCC

Complies with Part 15 of the FCC Rules

WARRANTY

The RAB 5-year, limited warranty covers light output, driver performance and paint finish. RAB's warranty is subject to all terms and conditions found at rablighting.com/warranty.

DIMENSIONS

TICYY, TICY, TICN

Weight .453 lbs

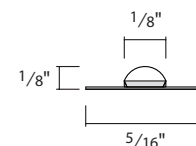
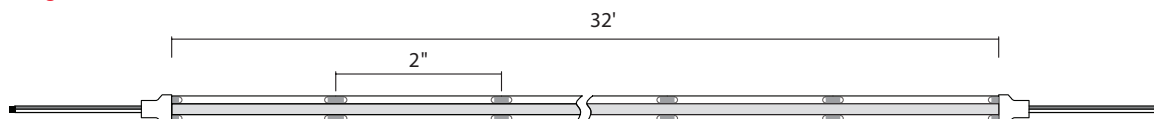

TICY/DW

Weight .453 lbs

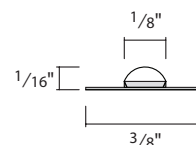
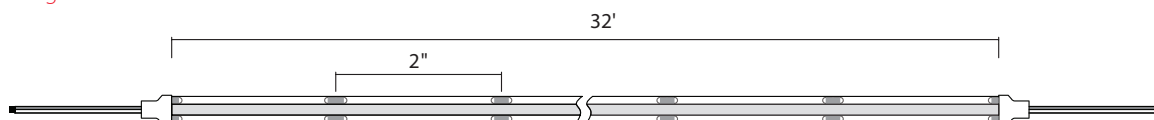

ORDERING INFO		
Catalog Number	UPC	Case Pack
TICYY	192552046688	20
TICY	192552046695	20
TICN	192552046701	20
TIC/DW	192552046718	20

DIMMER COMPATIBILITY LIST			
Dimmer Brand	Part Number	Dimmer Brand	Part Number
LUTRON	TGCL-153P	LUTRON	DVLV-600P
	MSCL-OP153M		DVCL-153P
	STCL-153M		CTCL-153P
	MACL-153M		DV-600P
	SCL-153P		CTCL-150
	DVRF-6L	LEVITON	IPLO6
	RCL-153PNL		DSLO6

Visit www.rablighting.com for periodic updates to this list or contact us at 888-722-1000 for questions or comments.

ORDERING MATRIX									
Family	Color Temperature		Option	CRI	Input Voltage		IP Rating	Length	
TIC									
N	4000K	Blank	No option	Blank	90CRI	Blank	24V DC	Blank	IP20
Y	3000K	/DW	Dim to Warm (1800-3000K)*						
YY	2700K								
Blank	Tunable*								

* Dim-to-warm option only available on tunable white model.
DW is for Indoor (COB usage) - Dim to 1800K