

NEOFLEX Dual Bendable Neon Flex, Static White

RAB



TNF— 24V DC, Outdoor-Rated Neon Flex, Horizontal & Vertical Bendable, Static White



24DC  
VOLTAGE



MAX RUN



FIELD  
CUTTABLE



DIMMABLE



IP  
RATING



90 CRI



50,000  
HRS



WET  
RATED

PROJECT:

DATE:

TYPE:

PREPARED BY:



5  
YEAR  
LIMITED  
WARRANTY



UL  
CERTIFIED



CAN BE USED TO COMPLY WITH  
2022  
TITLE 24  
PART 6  
HIGH EFFICIENCY LED LIGHT  
SOURCE REQUIREMENTS



RoHS



FCC  
COMPLIANT



NEC  
COMPLIANT

KEY FEATURES

- **Non-pixelated light diffusion**, enables the product to be freely bent in any direction, vertically and horizontally
- **Field-cuttable** for shorter runs with a max run of 16 ft 4 13/16". Can be linked with connectors (*sold separately*)
- **Easy installation** with clips, fixed channel, and bendable channel
- Slim silicone construction that can be freely cut at any increment
- 60W & 96W indoor or outdoor rated drivers available (*sold separately*)
- **50,000-hr rated life**, Title 24 Compliant, and 5-year limited warranty

PERFORMANCE

Catalog Number	Input Voltage	Color Temperature	Length	Input Wattage	Lumens	Efficacy	IP Rating	CRI	Cutting	Max Run
TNFY	24DC	3000K	16 ft 4 13/16" 5m	4.27 W/ft	213 lm/ft	50 lm/W	IP67	90	Any length	16 ft 4 13/16"

ACCESSORIES



Catalog Number	Description	Packaging includes
TPF2NF	Tape Light Silicone End Caps Kit	1 2-pin hard wiring, 11.81" 1 tail fed + 1 side/button fed front cap 1 silicone endcap 1 glue

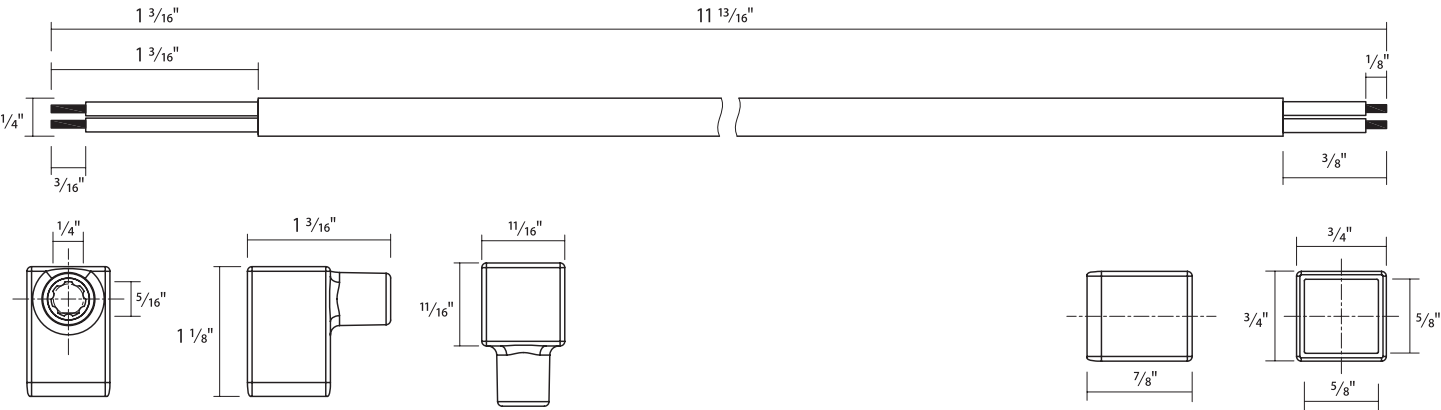
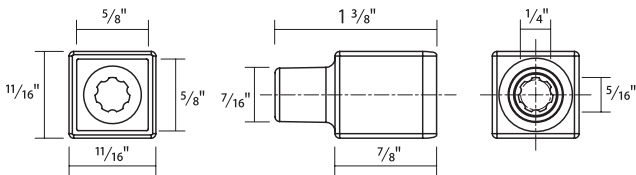

## ACCESSORIES (CONT.)



Catalog Number	Description	Packaging includes
<b>TB16</b>	Tape Light Brackets	10 Brackets and screws in package

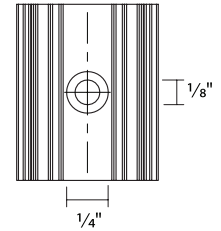
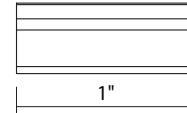
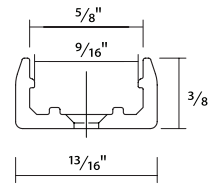

Catalog Number	Description	Packaging includes
<b>TAP16</b>	16mm Tape Light Aluminum Channel	Mounting screws

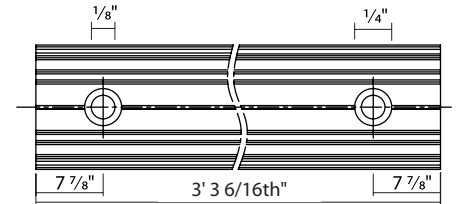
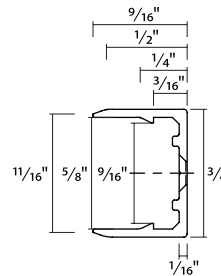

Catalog Number	Description	Packaging includes
<b>TBB16</b>	16mm Tape Light Bendable Channel	Mounting screws

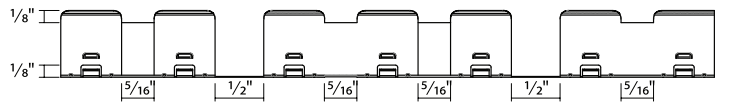
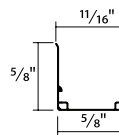
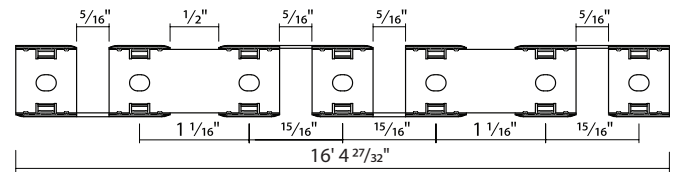

## DRIVERS



Catalog Number	Description	Max/Min Load	Input Voltage	Output Voltage	Rated Current	Dimmable
<b>TID-60</b>	60W Linear Driver	60W/6W	100-277V AC	24V DC	2.5A	Yes*
<b>TID-96</b>	96W Linear Driver	96W/9.6W	100-277V AC	24V DC	4A	Yes*
<b>TOD-96</b>	96W Outdoor constant voltage hardwire driver IP65	96W/9.6W	100-277V AC	24V DC	4A	Yes*

\*Phase dimming compatible with most MLV, ELV, and TRIAC dimmers

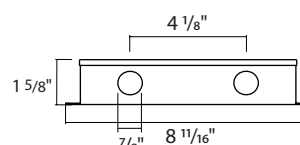
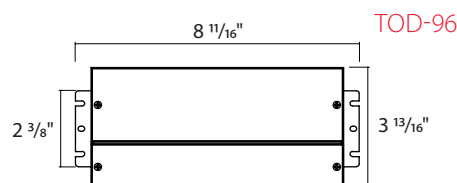
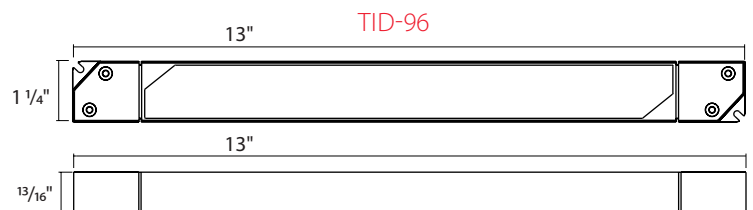
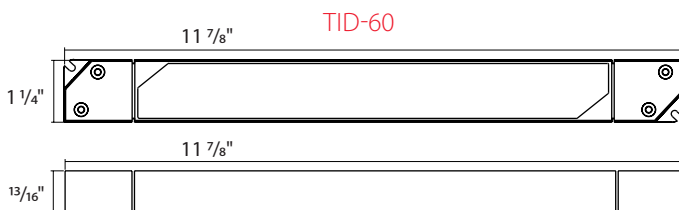

## TECHNICAL SPECIFICATIONS

### CONSTRUCTION

#### Product Type

Dual Flex Silicone Wet Rated Neon Tape Light Static White

#### Width

$\frac{3}{8}$ "

#### Length

16 ft 4  $\frac{13}{16}$ "

#### Light Source

SMD LED White

#### Material Construction

Dual-flex design which can be used to create curved and complex irregular designs

#### Light Effect

Soft linear lighting performance

#### Packaging

Recyclable cardboard reel packaged in anti-static paper bag

### INSTALLATION

#### Field Cuttable Increment

Can be cut at any length

#### Max Run Length

16 ft 4  $\frac{13}{16}$ "

#### Mounting

Easy installation with clips, fixed channel, and bendable channel (*sold separately*)

### ELECTRICAL

#### Dimmable

PPWM Dimming Signal, dimmable down to .1% with LED Driver (*sold separately*)

#### Input Voltage

24V DC

#### Input Current

5 mA/LED at 120V

#### Operating Temperature

-4° to 113°F (-20° to 45°C)

#### Storage Temperature

-4° to 140°F (-20° to 60°C)

#### Flicker

Flicker Free - Pst LM<1, SVM<0.4, Percent Flicker≤5%@≤200Hz

### LED CHARACTERISTICS

#### Chip Density

36 LED/ft

#### Beam Angle

120°

#### Color Temperature

3000K,

#### Color Accuracy (CRI)

90

#### R9 Value

High color performance with R9 greater than 50

#### Color Consistency

3 step in 1 bin

### COMPLIANCE

#### Safety Listing

UL Listed

#### Environment

Suitable for use indoors and outdoors in dry, damp, or wet environments.

#### IP Rating

IP67

#### California Title 24 JA8 Compliant

Can be used to conform with the requirements of California Title 24 Part 6.

#### California Energy Commission (CEC) Status

Lawful for Sales in California

#### NEC Compliant

Suitable for use in closets when used in an enclosed extrusion based on NFPA 70, NEC section 410.16 (A)(1) and 410.16 (C)(1)

#### IESNA LM-79 & LM80 Testing

RAB LED luminaires and LED components have been tested by an independent laboratory in accordance with IESNA LM-79 and LM-80.

#### RoHS

Mercury and UV free. RoHS-compliant components.

#### FCC

Complies with Part 15 of the FCC Rules

### WARRANTY

The RAB 5-year, limited warranty covers light output, driver performance and paint finish. RAB's warranty is subject to all terms and conditions found at [rablighting.com/warranty](http://rablighting.com/warranty).

## DIMENSIONS

### TN FY

Weight 2.64lbs

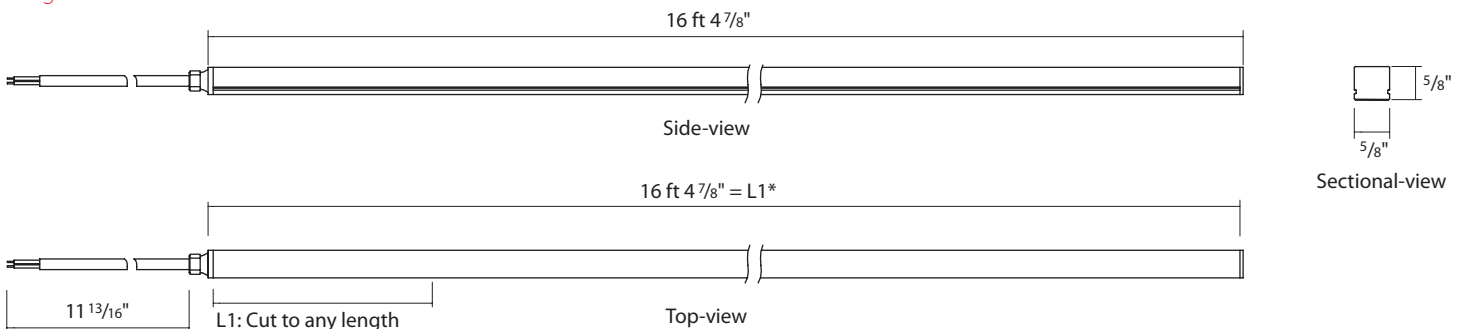

**RAB®**

## ORDERING INFO

Catalog Number	UPC	Case Pack
TNFY	192552046848	10

## DIMMER COMPATIBILITY LIST

Dimmer Brand	Part Number	Dimmer Brand	Part Number
LUTRON	TGCL-153P	LUTRON	DVLV-600P
	MSCL-OP153M		DVCL-153P
	STCL-153M		CTCL-153P
	MACL-153M		DV-600P
	SCL-153P		CTCL-150
	DVRF-6L		IPLO6
	RCL-153PNL	DSLO6	

Visit [www.rablighting.com](http://www.rablighting.com) for periodic updates to this list or contact us at 888-722-1000 for questions or comments.

## ORDERING MATRIX

Family	Color Temperature		CRI	Input Voltage		IP Rating	Length	
TNF	Y							
Y	3000K	Blank	90CRI	Blank	24V DC	Blank	IP67	Blank
								16 ft 4 <sup>13</sup> / <sub>16"</sub>