

INSTRUCTIONS

FIELD-ADJUSTABLE BOAE® INSTALLATION

RAB®

RAB Lighting is committed to creating high-quality, affordable, well-designed and energy-efficient LED lighting and controls that make it easy for electricians to install and end users to save energy. We'd love to hear your comments. Please call the Marketing Department at 888-RAB-1000 or email: marketing@rablighting.com

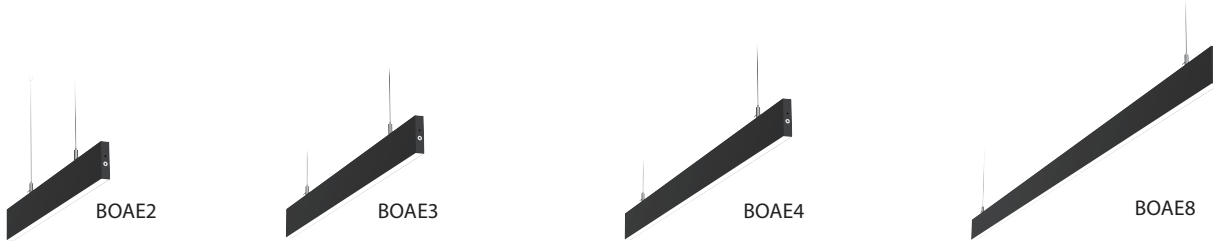

IMPORTANT

READ CAREFULLY BEFORE INSTALLING FIXTURE. RETAIN THESE INSTRUCTIONS FOR FUTURE REFERENCE.

RAB fixtures must be wired in accordance with the National Electrical Code and all applicable local codes. Proper grounding is required for safety. THIS PRODUCT MUST BE INSTALLED IN ACCORDANCE WITH THE APPLICABLE INSTALLATION CODE BY A PERSON FAMILIAR WITH THE CONSTRUCTION AND OPERATION OF THE PRODUCT AND THE HAZARDS INVOLVED.

WARNING: Make certain power is OFF before installing or maintaining fixture. No user serviceable parts inside.

Risk of fire. Risk of shock.

Suitable for damp location. Min 90° Supply Conductors. Indoor use only.

Single Luminaire ---Suspension Mount

1. Accessories for Power Feed End(Fig. 1).
2. Accessories for No Power Feed End(Fig. 2).
3. Use a screwdriver to open the cable entry cover(Fig. 3).
4. Use a screwdriver to knock out the knockout hole in the cable entry cover(Fig. 4).
5. Remove the male terminal wires from the lamp body and cut them(Fig. 5).
6. Connect the cut wires to the five-core input cable using wire nuts, matching the colors(Fig. 6).
7. Secure the cable clamp and tighten the screws(Fig. 7).
8. Pass the five-core input cable through the cable entry cover, close the cover, and tighten with screws(Fig. 8).
9. Use the locking device lock to the M6 screw on the lamp body and tighten(Fig. 9).
10. After tightening the locking device, press the cylindrical spring on the locking device to adjust the cable length(Fig. 10).
11. Secure the Cross Brace to the mounting hole of the junction box using 24-3/16 screws(Fig. 11).
12. Thread the five-core input cable through the Power canopy, then connect the cable to the mains power supply according to the corresponding wire color diagram(Fig. 12).
13. Use the Cable Coupler through the Power Canopy and secure it to the internal Cross Brace Stud(Fig. 13).
14. Secure the five-core input cable with a Cord Restraint and clamp it into the Canopy using a tool(Fig. 14).
15. Drill two ϕ 1/2" holes 1.5" apart on either side of the marked point. Pre-install the two Toggle bolts on Cross Brace(Fig. 15).
16. Fold the ends of the Toggle bolts together and thread them through the ϕ 1/2" mounting holes (following the dotted lines)(Fig. 16).
17. Tighten the screws on the Toggle Bolts, expanding the ends and securing them in the mounting holes(Fig. 17).
18. Use the Cable Coupler through the No-Power Canopy and secure it to the internal Cross Brace Stud(Fig. 18).
19. Installation is completed, remove protective film(Fig. 19).

Fig: 1

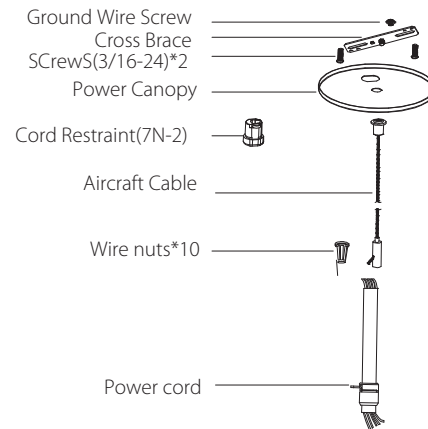

Fig: 2

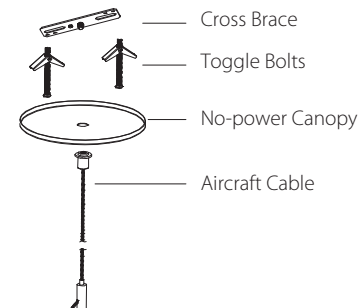

Fig: 3

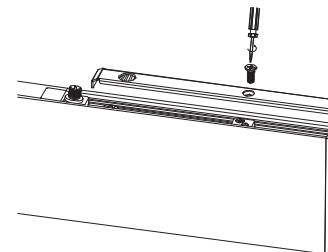

Fig: 4

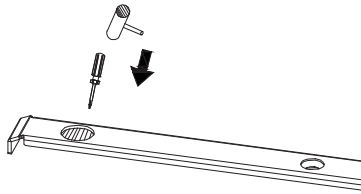

Fig: 8

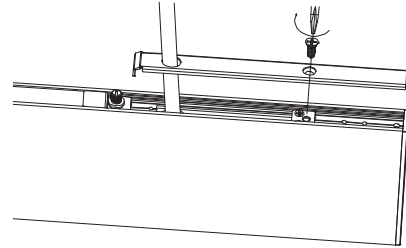

Fig: 5

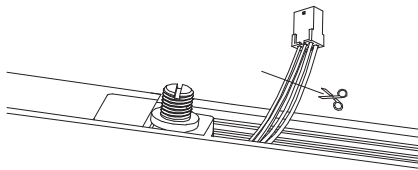

Fig: 9

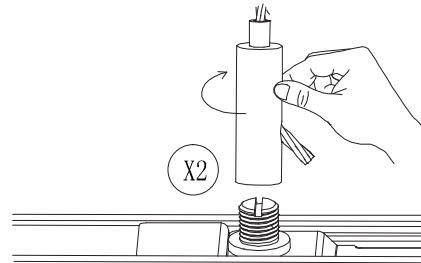

Fig: 6

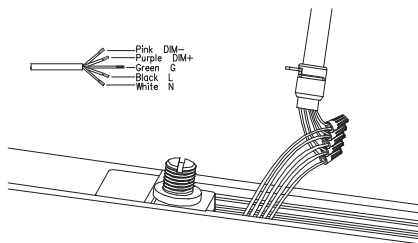

Fig: 10

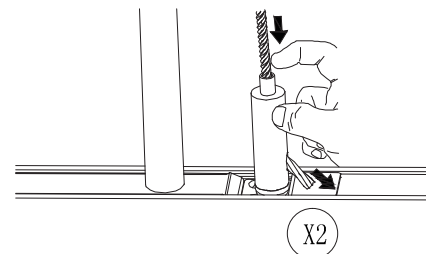

Fig: 7

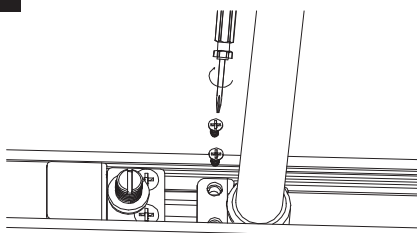

Fig: 11

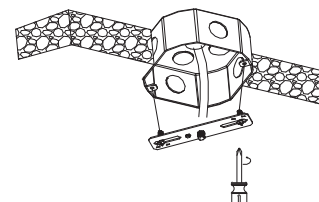

Fig: 12

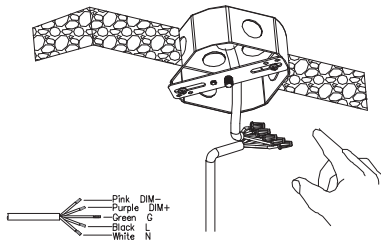

Fig: 16

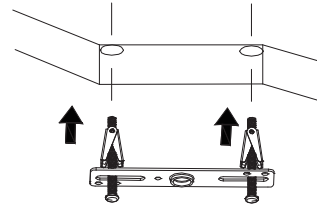

Fig: 13

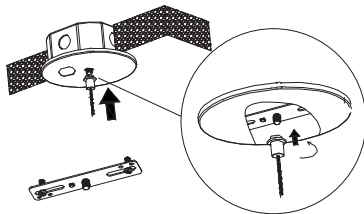

Fig: 17

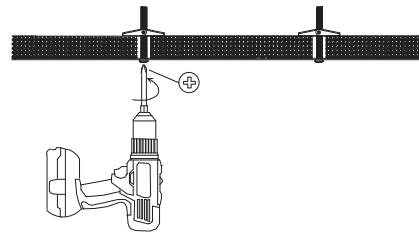

Fig: 14

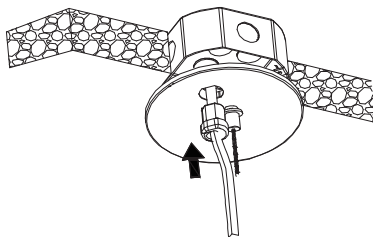

Fig: 18

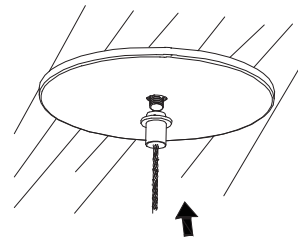

Fig: 15

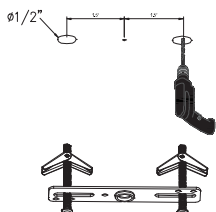
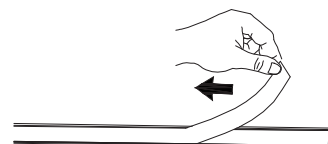



Fig: 19



Multiple Luminaire Splicing Installation

1. Use a screwdriver to open the cable entry cover(Fig. 2).
2. Use a screwdriver to knock out the knockout hole in the cable entry cover(Fig. 3).
3. Remove the end cap(Fig. 4).
4. Insert the splicing pins into the slots in the profile(Fig. 5).
5. After inserting the pins into the profile, use a hammer to hammer the knurled portion of the pins into the profile(Fig. 6).
6. Insert splicing bracket B into the slots in the profile(Fig. 7).
7. After inserting the splicing bracket into the profile, secure it with screws(Fig. 8).
8. Remove the cover plate of the other luminaire to be spliced(Fig. 9).
9. Insert splicing bracket A into the profile(Fig. 10).
10. After inserting splicing bracket A into the profile, secure it with screws(Fig. 11).
11. Connect the male and female splicing terminals of the two luminaires(Fig. 12).
12. Connect the input and output end of the luminaires(Fig. 13).
13. Drive the screws in, the screw's depth: when there is no gap between the two lamps, then it's ok(Fig. 14).
14. Install input and splicing cover plate(Fig. 15).
15. After the covers' plate are installed(Fig. 16).
16. Remove the protective film(Fig. 17).

Fig: 1

Splicing Bracket B 

Splicing Bracket A 

Splicing Pins*2 

Self-Tapping Screws PB3*5*6 

Fig: 2

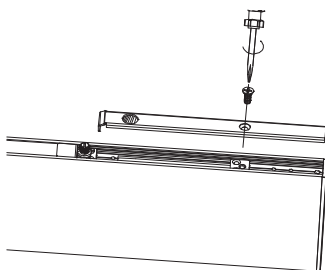

Fig: 3

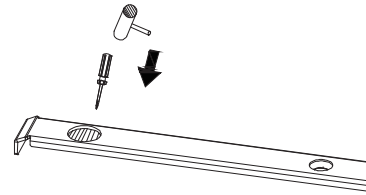

Fig: 4

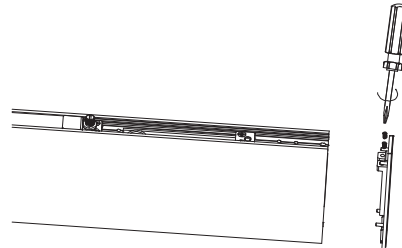

Fig: 5

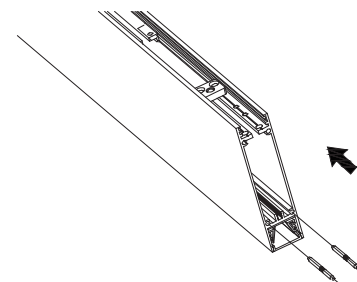

Fig: 6

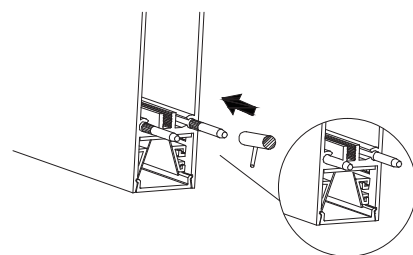

Fig: 7

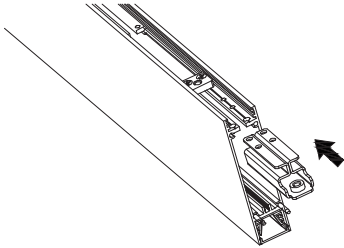

Fig: 11

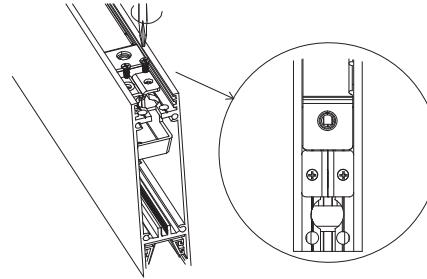

Fig: 8

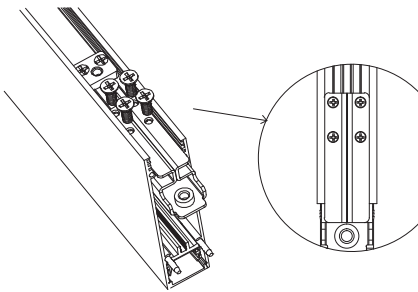

Fig: 12

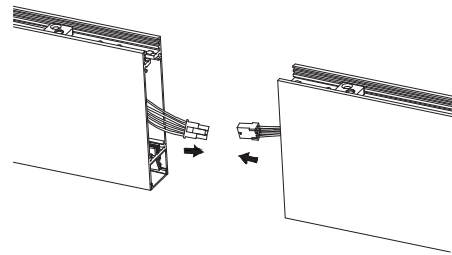

Fig: 9

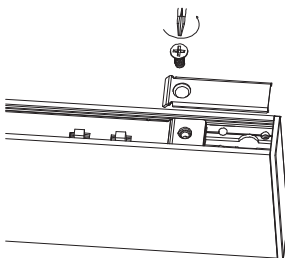

Fig: 13

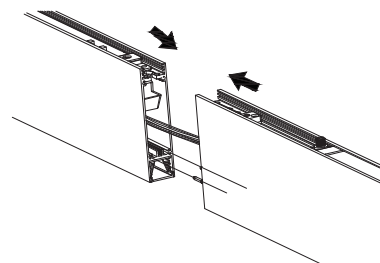

Fig: 10

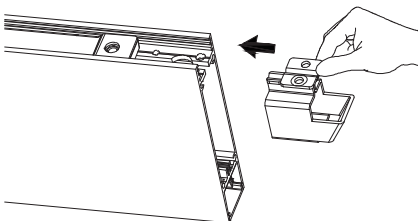

Fig: 14

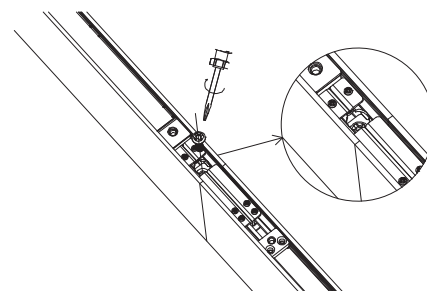

Fig: 15

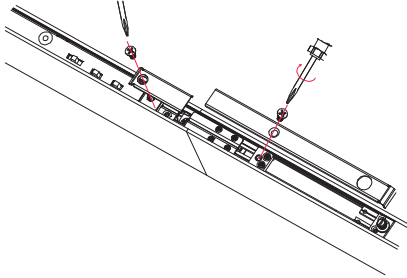

Fig: 16

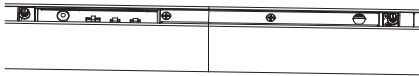
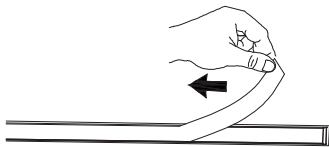

Fig: 17



Wall Mounted Installation

Ceiling/Wall Mount Kit sold separately, CAT# BOA-SM.

1. Based on the installation position requirements of the linear fixture, mark the locations of the four screw holes using the center point of the junction box as the reference(Fig. 2).
2. Drill two $\phi 1/2"$ holes in each side in the wall, the spacing is 17mm (Fig. 3).
3. Drive the expansion screws into the wall(Fig. 4).
4. Secure Wall Mount Brackets to the wall as shown in the picture (Fig. 5).
5. Use a screwdriver to open the cable entry cover(Fig. 6).
6. Drill a hole on the side of the fixture, the location and dimensions are shown in the drawing Warning: Do not drill into wires!(Fig. 7).
7. Remove the male terminal wires from the lamp body and cut them (Fig. 8).
8. Connect the wires to the five-core input cable using wire nuts, matching the color codes(Fig. 9).
9. Secure the cable entry cover and tighten with screws(Fig. 10).
10. Connect the 0.3m five-core input cable to the wiring in the junction box(Fig. 11).
11. Install the lamp into the wall mount bracket(Fig. 12).
12. Tighten the wall mount thumb nut to secure the lamp body(Fig. 13).
13. Remove the protective film(Fig. 14).

Fig: 1

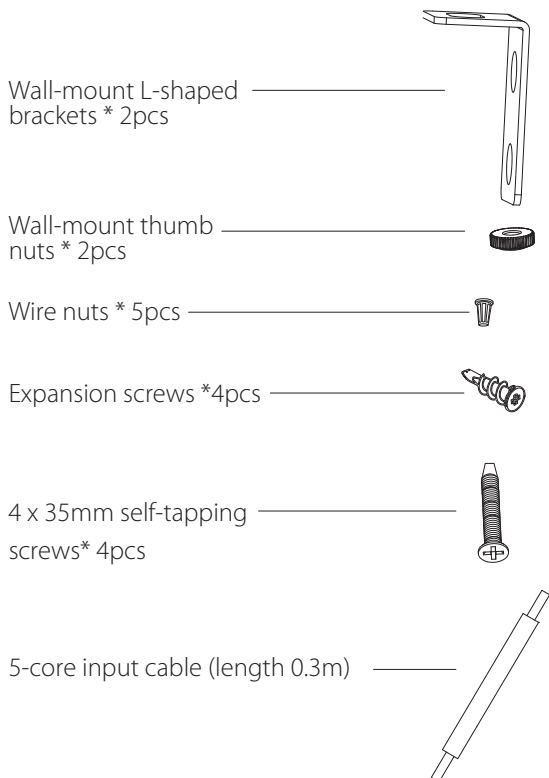

Fig: 2

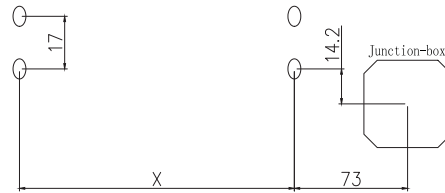

Fig: 3

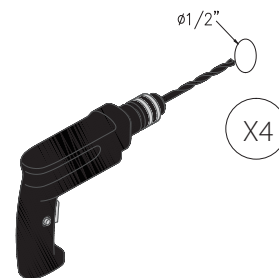

Fig: 4

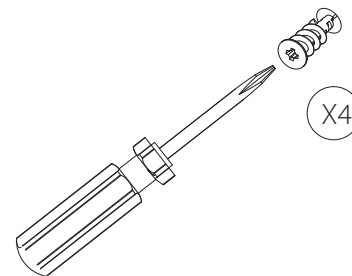

Fig: 5

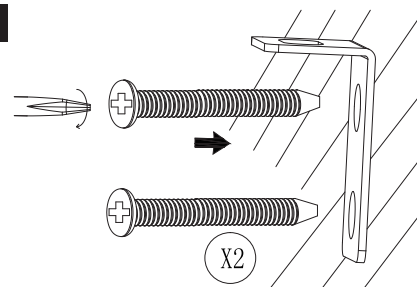

Fig: 6

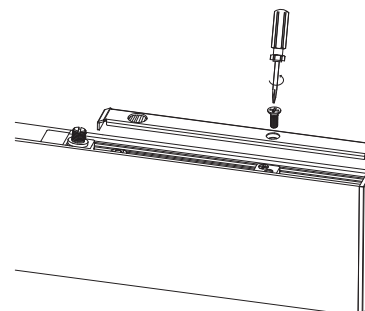

Fig: 7

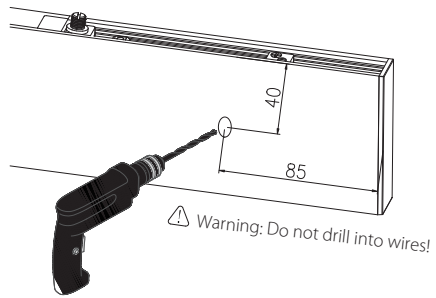

Fig: 11

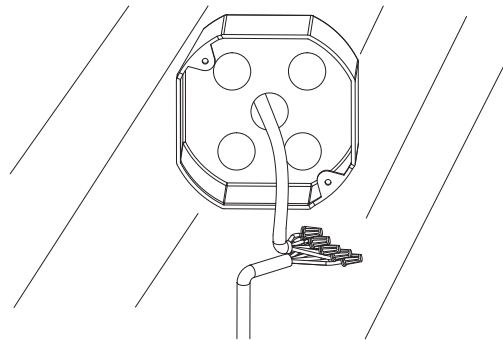

Fig: 8

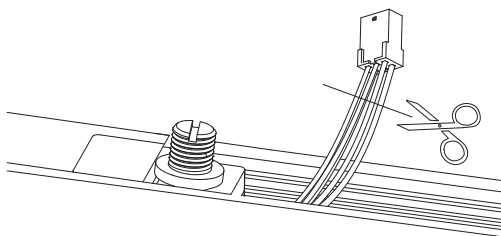

Fig: 12

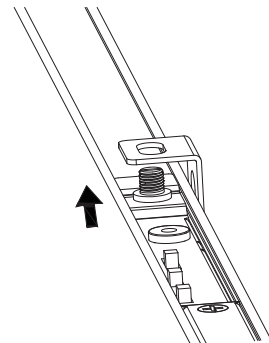

Fig: 9

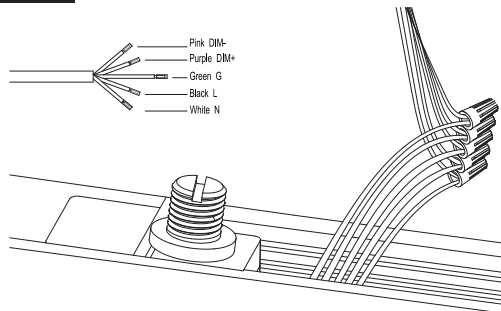

Fig: 13

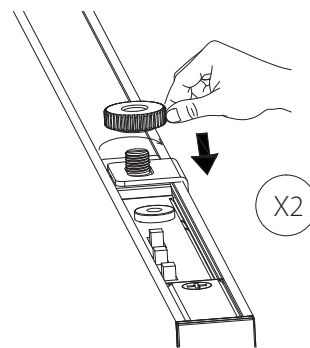

Fig: 10

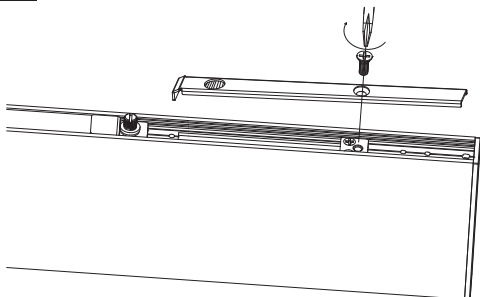
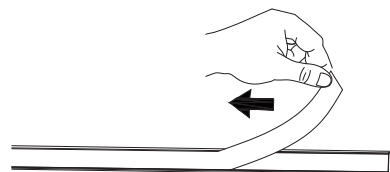

Fig: 14



Surface Mounted Installation

1. Drill a hole in the ceiling with a 12mm (1/2 inch) diameter(Fig. 2).
2. Drill another hole according to the corresponding specifications (Fig. 3).
3. Insert the toggle bolts into the hole and tighten the screw(Fig. 4).
4. Align the fixture clips(Fig. 5).
5. Remove the cable entry cover(Fig. 6).
6. Use pliers to cut the connecting wires and strip them(Fig. 7).
7. Connect the five-core input cable and the connecting wires with the wire nuts(Fig. 8).
8. Secure the five-core input cable with screw(Fig. 9).
9. Place the decorative plate onto the cable entry end of the profile and screw in(Fig. 10).
10. Connect the five-core input cable to the mains(Fig. 11).
11. Snap the light fixture onto the ceiling fixture clip and secure it (Fig. 12).
12. The Fixture's installation is completed(Fig. 13).

Fig: 1

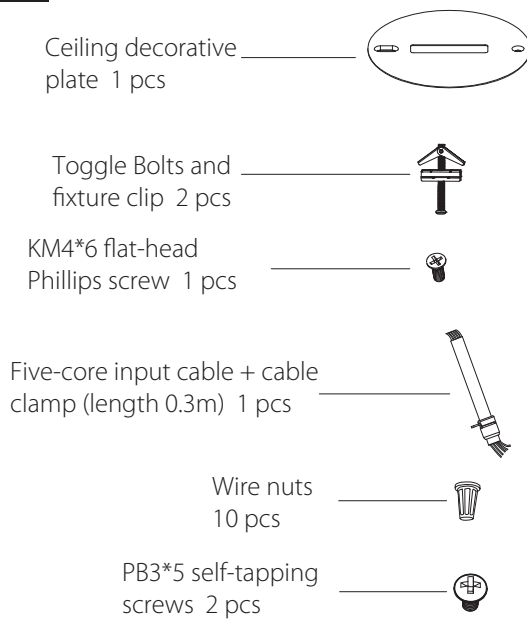

Fig: 2

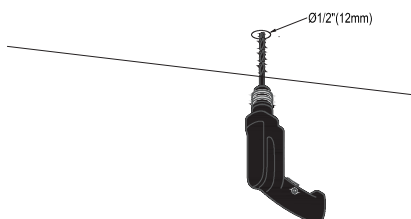

Fig: 3

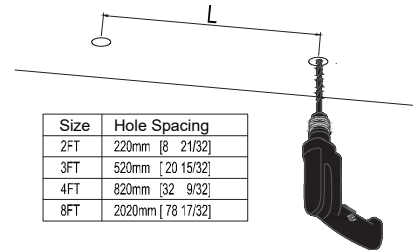

Fig: 4

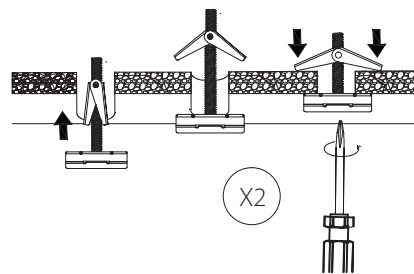

Fig: 5

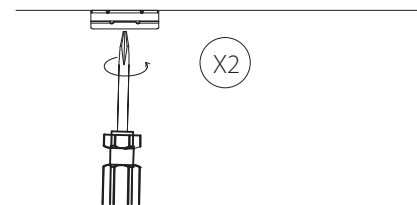

Fig: 6

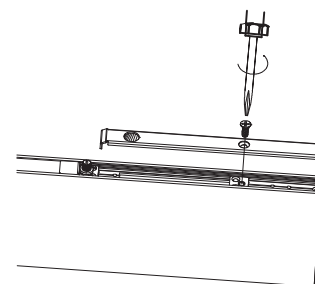

Fig: 7

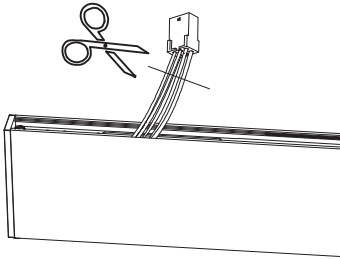

Fig: 11

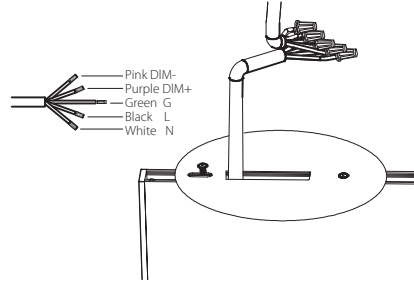

Fig: 8

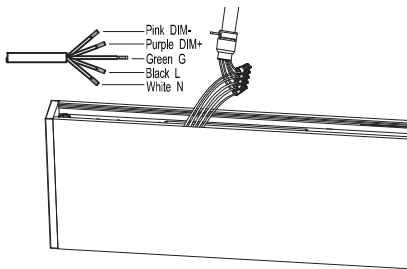

Fig: 12

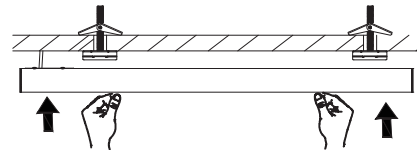

Fig: 9

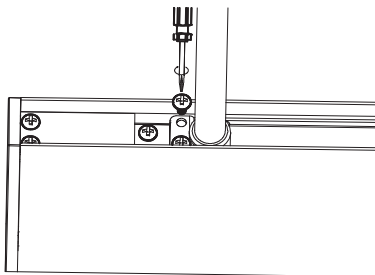

Fig: 13

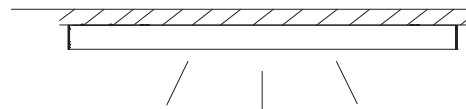
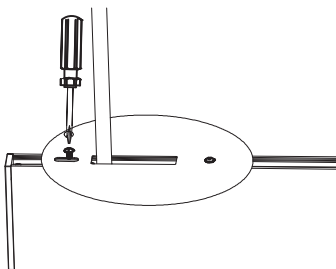

Fig: 10



Recessed Mounted Installation

1. Use a screwdriver to open the cable entry cover(Fig. 2).
2. Remove the male terminal wires from the lamp body and cut them (Fig. 3).
3. Connect the wires to the five-core input cable using wire nuts, matching the color codes(Fig. 4).
4. Secure the cable clamp and tighten the screws(Fig. 5).
5. Open the Recessed-mount junction box(Fig. 6).
6. Secure the lower junction box on the lamp's profile and tighten the screws(Fig. 7).
7. Insert the three Recessed brackets into the lamp body(Fig. 8).
8. Use 4x5 screws to secure the Recessed bracket to the recessed trimless flange profile, securing both sides with six screws(Fig. 9).
9. Secure top of the recessed bracket using two hand-tightened nuts (Fig. 10).
10. Use a screwdriver to pry open one of the knock-out holes in the junction box cover plate(Fig. 11).
11. Insert the metal sleeve into the junction box cover(Fig. 12).
12. Connect the wires in the metal sleeve to the five-core input cable using wire nuts(Fig. 13).
13. Insert the junction box cover into the hole and the cover plate is finished(Fig. 14).
14. Cutting a rectangular opening in the ceiling (1269 x 35mm).
15. Secure the recessed trimless flange profile to the ceiling using screws (8 screws total)(Fig. 15).
16. Secure the recessed trimless end cap to the ceiling using screws closely the lamp body(Fig. 16).
17. Use a brush to apply putty powder to the same finish as the wall, leaving only the illuminated portion of the lamp body on the ceiling.(Fig. 17).
18. Remove the protective film(Fig. 18).

Fig: 1

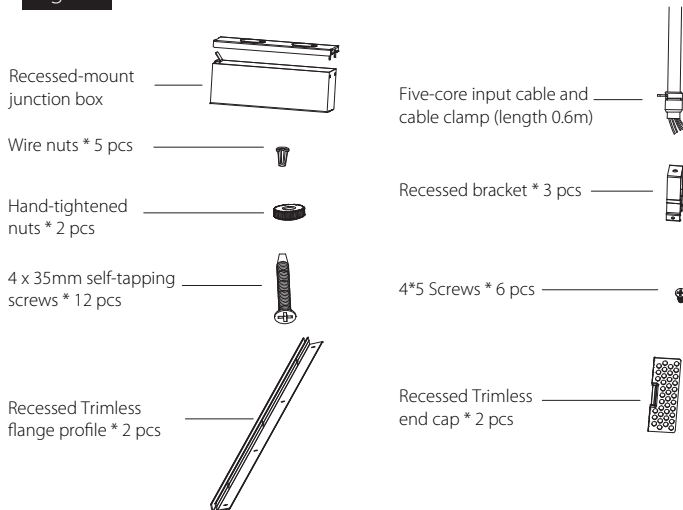

Fig: 2

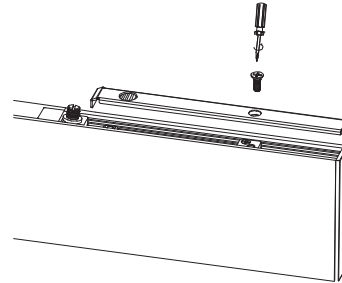

Fig: 3

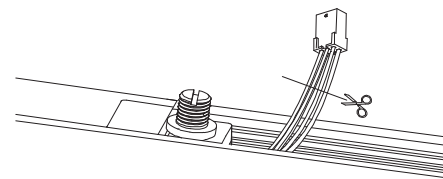

Fig: 4

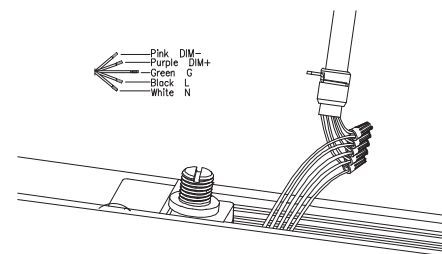

Fig: 5

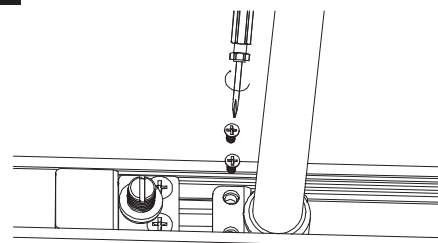

Fig: 6

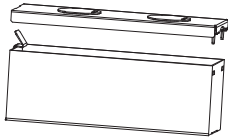

Fig: 10

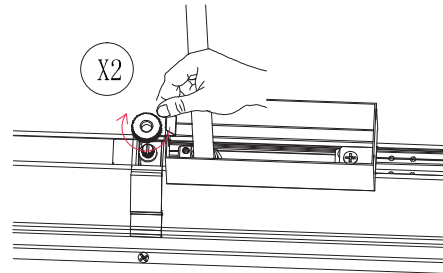

Fig: 7

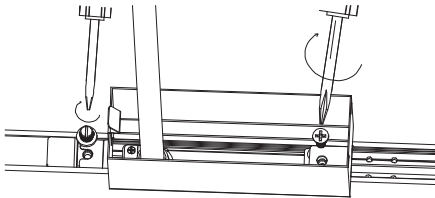

Fig: 11

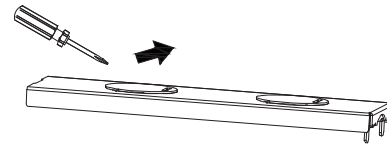

Fig: 8

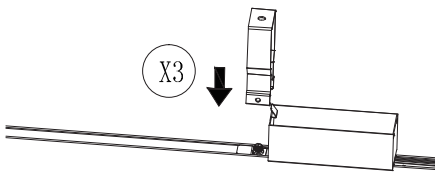

Fig: 12

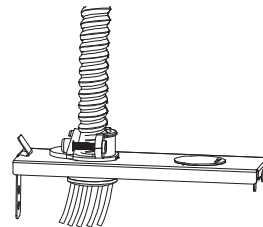

Fig: 9

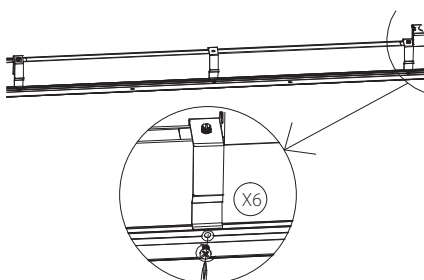

Fig: 13

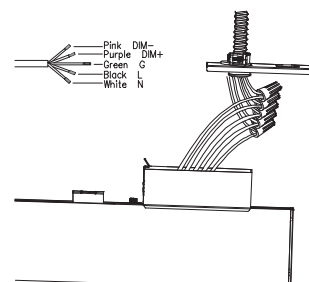

Fig: 14

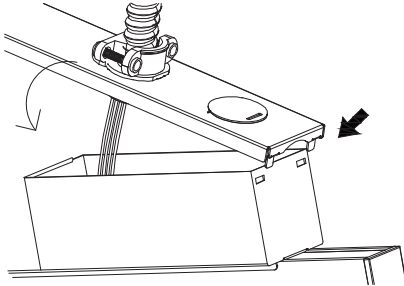

Fig: 17

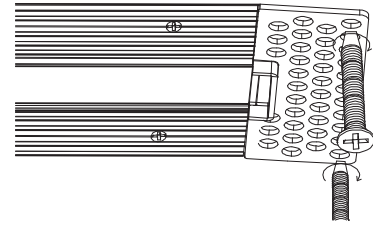

Fig: 15

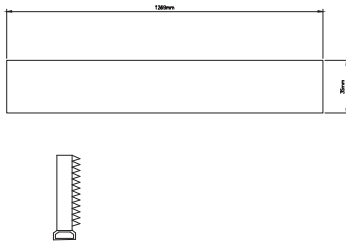

Fig: 18

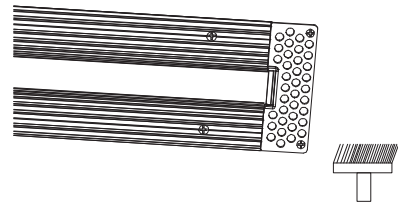

Fig: 16

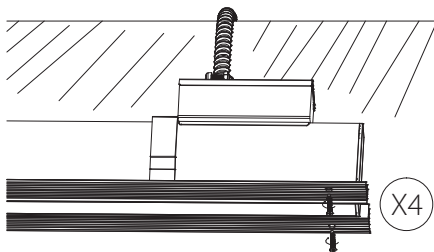

Fig: 19

