

INSTRUCTIONS

H22™ FIELD-ADJUSTABLE INSTALLATION



RAB Lighting is committed to creating high-quality, affordable, well-designed and energy-efficient LED lighting and controls that make it easy for electricians to install and end users to save energy. We'd love to hear your comments. Please call the Marketing Department at 888-RAB-1000 or email: marketing@rablighting.com



H22



H22XL

IMPORTANT

READ CAREFULLY BEFORE INSTALLING FIXTURE. RETAIN THESE INSTRUCTIONS FOR FUTURE REFERENCE.

RAB fixtures must be wired in accordance with the National Electrical Code and all applicable local codes. Proper grounding is required for safety. THIS PRODUCT MUST BE INSTALLED IN ACCORDANCE WITH THE APPLICABLE INSTALLATION CODE BY A PERSON FAMILIAR WITH THE CONSTRUCTION AND OPERATION OF THE PRODUCT AND THE HAZARDS INVOLVED.

WARNING: Make certain power is OFF before installing or maintaining fixture. No user serviceable parts inside.

Suitable for wet locations.

Maximum ambient temperature suitable for use in up to 50° C (122° F).

HOOK MOUNTING

1. Screw the **Hanging Ring** into the Fixture.
2. After installation (Fig. 2), connect wires as shown in the wiring diagram (Fig. 10 & 11). Use appropriate UL approved wire connectors as required by code to complete wiring with supply wires. Be careful not to pinch wires. **WARNING: To prevent wiring damage or abrasion, do not expose wiring to sharp objects.**

Fig: 1

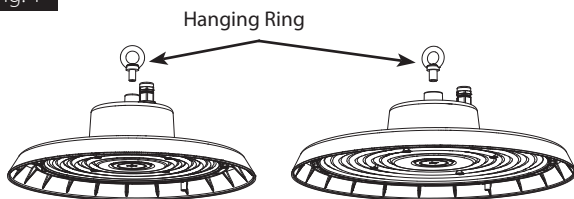
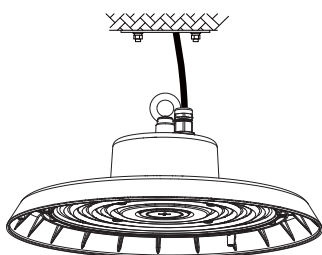

Fig: 2



FIELD ADJUSTMENT

Follow instructions to change **Beam Angle**, **Power (W)** and/or **Color Temperature (CCT)** from factory settings.

Factory Settings:

H22	150W / 4000K / 90°
H22XL	240W / 4000K / 90°
H22/480	150W / 4000K / 90°
H22XL/480	240W / 4000K / 90°

1. Locate the **Selector Switches** for Field-Adjustment on **Housing** as shown in Fig. 3.
2. Remove **Waterproof Cover**.
3. Select **Beam Angle**, **Power (W)** and/or **Color Temperature (CCT)** by sliding the respective switch to the desired setting.
4. Re-install **Waterproof Cover**.

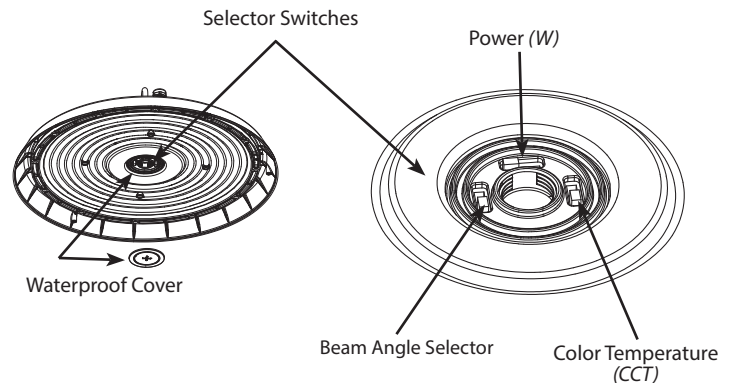

INSTRUCTIONS

H22™ FIELD-ADJUSTABLE INSTALLATION



RAB Lighting is committed to creating high-quality, affordable, well-designed and energy-efficient LED lighting and controls that make it easy for electricians to install and end users to save energy. We'd love to hear your comments. Please call the Marketing Department at 888-RAB-1000 or email: marketing@rablighting.com

PENDANT MOUNTING

Pendant Mounting Kit sold separately, Model # H22 PM KIT.

1. Secure the **Pendant Mounting Bracket** to the top of the fixture and tighten with **Bolt** as shown in Fig. 4 & 5.
2. After the **Pendant Mounting Bracket** is secured, thread the **Power Cord** through the top of the **Pendant Adapter Box**, lower the **Pendant Adapter Box** onto the **Mounting Bracket** and align for the **Fastening Screws**. Install **Fastening Screws** and **Silicone Plugs** (Fig. 6 & 7).
3. Thread 3/4" **Pendant Stem** (by others) into the **Pendant Adapter Box** as shown in Fig. 8. Use thread sealer to prevent water entry.

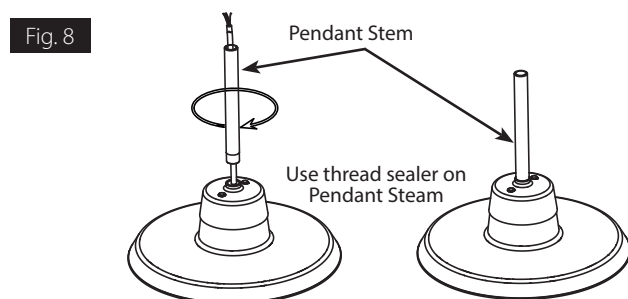
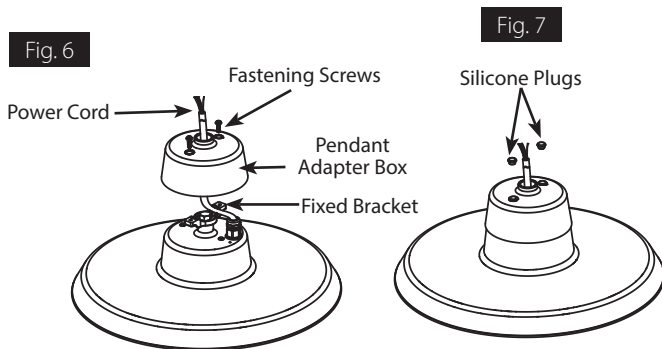
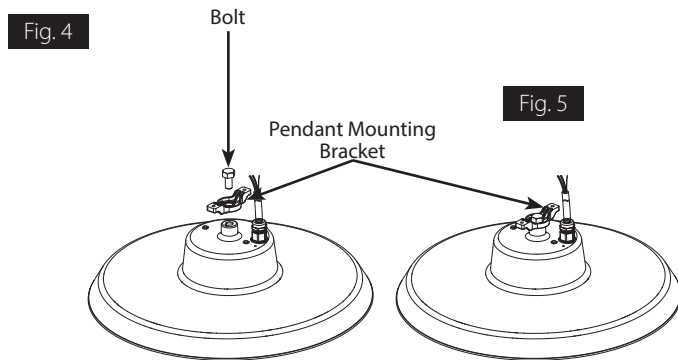

MOTION SENSOR INSTALLATION

(ORDERED SEPARATELY)

1. Ensure power is off to the fixture to avoid risk of shock.
2. Be sure to remove Sensor pin protector before installing.
3. Remove **Waterproof Cover** and install the **Sensor** onto fixture (Fig. 9) as per Sensor instructions.

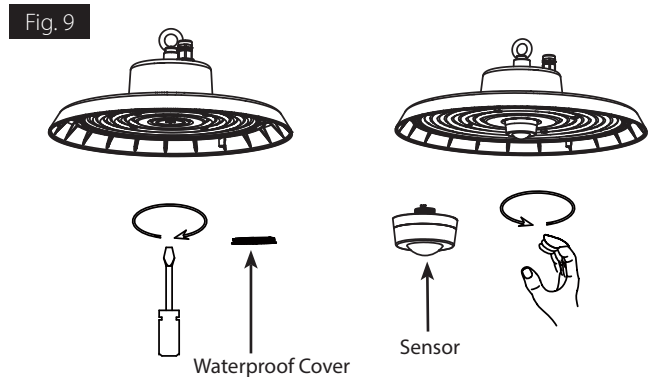

WIRING

RISK OF FIRE. Universal voltage driver permits operation at 120V through 277V, 50 or 60 Hz. Units ordered with /480 suffix are 480V ONLY, 50 or 60Hz. For 0-10V dimming follow wiring directions as shown in Fig. 10. For non-dimming (*on/off*), follow the wiring directions as shown in Fig. 11.

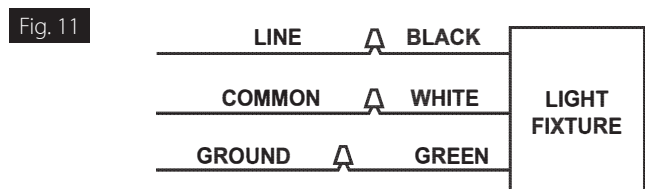
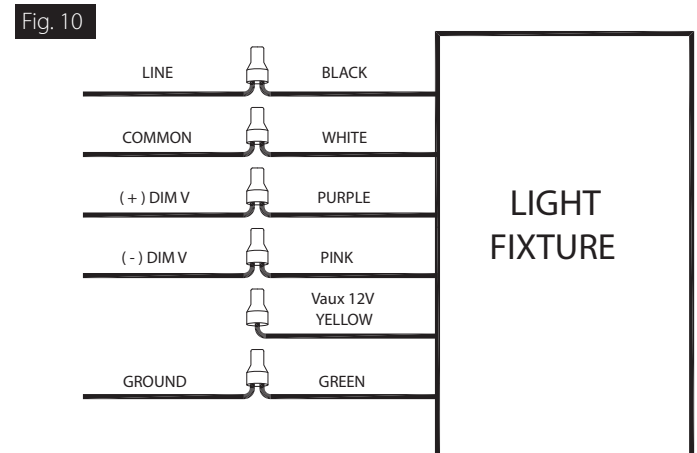

INSTRUCTIONS

H22™ FIELD-ADJUSTABLE INSTALLATION



RAB Lighting is committed to creating high-quality, affordable, well-designed and energy-efficient LED lighting and controls that make it easy for electricians to install and end users to save energy. We'd love to hear your comments. Please call the Marketing Department at 888-RAB-1000 or email: marketing@rablighting.com

CLEANING & MAINTENANCE

CAUTION: *Be sure fixture temperature is cool enough to touch. Do not clean or maintain while fixture is energized.*

1. Do not open fixture to clean the LED. Do not touch the LED.
2. Do not touch reflector or lens.
3. Do not clean any fixture surface with wood-base cleaning material such as paper towels or tissues.
4. Clean lens with non-abrasive cleaning solution.

TROUBLESHOOTING

1. Check that the line voltage at the fixture is correct. Refer to wiring directions.
2. Is the fixture grounded properly?

Note: *These instructions do not cover all details or variations in equipment nor do they provide for every possible situation during installation, operation or maintenance.*