

ISOFOOTCANDLE LINES OF HORIZONTAL ILLUMINATION

Values based on 12 foot mounting height.

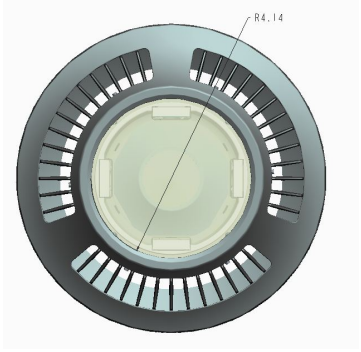

REPORT NUMBER: SCALED FROM RAB00862
 ISSUE DATE: 05/14/15 PAGE: 1 OF 9
 DATE SAMPLE TESTED: 05/11/15
 PREPARED FOR: RAB LIGHTING INC.
 CATALOG NUMBER: CLED52/D10 or
 PLED52/D10 (w/ center reflector &
 clear flat glass lens - ceiling or
 pendant mount)
 LUMINAIRE: CAST 2-PIECE BROWN PAINTED
 FINNED METAL HOUSING, 4 CAST METAL
 HEAT SINKS/CIRCUIT BOARD MOUNTING
 BRACKETS, 4 CIRCUIT BOARDS EACH WITH
 1 LED AND MOLDED PLASTIC CIRCUIT
 BOARD PERIMETER OVERLAY WITH SPECULAR
 FINISH, MOLDED PLASTIC REFLECTOR WITH
 SPECULAR FINISH AND 1 APERTURE PER
 LED, CLEAR FLAT GLASS LENS IN CAST
 BROWN PAINTED METAL FRAME.
 (SEE PAGE 2 FOR MORE INFORMATION)

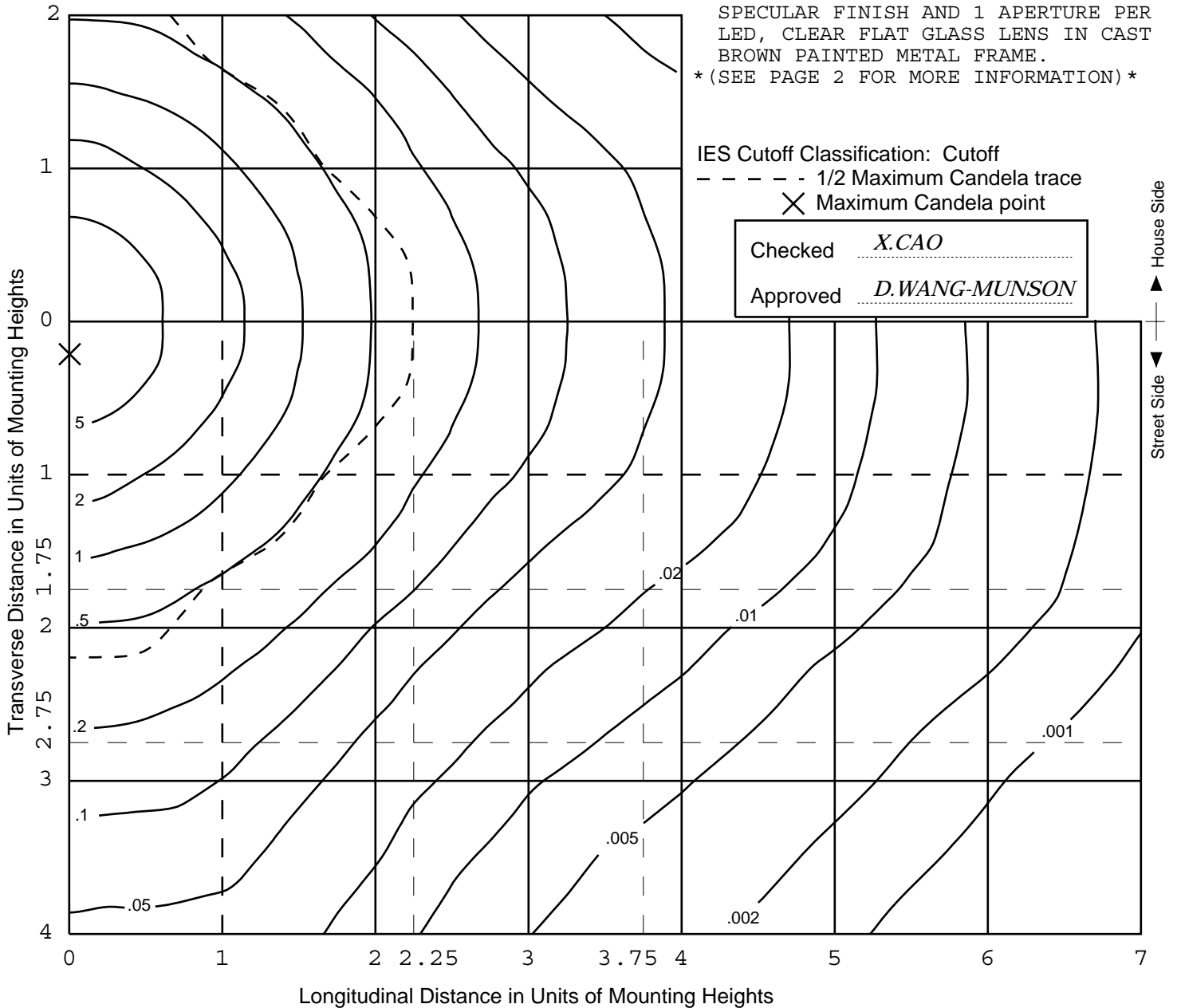

REPORT NUMBER: SCALED FROM RAB00862
ISSUE DATE: 05/14/15
PREPARED FOR: RAB LIGHTING INC.

PAGE: 2 OF 9
DATE SAMPLE TESTED: 05/11/15

ADDITIONAL INFORMATION

LAMPS: FOUR WHITE MULTI-CHIP LIGHT EMITTING DIODES (LEDS), AIMED AT THE HORIZON.

TOTAL INPUT WATTS = 58.3 AT 277.0 VOLTS

LED DRIVERS: TWO RAB RD-026-A0700-C

NOTE: DATA SHOWN IS ABSOLUTE FOR THE SAMPLE PROVIDED AT RATED INPUT VOLTAGE TO THE LED DRIVERS.

TEST PROCEDURE: IESNA LM-79-08

TEST DISTANCE = 28.25 FEET

MAXIMUM PLANE AND MAXIMUM CONE PLOTS OF CANDELA

REPORT NUMBER: SCALED FROM RAB00862
 ISSUE DATE: 05/14/15 PAGE: 3 OF 9
 DATE SAMPLE TESTED: 05/11/15
 PREPARED FOR: RAB LIGHTING INC.
 CATALOG NUMBER: CLED52/D10 or
 PLED52/D10 (w/ center reflector &
 clear flat glass lens - ceiling or
 pendent mount)
 LUMINAIRE: CAST 2-PIECE BROWN PAINTED
 FINNED METAL HOUSING, 4 CAST METAL
 HEAT SINKS/CIRCUIT BOARD MOUNTING
 BRACKETS, 4 CIRCUIT BOARDS EACH WITH
 1 LED AND MOLDED PLASTIC CIRCUIT
 BOARD PERIMETER OVERLAY WITH SPECULAR
 FINISH, MOLDED PLASTIC REFLECTOR WITH
 SPECULAR FINISH AND 1 APERTURE PER
 LED, CLEAR FLAT GLASS LENS IN CAST
 BROWN PAINTED METAL FRAME.
 (SEE PAGE 2 FOR MORE INFORMATION)

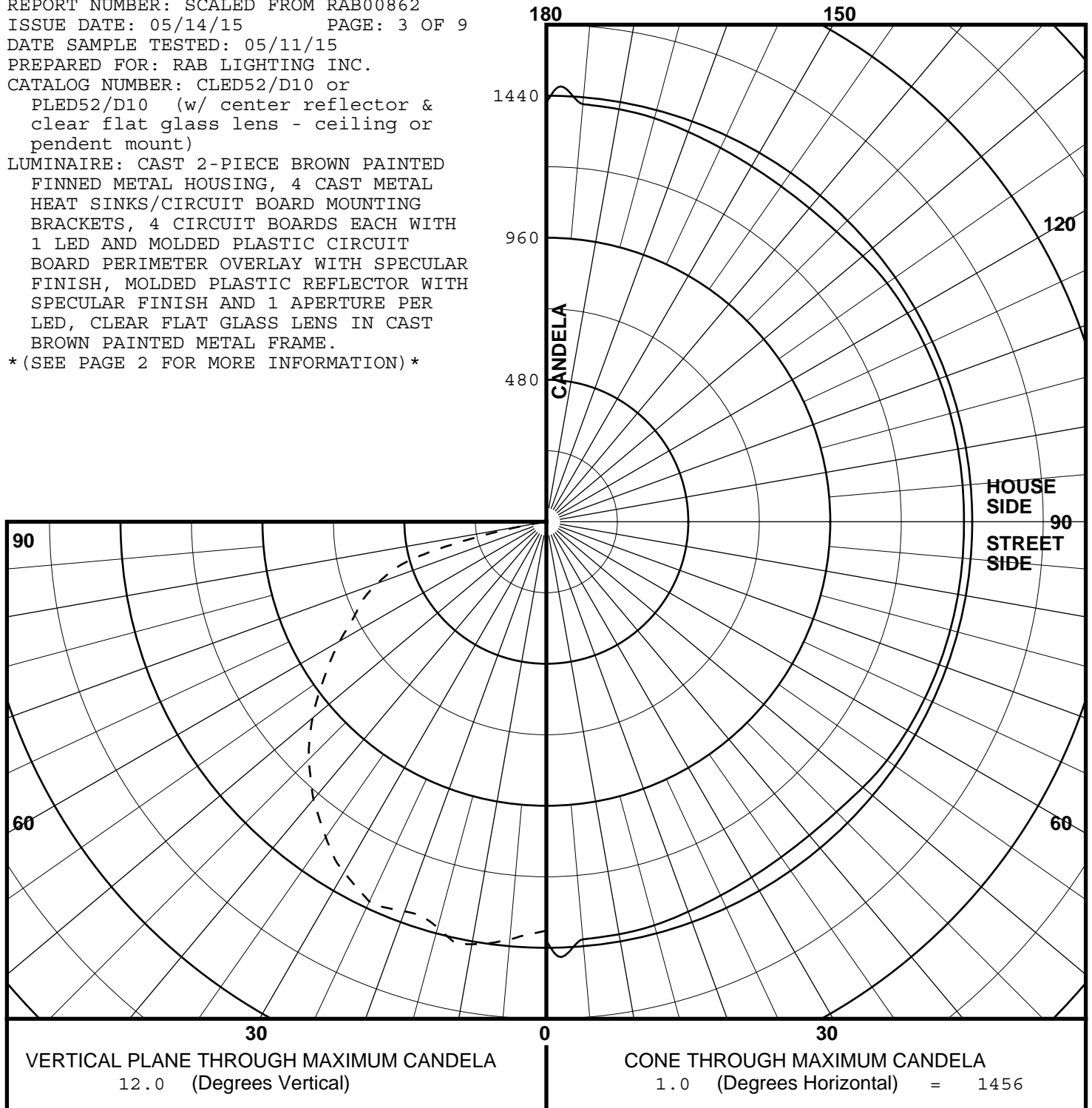

REPORT NUMBER: SCALED FROM RAB00862
 ISSUE DATE: 05/14/15
 PREPARED FOR: RAB LIGHTING INC.

PAGE: 4 OF 9
 DATE SAMPLE TESTED: 05/11/15

COEFFICIENTS OF UTILIZATION AND FLUX DISTRIBUTION

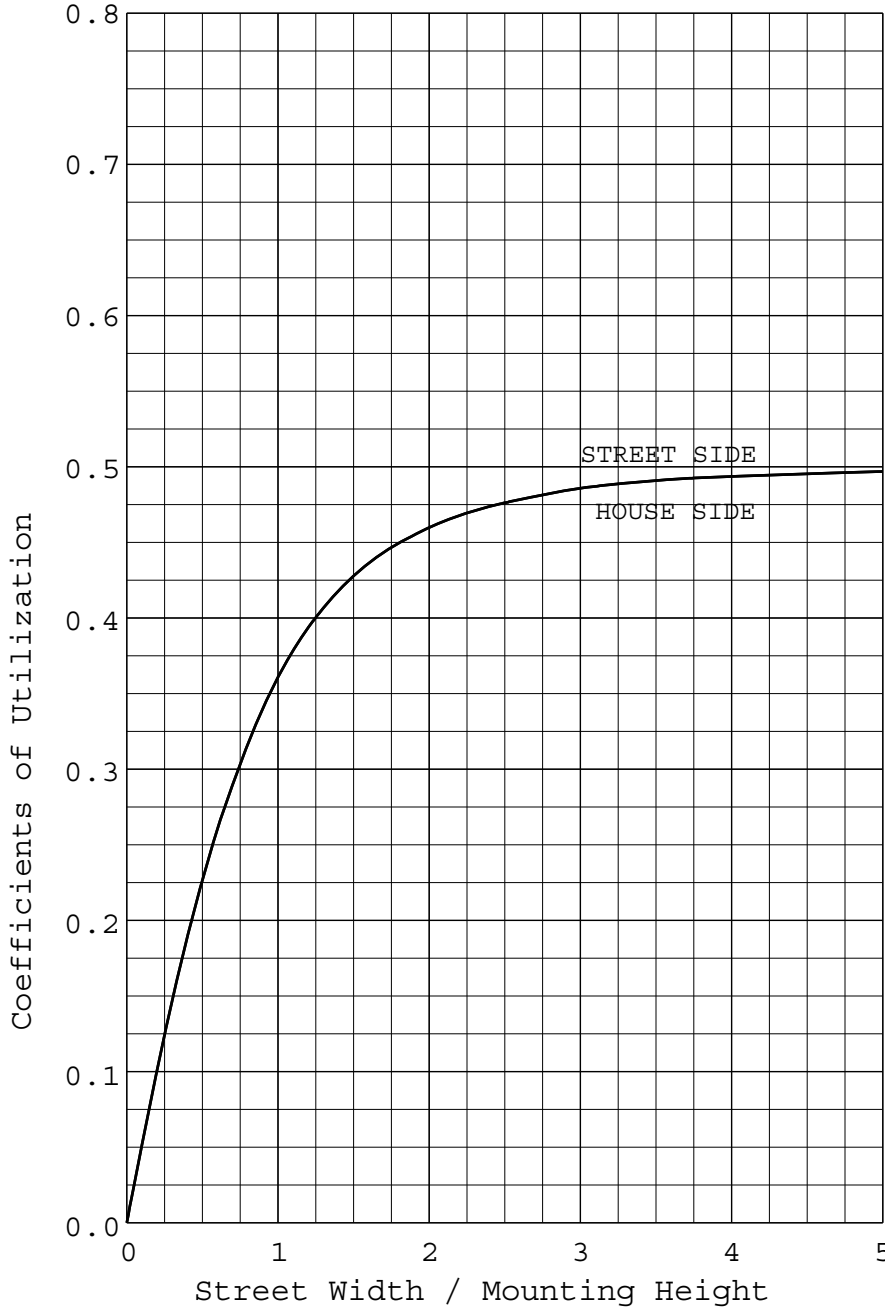

	LUMENS	PERCENT OF FIXTURE
DOWNWARD STREET SIDE	2255.	50.0
DOWNWARD HOUSE SIDE	2255.	50.0
DOWNWARD TOTAL	4510.	100.0
UPWARD STREET SIDE	1.	0.0
UPWARD HOUSE SIDE	1.	0.0
UPWARD TOTAL	1.	0.0
TOTAL FLUX	4512.	100.0
TOTAL INPUT WATTS = 58.3		
EFFICACY = 77.4 Lm/W		

ALL CANDELA AND LUMENS IN THIS REPORT ARE BASED ON ABSOLUTE PHOTOMETRY. THE COEFFICIENT OF UTILIZATION VALUES ARE BASED ON THE TOTAL ABSOLUTE LUMEN OUTPUT OF THIS LUMINAIRE SAMPLE.

REPORT NUMBER: SCALED FROM RAB00862
 ISSUE DATE: 05/14/15
 PREPARED FOR: RAB LIGHTING INC.

PAGE: 5 OF 9
 DATE SAMPLE TESTED: 05/11/15

BUG Rating:			B2	U1	G1
Zonal Summary		Lumens	% of Fixture		
			Zone Ratings		
			B	U	G
Forward		2255			
FL	(0° - 30°)	562.3			
FM	(30° - 60°)	1163.6			
FH	(60° - 80°)	515.9			G0
FVH	(80° - 90°)	13.4			G1
Backward		2255			
BL	(0° - 30°)	562.3	B2		
BM	(30° - 60°)	1163.6	B2		
BH	(60° - 80°)	515.9	B2		G0
BVH	(80° - 90°)	13.4			G1
Upward		1			
UL	(90° - 100°)	0.0		U0	
UH	(100° - 180°)	1.4		U1	
Trapped Light		0			
Total Flux		4512			

Zonal Lumen Summary

(Linear scale)

UH
1.4 Lm
0.0%

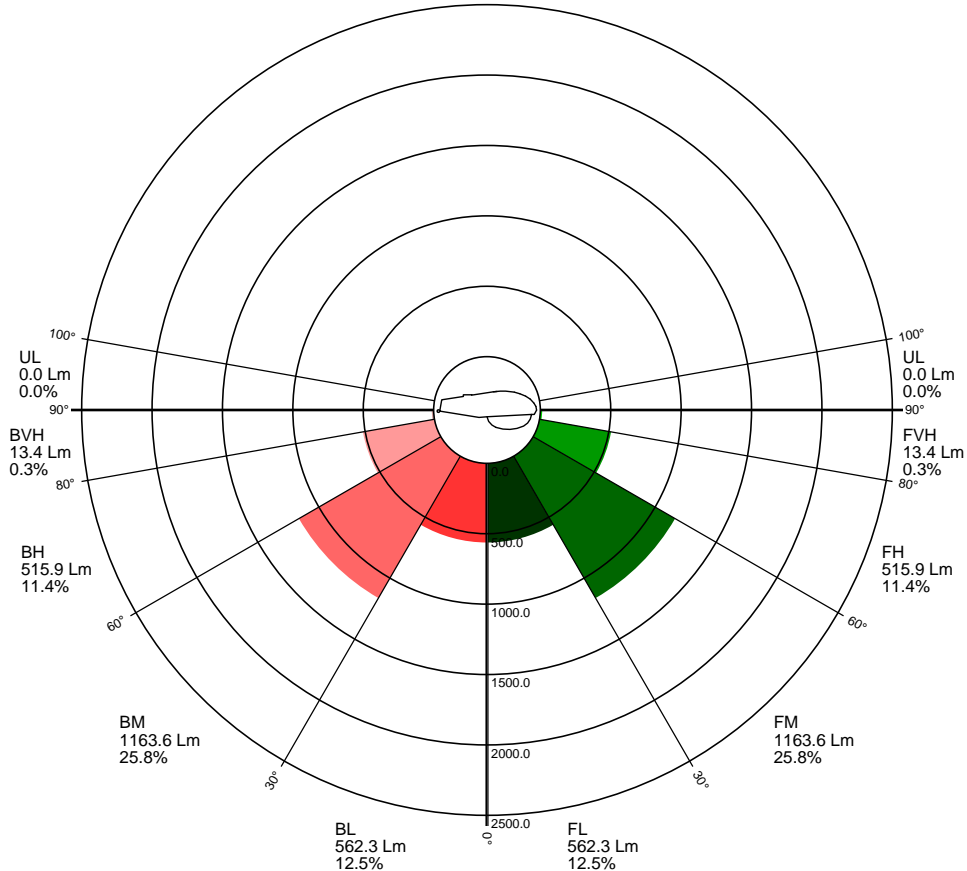

REPORT NUMBER: SCALED FROM RAB00862
 ISSUE DATE: 05/14/15
 PREPARED FOR: RAB LIGHTING INC.

PAGE: 6 OF 9
 DATE SAMPLE TESTED: 05/11/15

Backlight Rating Details

(Logarithmic scale)

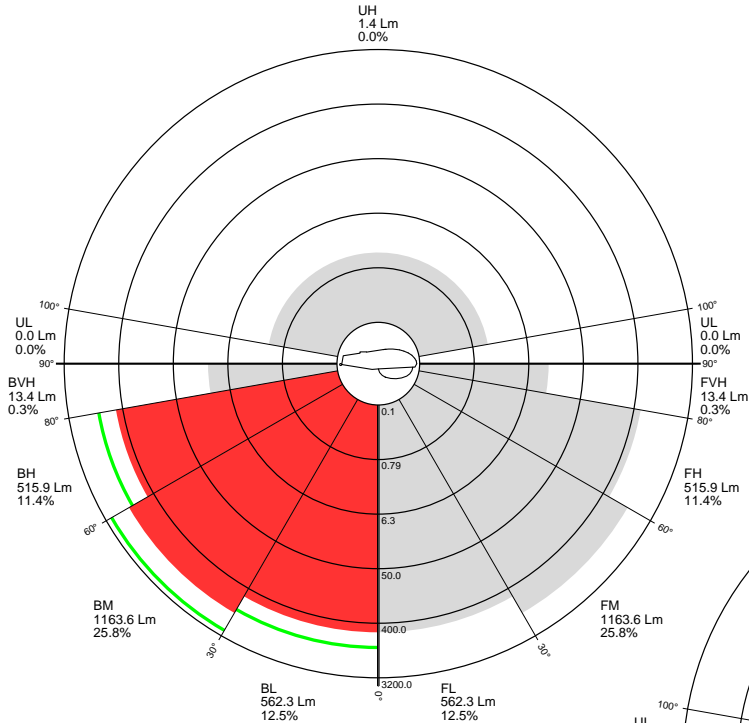

Uplight Rating Details

(Logarithmic scale)

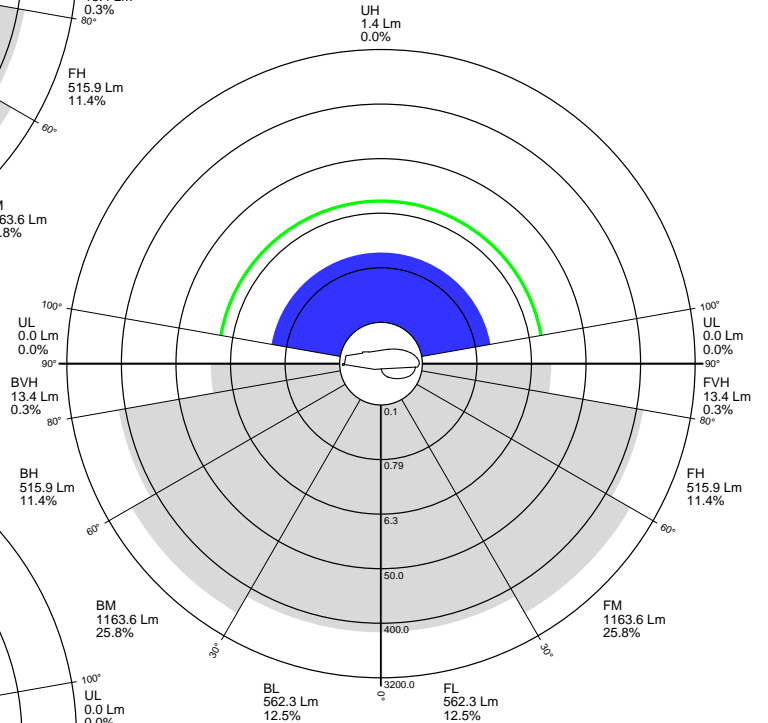

Glare Rating Details

(Logarithmic scale)

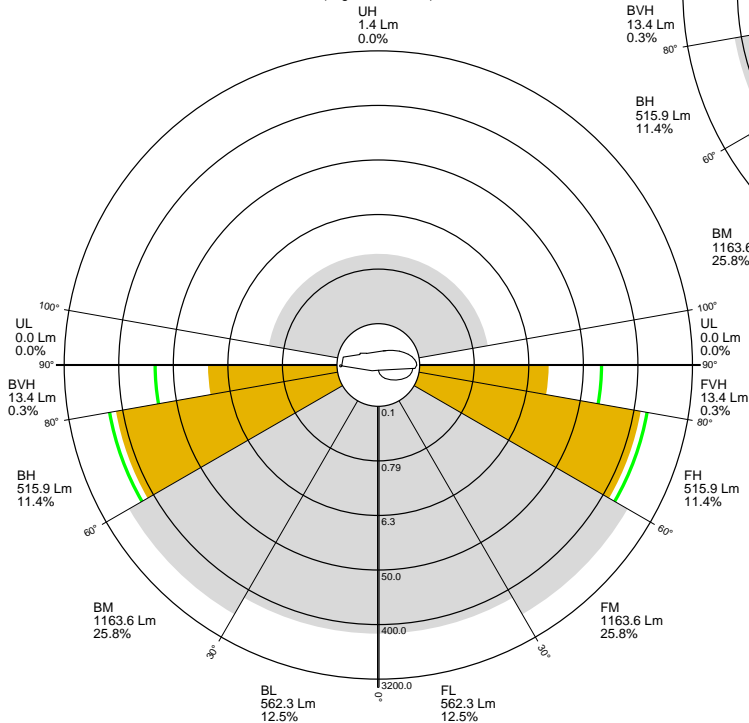



REPORT NUMBER: SCALED FROM RAB00862
 ISSUE DATE: 05/14/15
 PREPARED FOR: RAB LIGHTING INC.

PAGE: 7 OF 9
 DATE SAMPLE TESTED: 05/11/15

CANDELA TABULATION

	LATERAL ANGLE											
	STREET SIDE	0.0	1.0	5.0	15.0	25.0	35.0	45.0	55.0	65.0	75.0	85.0
	180.0	1.	1.	1.	1.	1.	1.	1.	1.	1.	1.	1.
	175.0	1.	1.	1.	1.	1.	1.	1.	1.	1.	1.	1.
	165.0	1.	1.	1.	1.	1.	1.	1.	1.	1.	1.	1.
	155.0	0.	1.	0.	1.	1.	1.	1.	1.	1.	1.	1.
	145.0	1.	1.	0.	1.	1.	1.	1.	1.	1.	1.	1.
	135.0	1.	1.	0.	1.	1.	1.	1.	1.	1.	1.	0.
	125.0	0.	0.	0.	0.	0.	0.	0.	0.	0.	0.	0.
	115.0	0.	0.	0.	0.	0.	0.	0.	0.	0.	0.	0.
	105.0	0.	1.	0.	0.	0.	0.	0.	0.	0.	0.	0.
	95.0	0.	0.	0.	0.	0.	0.	0.	0.	0.	0.	0.
	90.0	0.	0.	0.	0.	0.	0.	0.	0.	0.	0.	0.
	87.5	1.	0.	2.	2.	1.	1.	1.	1.	1.	2.	1.
	85.0	9.	2.	10.	11.	6.	5.	5.	4.	5.	9.	9.
	82.5	45.	13.	53.	54.	27.	23.	21.	19.	25.	47.	44.
V	80.0	160.	77.	166.	168.	95.	72.	65.	71.	92.	158.	170.
E	77.5	335.	246.	341.	340.	190.	125.	105.	135.	187.	312.	363.
R	75.0	478.	437.	478.	482.	314.	197.	180.	194.	280.	433.	495.
T	72.5	577.	544.	569.	567.	416.	324.	282.	300.	381.	525.	580.
I	70.0	640.	608.	638.	616.	519.	445.	396.	456.	494.	593.	652.
C	67.5	691.	664.	692.	675.	600.	542.	520.	584.	580.	667.	708.
A	65.0	737.	704.	739.	744.	676.	633.	666.	655.	685.	746.	747.
L	62.5	779.	748.	781.	802.	740.	723.	766.	725.	762.	807.	780.
	60.0	841.	807.	831.	842.	791.	800.	810.	791.	810.	853.	816.
A	57.5	889.	863.	882.	863.	833.	856.	834.	829.	843.	882.	855.
N	55.0	938.	917.	935.	891.	867.	892.	840.	850.	874.	915.	899.
G	52.5	988.	976.	989.	936.	899.	912.	862.	852.	893.	955.	937.
L	50.0	1043.	1032.	1044.	982.	930.	921.	890.	897.	936.	978.	967.
E	47.5	1100.	1087.	1095.	1032.	969.	942.	933.	950.	981.	1007.	1000.
	45.0	1147.	1137.	1137.	1083.	1015.	971.	983.	994.	1022.	1028.	1030.
	42.5	1177.	1179.	1172.	1130.	1059.	1010.	1033.	1040.	1060.	1048.	1053.
	40.0	1209.	1225.	1204.	1174.	1104.	1059.	1085.	1091.	1095.	1073.	1068.
	37.5	1235.	1262.	1235.	1212.	1151.	1114.	1136.	1140.	1128.	1104.	1086.
	35.0	1262.	1301.	1261.	1243.	1196.	1171.	1190.	1186.	1161.	1131.	1104.
	30.0	1301.	1368.	1303.	1291.	1275.	1263.	1281.	1266.	1229.	1182.	1149.
	25.0	1340.	1416.	1332.	1317.	1316.	1306.	1325.	1315.	1290.	1249.	1214.
	20.0	1348.	1402.	1352.	1364.	1355.	1335.	1346.	1341.	1330.	1329.	1323.
	15.0	1386.	1420.	1389.	1397.	1381.	1372.	1378.	1389.	1391.	1396.	1401.
	12.0<<	1417.	1456.	1417.	1412.	1395.	1384.	1388.	1406.	1412.	1414.	1413.
	10.0	1423.	1450.	1424.	1417.	1402.	1387.	1392.	1409.	1414.	1417.	1421.
	5.0	1403.	1417.	1403.	1400.	1395.	1388.	1398.	1408.	1411.	1413.	1416.
	0.0	1382.	1382.	1382.	1382.	1382.	1382.	1382.	1382.	1382.	1382.	1382.

PLANE OF MAXIMUM CANDELA

CONE OF MAXIMUM CANDELA



REPORT NUMBER: SCALED FROM RAB00862
 ISSUE DATE: 05/14/15
 PREPARED FOR: RAB LIGHTING INC.

PAGE: 8 OF 9
 DATE SAMPLE TESTED: 05/11/15

CANDELA TABULATION
 HOUSE SIDE

LATERAL ANGLE

	90.0	95.0	105.0	115.0	125.0	135.0	145.0	155.0	165.0	175.0	180.0
	180.0	1.	1.	1.	1.	1.	1.	1.	1.	1.	1.
	175.0	1.	1.	1.	1.	1.	1.	1.	1.	1.	1.
	165.0	1.	1.	1.	1.	1.	1.	1.	1.	1.	1.
	155.0	0.	1.	1.	1.	1.	1.	1.	1.	0.	0.
	145.0	0.	1.	1.	1.	1.	1.	1.	1.	0.	1.
	135.0	0.	0.	1.	1.	1.	1.	1.	1.	0.	1.
	125.0	0.	0.	0.	0.	0.	0.	0.	0.	0.	0.
	115.0	0.	0.	0.	0.	0.	0.	0.	0.	0.	0.
	105.0	0.	0.	0.	0.	0.	0.	0.	0.	0.	0.
	95.0	0.	0.	0.	0.	0.	0.	0.	0.	0.	0.
	90.0	0.	0.	0.	0.	0.	0.	0.	0.	0.	0.
	87.5	1.	1.	2.	1.	1.	1.	1.	2.	2.	1.
	85.0	7.	9.	9.	5.	4.	5.	5.	6.	11.	10.
	82.5	40.	44.	47.	25.	19.	21.	23.	27.	54.	53.
V	80.0	165.	170.	158.	92.	71.	65.	72.	95.	168.	166.
E	77.5	356.	363.	312.	187.	135.	105.	125.	190.	340.	341.
R	75.0	493.	495.	433.	280.	194.	180.	197.	314.	482.	478.
T	72.5	584.	580.	525.	381.	300.	282.	324.	416.	567.	569.
I	70.0	652.	652.	593.	494.	456.	396.	445.	519.	616.	638.
C	67.5	700.	708.	667.	580.	584.	520.	542.	600.	675.	692.
A	65.0	746.	747.	746.	685.	655.	666.	633.	676.	744.	739.
L	62.5	782.	780.	807.	762.	725.	766.	723.	740.	802.	781.
	60.0	820.	816.	853.	810.	791.	810.	800.	791.	842.	831.
A	57.5	853.	855.	882.	843.	829.	834.	856.	833.	863.	882.
N	55.0	892.	899.	915.	874.	850.	840.	892.	867.	891.	935.
G	52.5	936.	937.	955.	893.	852.	862.	912.	899.	936.	989.
L	50.0	963.	967.	978.	936.	897.	890.	921.	930.	982.	1044.
E	47.5	1002.	1000.	1007.	981.	950.	933.	942.	969.	1032.	1095.
	45.0	1034.	1030.	1028.	1022.	994.	983.	971.	1015.	1083.	1137.
	42.5	1054.	1053.	1048.	1060.	1040.	1033.	1010.	1059.	1130.	1172.
	40.0	1069.	1068.	1073.	1095.	1091.	1085.	1059.	1104.	1174.	1204.
	37.5	1085.	1086.	1104.	1128.	1140.	1136.	1114.	1151.	1212.	1235.
	35.0	1101.	1104.	1131.	1161.	1186.	1190.	1171.	1196.	1243.	1261.
	30.0	1142.	1149.	1182.	1229.	1266.	1281.	1263.	1275.	1291.	1303.
	25.0	1212.	1214.	1249.	1290.	1315.	1325.	1306.	1316.	1317.	1332.
	20.0	1319.	1323.	1329.	1330.	1341.	1346.	1335.	1355.	1364.	1352.
	15.0	1400.	1401.	1396.	1391.	1389.	1378.	1372.	1381.	1397.	1389.
	12.0<<	1412.	1413.	1414.	1412.	1406.	1388.	1384.	1395.	1412.	1417.
	10.0	1422.	1421.	1417.	1414.	1409.	1392.	1387.	1402.	1417.	1424.
	5.0	1413.	1416.	1413.	1411.	1408.	1398.	1388.	1395.	1400.	1403.
	0.0	1382.	1382.	1382.	1382.	1382.	1382.	1382.	1382.	1382.	1382.

CONE OF MAXIMUM CANDELA

REPORT NUMBER: SCALED FROM RAB00862
ISSUE DATE: 05/14/15
PREPARED FOR: RAB LIGHTING INC.

PAGE: 9 OF 9
DATE SAMPLE TESTED: 05/11/15

5-DEGREE
ZONAL LUMEN SUMMARY

0- 5	33
5- 10	101
10- 15	166
15- 20	225
20- 25	277
25- 30	322
30- 35	359
35- 40	382
40- 45	395
45- 50	400
50- 55	398
55- 60	393
60- 65	370
65- 70	312
70- 75	228
75- 80	122
80- 85	26
85- 90	1
90- 95	0
95-100	0
100-105	0
105-110	0
110-115	0
115-120	0
120-125	0
125-130	0
130-135	0
135-140	0
140-145	0
145-150	0
150-155	0
155-160	0
160-165	0
165-170	0
170-175	0
175-180	0

10-DEGREE
ZONAL LUMEN SUMMARY

0- 10	134
0- 20	525
0- 30	1125
0- 40	1865
0- 50	2660
0- 60	3452
0- 70	4133
0- 80	4484
0- 90	4510
0-100	4510
0-110	4510
0-120	4510
0-130	4510
0-140	4511
0-150	4511
0-160	4512
0-170	4512
0-180	4512