

RAB®

WFRX D2W + Nightlight

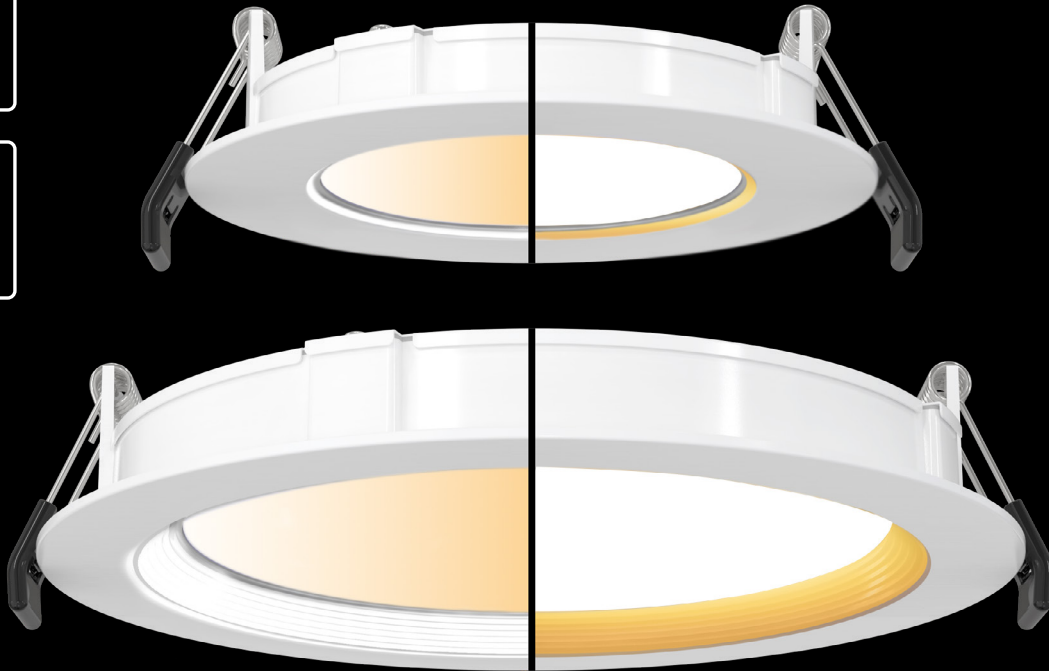
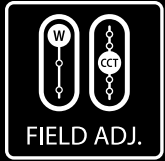

Two lights are better than one.

The dim-to-warm WFRX with nightlight.

Countless ways to customize.

The D2W WFRX gives you the best of both worlds in one sleek fixture. Select from five pre-set color temperatures, dial in the adjustable ambiance of dim-to-warm technology, or use the dedicated nightlight that provides subtle illumination when you need it most.

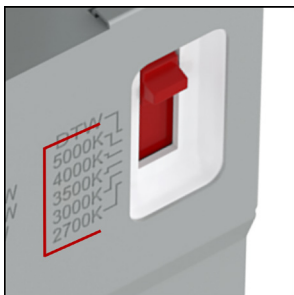

OR



OR

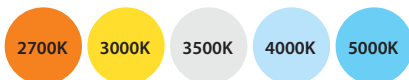
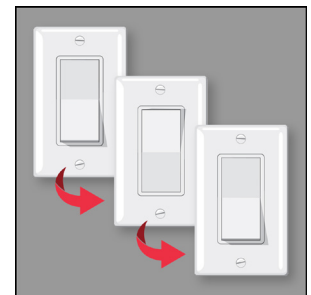

Choose from 5 CCTs
on Driver



Select Dim-to-Warm & Adjust
from your Dimmer



Toggle Switch On/Off/On
for Nightlight



FEATURE PAGE



50,000-HOUR
LED LIFESPAN



NO-COMPROMISE
WARRANTY

5-YEAR
NO COMPROMISE
WARRANTY

RAB's warranty is
subject to all terms
and conditions found at
rablighting.com/warranty

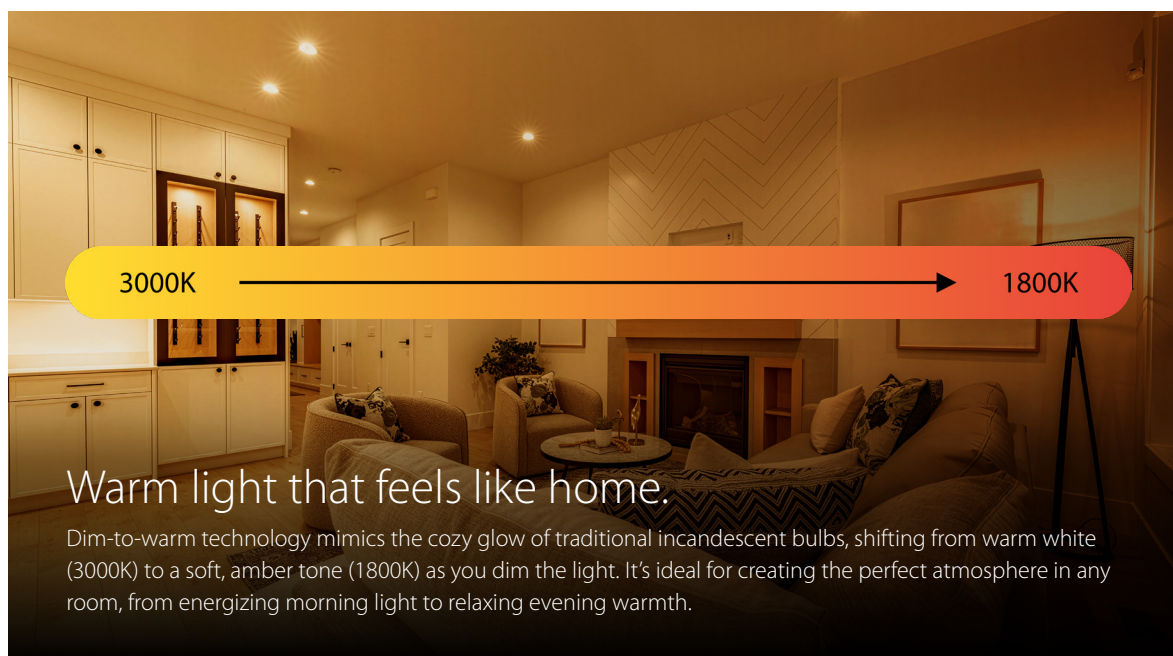

Warm light that feels like home.

Dim-to-warm technology mimics the cozy glow of traditional incandescent bulbs, shifting from warm white (3000K) to a soft, amber tone (1800K) as you dim the light. It's ideal for creating the perfect atmosphere in any room, from energizing morning light to relaxing evening warmth.

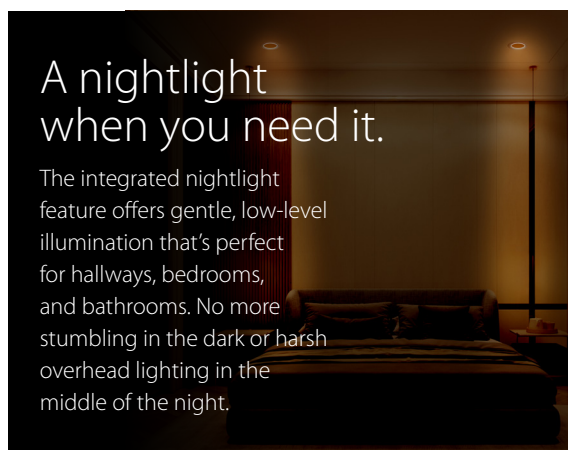

A nightlight when you need it.

The integrated nightlight feature offers gentle, low-level illumination that's perfect for hallways, bedrooms, and bathrooms. No more stumbling in the dark or harsh overhead lighting in the middle of the night.

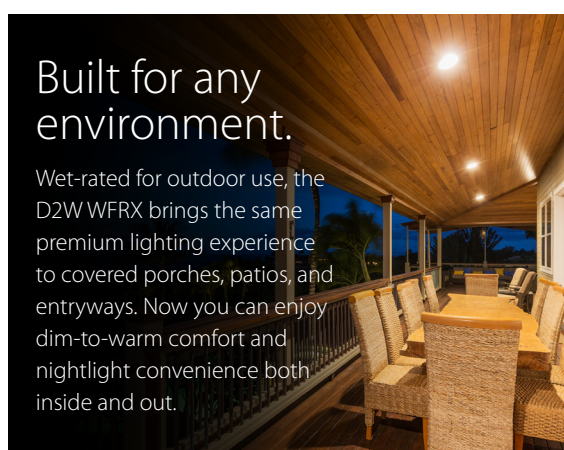

Built for any environment.

Wet-rated for outdoor use, the D2W WFRX brings the same premium lighting experience to covered porches, patios, and entryways. Now you can enjoy dim-to-warm comfort and nightlight convenience both inside and out.

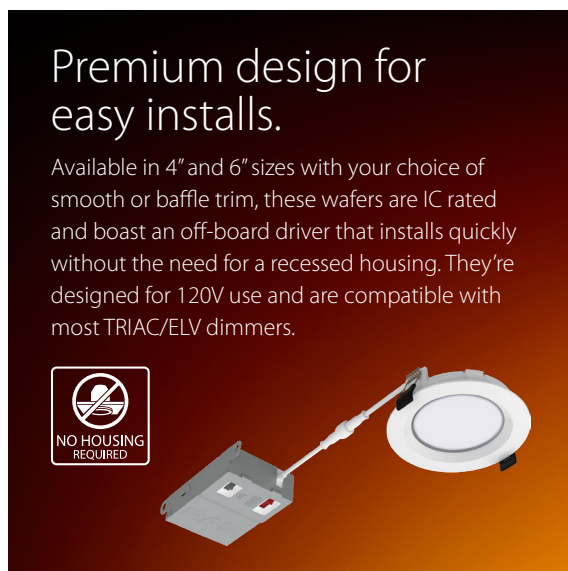

Premium design for easy installs.

Available in 4" and 6" sizes with your choice of smooth or baffle trim, these wafers are IC rated and boast an off-board driver that installs quickly without the need for a recessed housing. They're designed for 120V use and are compatible with most TRIAC/ELV dimmers.

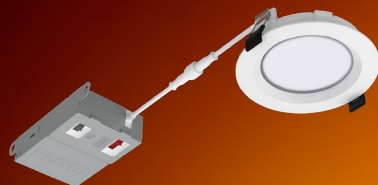

Additional versatility for your space.

All models include 3 selectable lumen outputs for even more ambiance control. One fixture can do it all!

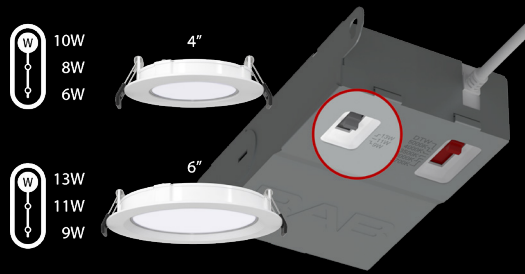

Ordering Matrix

| Product Family | Size/Wattage | Shape | Color Temp | Driver | Finish | Trim | Options |
|----------------|---------------------------------|-------|--|-----------------------|-------------|-----------------------|----------------|
| WFRX | 4 4", 10/8/6W 6 6", 13/11/9W | Round | Blank D2W/2700/3000/3500/4000/5000K CCT Adjustable | Blank 120V, TRIAC/ELV | Blank White | Blank B Smooth Baffle | /NL Nightlight |