

WHAT'S IN THE CEILING...



SOLUTION 1

LED LAMP

- Remove traditional lamp
- Install LED lamp

Examples:
BR30-7.5-830-DIM
A19-9-E26-830-ND
PAR30L-11-830-40D-DIM

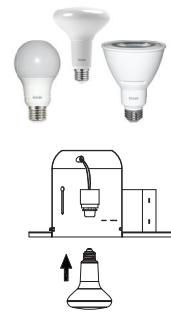

DISK34

- Mount bracket to junction box if needed
- Make electrical connections
- Remove lens
- Mount housing to junction box or to bracket
- Install lens

Example: DSK34-4R12930120WS

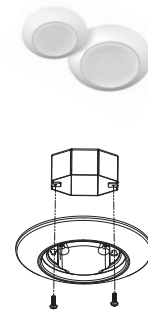

RDCANIC6R + RECESSED RETROFIT

THE OLD WAY OF DOING THINGS:
Remodel Housing + LED Recessed Retrofit Trim

- Install remodeler housing
- Screw in socket adapter
- Make electrical connection
- Install fixture into housing

Example: RDCANIC6R+R6R119FA120WS



HALITE DOWNLIGHT

THE OLD WAY OF DOING THINGS:

- Mount new construction housing
- Install drywall/acoustical tile
- Make electrical connections
- Attach LED module to trim
- Install module/trim combination into housing

Example: NDCANIC4R + HALE8-80FRYHC + HATRIM4RD-W



SOLUTION 2

RECESSED RETROFIT, FIELD ADJUSTABLE

- Remove traditional lamp and trim
- Select desired color temperature
- Screw in socket adapter
- Make electrical connection
- Install retrofit into housing

Example: R6R89FA120WB

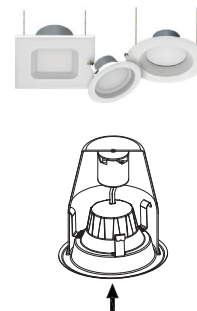

DISK, FIELD-ADJUSTABLE

- Select desired color temperature
- Mount bracket to junction box
- Make electrical connections
- Snap fixture into bracket

Example: DSK6R119FA120WS

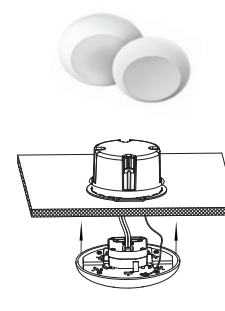

2" REMODELER DOWNLIGHT

THE OLD WAY OF DOING THINGS:

- Install ceiling collar (trim version) or spackled flange (trimless version) into ceiling
- Make electrical connections
- Install remodeler into ceiling collar or spackled flange

Example: RDDLED2R-10D-40Y-W-WT

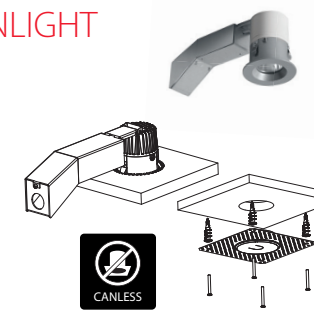

NDLED DOWNLIGHT

THE OLD WAY OF DOING THINGS:

- Mount new construction housing
- Install drywall/acoustical tile
- Make electrical connections
- Install LED trim module into housing

Example: ND6R20D + NDLED6RD-80Y-M-W



SOLUTION 3

DISK34

- Remove traditional lamp and trim
- Screw in socket adapter
- Install friction clips (4" models) or torsion springs (6" models) onto the fixture (sold separately for 90 CRI models)
- Make electrical connection
- Install fixture into housing

Example: DSK34-6R16930120WS

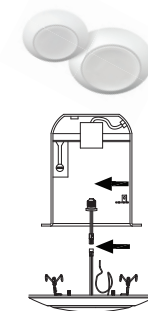

SKEET® XL

- Mount bracket to junction box
- Remove lens
- Make electrical connections
- Mount fixture to bracket
- Install lens

Example: SK12XL12RY

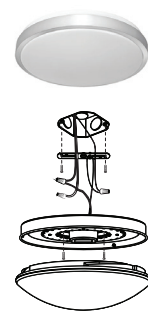

2" DOWNLIGHT

THE NEW WAY OF DOING THINGS:

- Mount driver box
- Make electrical connections
- Deflect mounting springs and release in hole

Example: R2R8930120WB



DEEP-REGRESS COMMERCIAL DOWNLIGHT

THE NEW WAY OF DOING THINGS:

- Select desired color temperature & wattage
- Install mounting plate
- Mount driver box
- Make electrical connections
- Install drywall/acoustical tile
- Deflect mounting springs and release in hole

Example: C6R12/18/249FAUNVW + DLPLATE/C3468R/NB

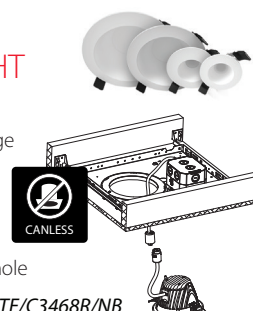

SOLUTION 4

EDGE-LIT SURFACE MOUNT

- Remove traditional lamp and trim
- Screw in socket adapter
- Install friction clips (5.5" models) or torsion springs (7" models) onto the fixture (sold separately for 90 CRI models)
- Make electrical connection
- Install fixture into housing

Example: SM7R15830120W

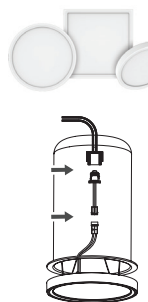

EDGE-LIT SURFACE MOUNT

- Mount bracket to junction box
- Make electrical connections
- Snap fixture into bracket

Example: SM5.5R10830120W

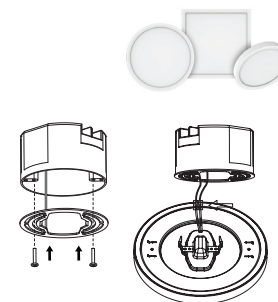

DEEP-REGRESS WAFER, FIELD ADJUSTABLE

THE NEW WAY OF DOING THINGS:

- Select desired color temperature
- Mount driver box
- Make electrical connections
- Deflect mounting springs and release in hole

Example: WFRD6R139FA120WS



EDGE-LIT WAFER, FIELD ADJUSTABLE

THE NEW WAY OF DOING THINGS:

- Select desired color temperature
- Install mounting plate
- Mount driver box
- Make electrical connections
- Install drywall/acoustical tile
- Deflect mounting springs and release in hole

Example: WFRL4R99FA120WB+DLPLATE/WFR3468/NB

