

# HAZFX Hazardous Location Floodlights



## HAZFX 30-60W



Slipfitter Mount



Yoke Mount

PROJECT:

DATE:

TYPE:

PREPARED BY:

## HAZFX 100-200W



Slipfitter Mount



Yoke Mount



### KEY FEATURES

- Floodlights for hazardous location, available in two sizes and five wattages: Small: **30W, 60W** Large: **100W, 150W, and 200W**
- 5000K CCT**
- Certified for **Class 1, Div 1, Groups C, D** and **Class 1, Div 2, Groups A, B, C, D** with temperature rating of **T4-T6** (check the model)
- 120-277V, 480V** available on 100W, 150W, and 200W models
- Available accessories: **Wire guards** and **hoods**. **Yoke** mount standard, **slipfitter** option available. Adjustable arm available for both sizes.
- IP66 Rated**
- 5-year, no-compromise warranty

## HAZFX - Class 1, Div 1 Floodlights



0-10V



100,000  
HOURS



WET  
RATED



IP RATING

### PERFORMANCE

MODEL#	HAZFX30	HAZFX60	HAZFX100	HAZFX150	HAZFX200
	5000K	5000K	5000K	5000K	5000K
Wattage	30W	60W	100W	150W	200W
Input Watts	30.7W	61.5W	103.0W	156.6W	202.2W
Lumens	4,768	9,219	16,056	24,560	30,794
Efficacy	155.3	149.9	155.9	156.8	152.3
CRI	71	71	71	71	71
Voltage Ratings	120-277V				

MODEL#	HAZFX100	HAZFX150	HAZFX200
	5000K	5000K	5000K
Wattage	100W	150W	200W
Input Watts	101.6W	150.2W	194.4W
Lumens	16,091	24,526	30,458
Efficacy	158.4	163.3	156.7
CRI	71	71	71
Voltage Ratings	480V		

# HAZFX Hazardous Location Floodlights



## TECHNICAL SPECIFICATIONS

### COMPLIANCE

#### UL Listed

Suitable for wet locations. Suitable for mounting within 1.2m (4ft) of the ground.

#### DLC Listed

This product is on the Design Lights Consortium (DLC) Qualified Products List and is eligible for rebates from DLC Member Utilities. Designed to meet DLC 5.1 requirements

MODEL#	VOLTAGE	DLC ID
HAZFX30	120-277V	S-6Z1GR1
HAZFX60	120-277V	S-WHGLKZ
HAZFX100	120-277V	S-QWJH66
HAZFX100/480	480V	S-WYJYLG
HAZFX150	120-277V	S-86GDPQ
HAZFX150/480	480V	S-D4B0WF
HAZFX200	120-277V	S-04BXB9
HAZFX200/480	480V	S-38YPQ0

#### Hazardous Location Classifications

##### Class 1, Division 1 (Groups C, D) & Class 1, Division 2 (Groups A, B, C, D)

Class 1 (Hazardous Material in Surrounding

Atmosphere): Flammable vapors or gases may be present

Division 1 (Presence of Hazardous Materials):

Ignitable concentrations of hazards exist only under normal operating conditions

Division 2 (Presence of Hazardous Materials):

Ignitable concentrations of hazards exist only under accidental system breakdowns or abnormal operating conditions

##### Groups A, B, C, D (Hazardous Material in Surrounding Atmosphere):

A = Acetylene

B = Hydrogen, butadiene, ethylene oxide, propylene oxide and acrolein

C = Ethylene, cyclopropane and ethyl ether

D = Acetone, ammonia, benzene, butane, ethanol, gasoline, hexane, methane, methanol, naphtha, natural gas, propane & toluene

#### NEC/CE T-CODE

MODEL#	Class1, Div 1, Group C,D	Class1, Div 2, Group A,B,C,D
HAZFX30	T6	T5
HAZFX60	T6	T4
HAZFX100	T6	T4A
HAZFX100/480	T6	T4A
HAZFX150	T6	T4A
HAZFX150/480	T6	T4A
HAZFX200	T5	T4
HAZFX200/480	T5	T4

#### IP Rating

Ingress protection rating of IP66 for dust and water

#### IESNA LM-79 & LM-80 Testing:

RAB LED luminaires and LED components have been tested by an independent laboratory in accordance with IESNA LM-79 and LM-80.

### CONSTRUCTION

#### Cold Weather Starting

Minimum starting temperature is -40°C (-40°F)

#### Maximum Ambient Temperature

30W & 60W model: Suitable for use in up to 60°C (140°F)

150W, 200W Models: Suitable for use in up to 55°C (131°F)

100W with 480V Models: Suitable for use in up to 60°C (140°F)

#### Housing

Die-cast aluminum

#### Mounting

Yoke and slipfitter

#### Tilt increment

Slipfitter: 6°

#### Lens

Clear glass + 7H6V Polycarbonate Lens

#### Reflector

Polycarbonate

#### Gaskets

High-temperature silicone

#### Vibration Rating

3G vibration rating per ANSI C136.31

#### Green Technology

Mercury and UV free. RoHS-compliant components.

#### Finish

Formulated for high durability and long lasting color

### OPTICAL

#### NEMA Type:

NEMA Beam Spread of 7H x 6V

### LED CHARACTERISTICS

#### LEDs

Long-life, high-efficacy, surface-mount LEDs

#### Color Uniformity

RAB's range of Correlated Color Temperature follows the guidelines of the American National Standards for Specifications for the Chromaticity of Solid State Lighting (SLL) Products, ANSI C78.377-2017.

#### Color Consistency

7-step MacAdam Ellipse binning to achieve consistent fixture-to-fixture color.

# HAZFX Hazardous Location Floodlights



## TECHNICAL SPECIFICATIONS (CONTINUED)

### ELECTRICAL

#### Drivers:

Constant Current, Class 2, 120-277V, 50/60 Hz

**30W:** 0.25A @120V, 0.15A @208V, 0.13A @ 240V, 0.11A @ 277V

Constant Current, Class 1, 120-277V, 50/60 Hz

**60W:** 0.52A @120V, 0.30A @208V, 0.26A @ 240V, 0.23A @ 277V

**100W:** 0.87A @120V, 0.50A @208V, 0.44A @ 240V, 0.38A @ 277V

**150W:** 1.27A @120V, 0.73A @208V, 0.64A @ 240V, 0.55A @ 277V

**200W:** 1.70A @120V, 0.99A @208V, 0.85A @ 240V, 0.74A @ 277V

Constant Current, Class 1, 480V, 50/60 Hz

**100W:** 0.22A at 480V

**150W:** 0.32A at 480V

**200W:** 0.42A at 480V

#### Surge Protection:

L/N-G 10KV, L-N 6KV

#### Dimming Driver:

Driver includes dimming control wiring for 0-10V dimming systems. Requires separate 0-10V DC dimming circuit. Dims down to 10%.

#### THD:

**30W:** 4.07% at 120V, 14.0% at 277V

**60W:** 2.5% at 120V, 6.8% at 277V

**100W:** 1.4% at 120V, 6.3% at 277V

**100W:** 4.6% at 480V

**150W:** 2.6% at 120V, 5.2% at 277V

**150W:** 1.8% at 480V

**200W:** 5.4% at 120V, 4.3% at 277V

**200W:** 6.5% at 480V

### ELECTRICAL

#### Power Factor:

**30W:** 99.5% at 120V, 92.3% at 277V

**60W:** 99.7% at 120V, 91.4% at 277V

**100W:** 99.9% at 120V, 96.6% at 277V

**100W:** 95.0% at 480V

**150W:** 99.9% at 120V, 95.0% at 277V

**150W:** 96.9% at 480V

**200W:** 99.5% at 120V, 95.5% at 277V

**200W:** 93.0% at 480V

Note: All values are typical (tolerance +/- 10%)

### OTHER

#### Warranty

The RAB 5-year, limited warranty covers light output, driver performance and paint finish. RAB's warranty is subject to all terms and conditions found at [rablighting.com/warranty](http://rablighting.com/warranty)

#### Lifespan

100,000-hour LED lifespan based on IES LM-80 results and TM-21 calculations

## DIMENSIONS (CONTINUED)

### HAZFX30-60W

#### Weight:

Models with yoke mount: 20.5 lbs

Models with slipfitter mount: 22.6 lbs

Models with Adjustable Arm: 23.7 lbs

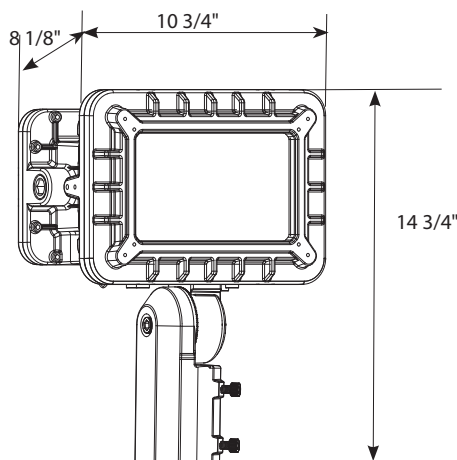
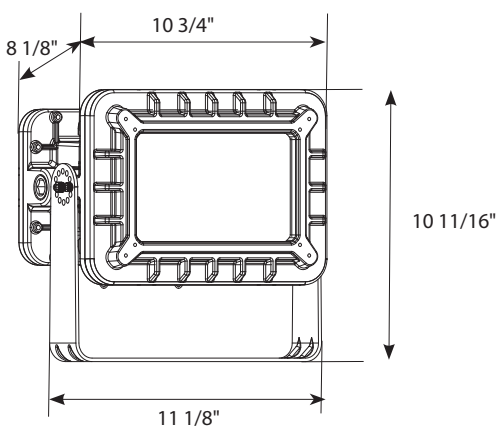

#### GDHAZFXS

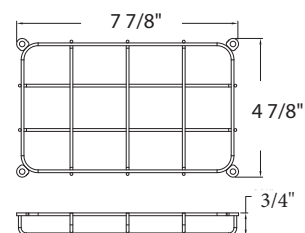

#### HHAZFXS

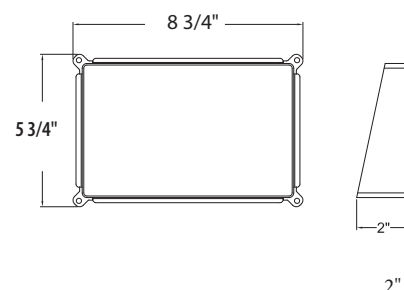

# HAZFX Hazardous Location Floodlights



## DIMENSIONS (CONTINUED)

### HAZFX100-200W

Weight:

Models with yoke mount: 36.5 lbs

Models with slipfitter mount: 38.6 lbs

Models with Adjustable Arm: 39.7 lbs

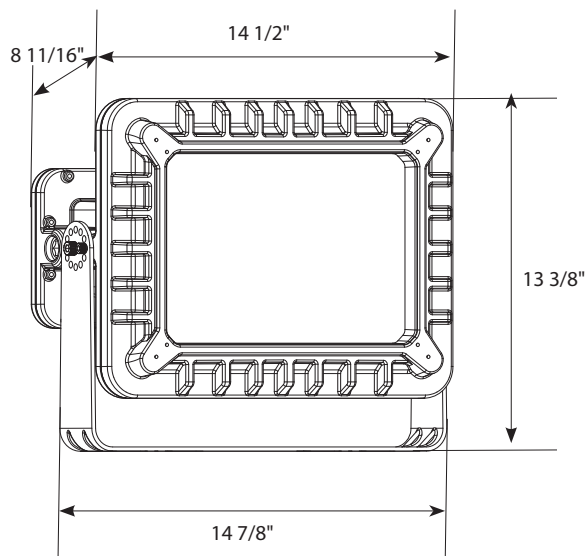

GDHAZFXL

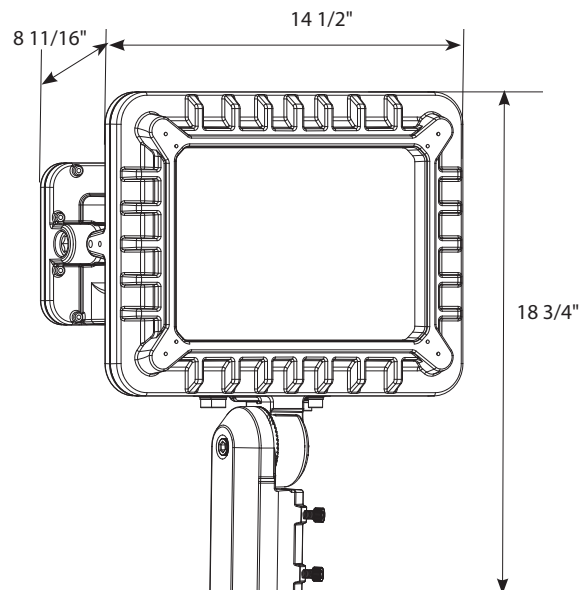

HHAZFXL

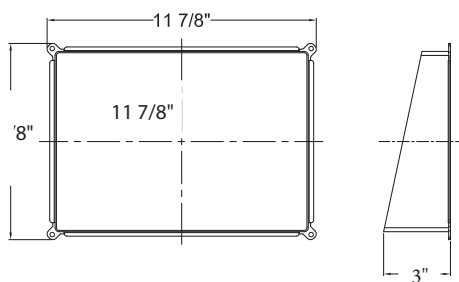
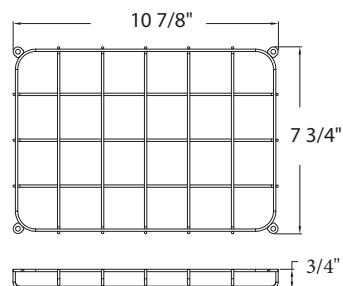

### HAZFF-ADJ-ARM (30W-200W)

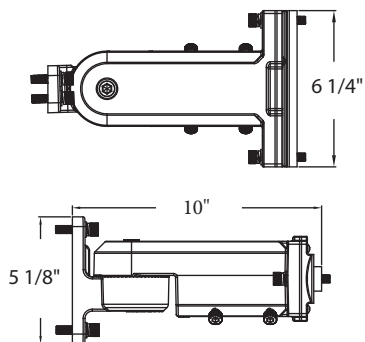

Weight: 3.6 lbs



# HAZFX Hazardous Location Floodlights

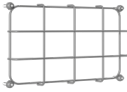
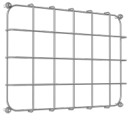

## ACCESSORIES

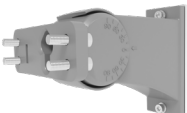
IMAGE	SKU#	UPC	DESCRIPTION
	GDHAZFXS	192552017039	HAZFX WIRED GUARD SMALL FOR 30W 60W
	GDHAZFXL	192552017046	HAZFX WIRED GUARD LARGE FOR 100W 150W 200W
	HHAZFXS	192552017053	HAZFX HOOK SMALL FOR 30W 60W
	HHAZFXL	192552017060	HAZFX HOOK LARGE FOR 100W 150W 200W
	HAZFF-ADJ-ARM	192552032476	HAZ FLOOD ADJUSTABLE ARM FOR HAZFX FIXTURES

## ORDERING MATRIX

### HAZFX

Family	Wattage		Mounting		Color Temp		NEMA Type		Finish		Driver
HAZFX											
	30	30W	BLANK	Yoke	BLANK	5000K	BLANK	7H X 6V	BLANK	Gray	BLANK 120-277V,
	60	60W	SF	Slipfitter							0-10V dimming
	100	100W									480V,
	150	150W									0-10V dimming
	200	200W									

\* 480V option only available on 100W, 150W, and 200W model