

# INSTRUCTIONS

## L2X INSTALLATION



RAB Lighting is committed to creating high-quality, affordable, well-designed and energy-efficient LED lighting and controls that make it easy for electricians to install and end users to save energy. We'd love to hear your comments. Please call the Marketing Department at 888-RAB-1000 or email: [marketing@rablighting.com](mailto:marketing@rablighting.com)



### IMPORTANT

**CAUTION:** All wiring **MUST** comply with local electrical codes and should be installed by qualified electrician. Read entire Installation Manual before proceeding. **TURN OFF POWER BY REMOVING POWER FUSE OR TURNING OFF CIRCUIT BREAKER BEFORE INSTALLATION.**

• These instructions do not cover all details or variations in equipment nor do they provide for every possible situation during installation, operation or maintenance.

### WARNING: RISK OF ELECTRICAL SHOCK

- Turn off electrical power at fuse or circuit breaker box before wiring fixture to the power supply.
- Verify that the supply voltage is correct. Connect fixture to a 120 volt, 60 Hz power source.

## INSTALLATION

### Step 1: Installing the Mounting Bracket *(see parts list on last page)*

1. Line up the holes on the **Mounting Bracket** with the holes on **Junction Box** *(by others)*. Using the two **Mounting Screws** (**F** or **G**).
2. Attach the Ground wire to the **Mounting Bracket** (**E**), using **Ground Screw** (**K**).

Fig: 1

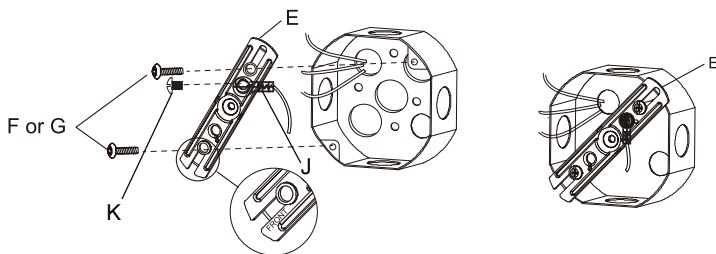

### Step 2: Making Electrical Connections.

1. Connect the fixture wires through **Gasket** to the **Junction Box** wires with wire nuts as shown in Fig 2.
2. White to **Neutral**  
Black to **Line**  
Green ground wire to ground

Fig: 2

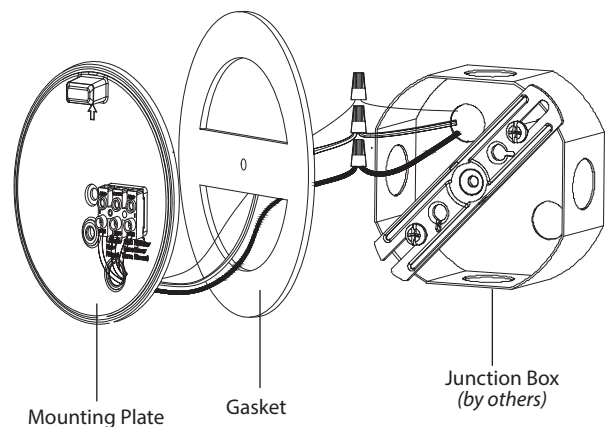

# INSTRUCTIONS

## L2X INSTALLATION



RAB Lighting is committed to creating high-quality, affordable, well-designed and energy-efficient LED lighting and controls that make it easy for electricians to install and end users to save energy. We'd love to hear your comments. Please call the Marketing Department at 888-RAB-1000 or email: [marketing@rablighting.com](mailto:marketing@rablighting.com)

### INSTALLATION (cont'd)

#### Step 3: Installing the Mounting Plate.

1. Place the **Mounting Plate** and **Foam Gasket** against the **Junction Box** (Fig. 2).
2. Insert the small mounting bolt through the **Mounting Plate** hole and **Mounting Bracket** hole. Tighten the bolt securely.

#### Step 4: Mounting the Light Fixture.

1. Align the bottom edge of the light fixture (A) with the bottom edge of the **Mounting Plate** (D). Tilt the light fixture (A) toward the **Mounting Plate** (D), making sure the light fixture (A) is centered on the **Mounting Plate** (D) as shown in Fig 3.
2. Tighten the large pre-installed **Mounting Bolt** (H) securely through the center of the **Mounting Plate** (D). Do not overtighten.
3. Push the **Decorative Cap** firmly into the large **Mounting Bolt Hole** on the light fixture (A).

Fig: 3

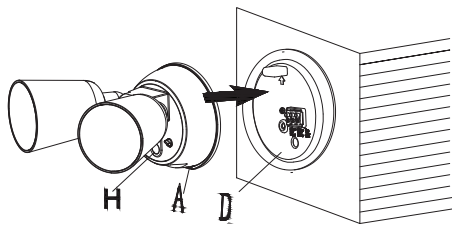

#### Step 5: Caulking Around the Light Fixture.

1. Caulk around the canopy and mounting surface with silicone sealant (by others) as shown in Fig 4.

Fig: 4

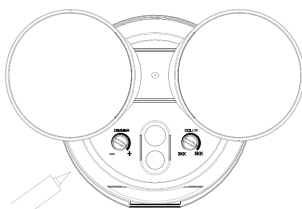

### OPERATION

#### Step 6: Adjusting the Lamp Heads.

1. Lamp heads can be adjusted easily. You may adjust the lamp head left and right or up and down to get the desired lamp direction (Fig. 5).

Fig: 5

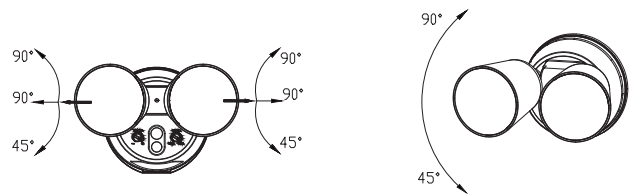

**Note: LED LAMPS ARE NON-REPLACEABLE.** Do not attempt to access or maintain the LEDs; they are non-replaceable and any contact may damage the LEDs and will void the warranty.

#### Default Settings:

- Dimmer: 2096lm
- CCT: 5000K

#### Photocell Settings:

**(ON)** enables the Dusk to Dawn function. The product is turned off during the day and on at night (Fig. 6).

Enter Lux: 5~35Lx

Exit Lux: 70~150Lx

**(OFF)** disables the Dusk to Dawn function. The steady mode is displayed day and night.

Fig: 6

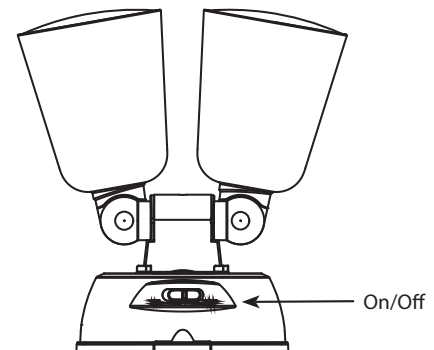

# INSTRUCTIONS

## L2X INSTALLATION



RAB Lighting is committed to creating high-quality, affordable, well-designed and energy-efficient LED lighting and controls that make it easy for electricians to install and end users to save energy. We'd love to hear your comments. Please call the Marketing Department at 888-RAB-1000 or email: [marketing@rablighting.com](mailto:marketing@rablighting.com)

### OPERATION *(cont'd)*

#### Dimmer Setting.

To adjust the brightness of the Floodlights:  
Set the “DIMMER” to the — position for 10% brightness, adjust to the + position for 100% brightness.

#### Color Setting.

To adjust the LED color temperature of the Floodlight:  
Set the “COLOR” dial to the **3K** position for 3000K, adjust to the **5K** position for 5000K (*Color Temperature range is 3000K - 5000K*) Fig. 7.

Fig: 6

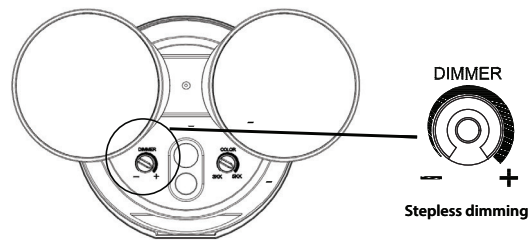
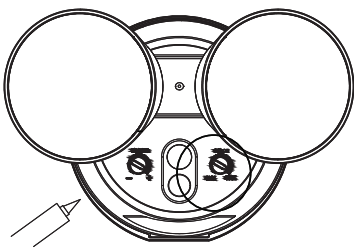
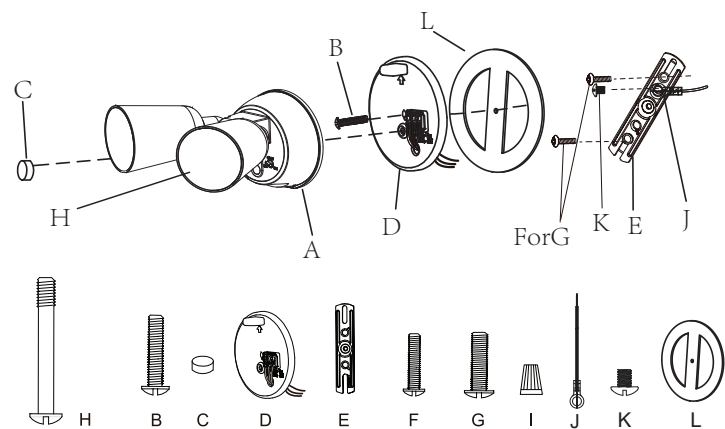

Fig: 7



### PARTS LIST



Part	Description	Quantity
A	Light Fixture	1
B	Small Mounting Bolt	1
C	Decorative Cover	1
D	Mounting Plate	1
E	Mounting Bracket	1
F	#6-32 x 1" Junction Box Screw	2
G	#8-32 x 1" Junction Box Screw	2
H	Large Mounting Bolt (pre-installed)	1
I	Wire Nut	3
J	Ground Wire	1
K	Ground Wire Screw	1
L	Gasket	1

**Note:** These instructions do not cover all details or variations in equipment nor do they provide for every possible situation during installation, operation or maintenance.

#### Easy Answers

[rablighting.com](http://rablighting.com)  
Visit our website for product info

**Tech Help Line**  
Call our experts: 888 722-1000

**e-mail**  
Answered promptly - [tech@rablighting.com](mailto:tech@rablighting.com)

**Free Lighting Layouts**  
Answered online or by request