

CCT-Adjustable DISK17



4" & 6", CCT-Adjustable, 120V,
TRIAC Dimmable



PROJECT:

DATE:

TYPE:

PREPARED BY:



KEY FEATURES

- **Ultra low-profile, back-lit design** made of durable thermoplastic with frosted lens
- **5 selectable color temperatures** in each fixture (2700/3000/3500/4000/5000K)
- **Easy surface mount installation** with included keyholes and compatible with 3/0 & 4/0 junction boxes
- Designed and Certified to Comply with NEC Code 410.16(A)(3) and NEC Code 410.16(C)(5) for Installation in Closet Storage Space
- Wet Location, Title 24, & Energystar rated, 5-year warranty
- Packaged in bulk case quantities of 12

PERFORMANCE

Catalog Number	Size	Trim Style	Wattage Equivalency	Input Wattage	Lumens	Efficacy (lm/W)	Dim Type	Input Voltage	Beam Angle	Color Temperature	CRI	L70 Lifespan	Environment	Energy Star ID
DISK17-4/BP	4"	Smooth	60W Incandescent	7W	600 lm	86	TRIAC/ELV	120V	90°	Field adjustable via dip switch 2700/3000/3500/4000/5000K	90	50,000 hrs	Wet	3999335
DISK17-6/BP	6"		75W Incandescent	10W	900 lm	90								3999336

4" DISK17

Catalog Number	Wattage	Color Temperature (CCT)	Lumens (lm)	Efficacy (lm/W)	Equivalency
DISK17-4/BP	7W	2700K	597	91.7	60W Incandescent
		3000K	624	95.4	
		3500K	663	99.7	
		4000K	657	99.9	
		5000K	641	98.5	

6" DISK17

Catalog Number	Wattage	Color Temperature (CCT)	Lumens (lm)	Efficacy (lm/W)	Equivalency
DISK17-6/BP	10W	2700K	892	93.2	75W Incandescent
		3000K	912	95.2	
		3500K	958	98.5	
		4000K	947	98.2	
		5000K	946	98.5	

TECHNICAL SPECIFICATIONS

CONSTRUCTION

Product Type
Disk

Size
4", 6"

Shape
Round

Trim Style
Smooth

Enclosure Material
Polycarbonate UV resistant housing

Finish
White - Decorative color overlays available (sold separately)

Lens Finish
Twist-lock lens makes it easy to remove and attach during installation with UV resistant polycarbonate diffuser

ELECTRICAL

Dimmable
Yes, dimmable down to 10% on compatible TRIAC/ELV dimming systems. See Dimmer Compatibility List.

Driver
Constant Current, 120V, 60 Hz; @ 120V: 60 mA

Input Voltage
120V

Operating Frequency
60 Hz

Operating Temperature
-4°F to 104°F (-20°C to 40°C)

Power Factor
0.9

Flicker
<30%

LED CHARACTERISTICS

Beam Angle
90°

Color Temperature
Field adjustable via dip switch 2700/3000/3500/4000/5000K

Color Accuracy (CRI)
90

R9 Value
High color performance with R9 greater than 50

Color Consistency
<4-step MacAdam Ellipse binning to achieve consistent fixture-to-fixture color

COMPLIANCE

Listings
UL Listed

Environment
Suitable for use indoors and outdoors in dry, damp, or wet environments.

IC Rated
No

Air Tight
No

Energy Star Approved
This product is ENERGY STAR® Certified.

California Title 24 JA8 Compliant
Can be used to conform with the requirements of California Title 24 Part 6.

California Energy Commission (CEC) Status
Lawful for Sales in California

NEC Compliant
Suitable for use in closets. Compliant with NEC Sec. 410.16 (A)(1) and 410.16 (C1).

IESNA LM-79 & LM80 Testing
RAB LED luminaires and LED components have been tested by an independent laboratory in accordance with IESNA LM-79 and LM-80.

RoHS
Mercury and UV free. RoHS-compliant components.

FCC
Complies with Part 15 of the FCC Rules

WARRANTY

The RAB 5-year, limited warranty covers light output, driver performance and paint finish. RAB's warranty is subject to all terms and conditions found at

DIMENSIONS

4" DISK17

Weight .26lbs

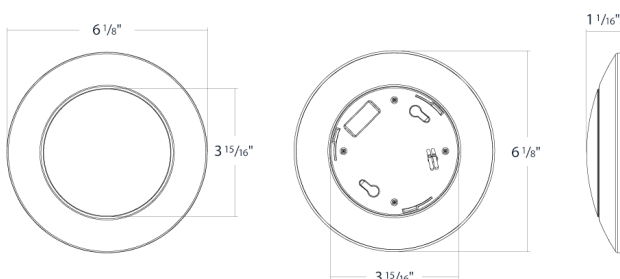

6" DISK17

Weight .39lbs

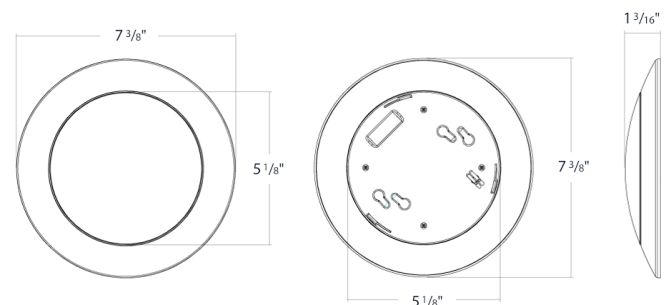

ACCESSORIES

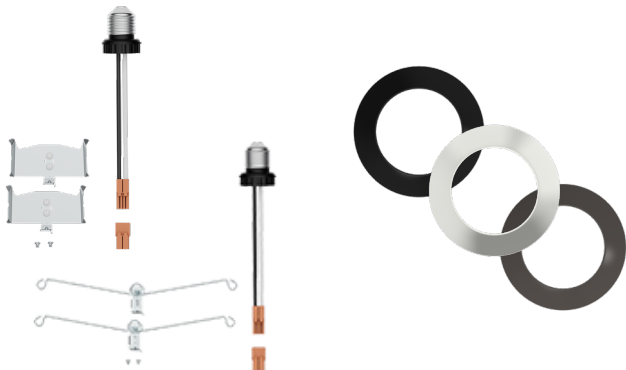

Catalog Number	UPC	Description
DSKFA4/PIR/ACC	192552018975	Mounting hardware
DSKFA6/PIR/ACC	192552018982	Mounting hardware
DISK34-TRIM-4-BRZ	192552040020	4" Round Bronze Trim
DISK34-TRIM-4-BN	192552040013	4" Round Brushed Nickel Trim
DISK34-TRIM-4-BLK	192552040006	4" Round Black Trim
DISK34-TRIM-6-BRZ	192552040051	6" Round Bronze Trim
DISK34-TRIM-6-BN	192552040044	6" Round Brushed Nickel Trim
DISK34-TRIM-6-BLK	192552040037	6" Round Black Trim

ORDERING INFO

Catalog Number	Model Number	UPC	Case Pack
DISK17-4/BP	DLS0190(DISK17-4/BP)	192552045889	12
DISK17-6/BP	DLS0191(DISK17-6/BP)	192552045896	12

ORDERING MATRIX

Family	Size/Wattage	Shape	CRI/Color Temp	Driver	Finish	Options
DISK17	-					/BP
	4 4"/9W 6 6"/10W	Blank Round	Blank 90CRI, 2700/3000/3500/4000/5000K CCT Adjustable	Blank 120V, TRIAC/ELV	Blank White	/BP Bulk 12-Pack

CCT-Adjustable DISK17



Dimmer Compatibility List

DISK17-4/BP

DISK17-6/BP

Visit www.rablighting.com for periodic updates to this list or contact us at 888-722-1000 for questions or comments.

Dimmers			Lamp Quantities				Dimming Level
Dimmer Brand	Series	Dimmer Model	1	4	8	10	
LUTRON	Maestro C-L	MACL-153M	✓	✓	✓	✓	10-100%
LUTRON	Skylark C-L	SCL-153P	✓	✓	✓	✓	10-100%
LEVITON	Sureslide	Cat.NO.6674	✓	✓	✓	✓	10-100%
LUTRON	Diva C-L	DVCL-153P	✓	✓	✓	✓	10-100%
LUTRON	Skylark	CTCL-153PDH-WH	✓	✓	✓	✓	10-100%
LUTRON	Toggler	TGCL-153PH-WH	✓	✓	✓	✓	10-100%
LUTRON	Diva C-L	DVWCL-153PH-WH	✓	✓	✓	✓	10-100%
RAB		XDIM	✓	✓	✓	✓	10-100%

R34 CCT-Adjustable Retrofit Downlight

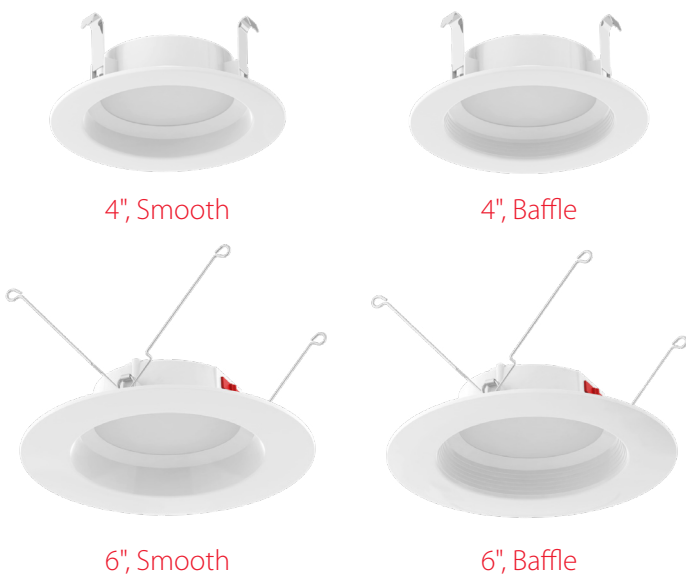

4" & 5/6", CCT-Adjustable, 120V TRIAC
Dimming, Smooth & Baffle



PROJECT: _____

DATE: _____

TYPE: _____

PREPARED BY: _____



KEY FEATURES

- Use to replace traditional halogen and incandescent light sources
- 5 selectable color temperatures (2700/3000/3500/4000/5000K)
- Compatible with most standard recessed housings
- E26 Edison base adapter included
- Anti-UV plastic extends the life of the housing
- 50,000-hour lifespan
- Now available in 12-pack contractor packs

PERFORMANCE

Catalog Number	Size	Trim Style	Wattage Equivalency	Input Wattage	Lumens	Efficacy	Color Temperature	CRI	L70 Lifespan
R34-4	4"	Smooth	60W Incandescent	7.5W	700 lm	93 lm/W	Field-Adjustable dip switch 2700/3000/3500/4000/5000K	90+	50,000 hr
R34-4/BP		Baffle	60W Incandescent	7.5W	700 lm	93 lm/W			
R34-4B	4"	Baffle	60W Incandescent	7.5W	700 lm	93 lm/W			
R34-4B/BP		Baffle	60W Incandescent	7.5W	700 lm	93 lm/W			
R34-6	6"	Smooth	75W Halogen	10W	900 lm	90 lm/W			
R34-6/BP		Smooth	75W Halogen	10W	900 lm	90 lm/W			
R34-6B	6"	Baffle	75W Halogen	10W	900 lm	90 lm/W			
R34-6B/BP		Baffle	75W Halogen	10W	900 lm	90 lm/W			

Catalog Number	Wattage	CCT	Efficacy	Lumens	Wattage Equivalency
R34-4 R34-4/BP	7.5W	2700K	98 lm/W	726 lm	60W Incandescent
		3000K	101 lm/W	757 lm	
		3500K	109 lm/W	805 lm	
		4000K	108 lm/W	798 lm	
		5000K	104 lm/W	767 lm	
R34-4B R34-4B/BP	7.5W	2700K	96 lm/W	714 lm	60W Incandescent
		3000K	100 lm/W	747 lm	
		3500K	106 lm/W	794 lm	
		4000K	106 lm/W	787 lm	
		5000K	102 lm/W	755 lm	

R34 CCT-Adjustable Retrofit Downlight



PERFORMANCE (CONT'D)

Catalog Number	Wattage	CCT	Efficacy	Lumens	Wattage Equivalency
R34-6 R34-6/BP	10W	2700K	99 lm/W	912 lm	75W Halogen
		3000K	101 lm/W	943 lm	
		3500K	103 lm/W	981 lm	
		4000K	103 lm/W	968 lm	
		5000K	103 lm/W	940 lm	
R34-6B R34-6B/BP	10W	2700K	99 lm/W	912 lm	75W Halogen
		3000K	103 lm/W	961 lm	
		3500K	103 lm/W	989 lm	
		4000K	105 lm/W	987 lm	
		5000K	104 lm/W	951 lm	

TECHNICAL SPECIFICATIONS

CONSTRUCTION

Product Type

Recessed Retrofit Downlight

Size

4" & 6"

Shape

Round

Enclosure Material

Injection molded plastic construction is impactresistant and non-corrosive
Non-conductive construction meets most local dead-front code requirements

Finish

White

Lens

Polycarbonate

Trim Style

Smooth, baffle

Installation Assembly

- Fully captured V-springs on 6"
- Friction clips on 4"

INSTALLATION

Mounting

Requires recessed housing

4" - Compatible on most standard 4" housings

6" - Compatible on most standard 5" or 6" housings

Base Type

E26 Edison

COMPLIANCE

Listing

UL Classified

Environment

Suitable for use in dry, damp, and wet environments.

UV Rated

Suitable for exposure to direct sunlight.

Energy Star Approved

Yes

Air Tight

Airtight per ASTM-E283

DLC Listed

No. There is no product category on the Design Lights Consortium (DLC) Qualified Products List for this product to qualify under.

T20 Compliant

Can be used to conform with the requirements of California Title 20.

California Title 24 JA8 Compliant

Yes

California Energy Commission (CEC) Status

Lawful for Sales in California

NEC Compliant

Suitable for use in closets. Compliant with NEC Sec. 410.16 (A)(1) and 410.16 (C3).

IESNA LM-79 & LM80 Testing

RAB LED luminaires and LED components have been tested by an independent laboratory in accordance with IESNA LM-79 and LM-80.

FCC

Complies with Part 15 of the FCC Rules.

RoHS

Mercury and UV free. RoHS-compliant components.

R34 CCT-Adjustable Retrofit Downlight



TECHNICAL SPECIFICATIONS (CONT'D)

ELECTRICAL

Dimmable

Yes, dimmable down to 10% on compatible TRIAC/ELV dimming systems. See Dimmer Compatibility List.

THD

≤20%

Power Factor

≥0.7

Flicker

≤30%

Input Voltage

120V

Operating Frequency

60Hz

Operating Temperature

-13°F to 104°F (-25°C to 40°C)

Beam Angle

90°

LED CHARACTERISTICS

Color Temperature

Field-adjustable dip switch 2700/3000/3500/4000/5000K

Color Accuracy (CRI)

>90

R9 Value

High color performance with R9 greater than or equal to 50

Color Consistency

4-step MacAdam Ellipse binning to achieve consistent fixture-to-fixture color

Color Stability

LED color temperature is warranted to shift no more than 200K in color temperature over a 5-year period

Color Uniformity

RAB's range of Correlated Color Temperature follows the guidelines of the American National Standard for Specifications for the Chromaticity of Solid State Lighting (SSL) Products, ANSI C78.377-2017.

OTHER

Warranty

RAB warrants that our LED products will be free from defects in materials and workmanship for a period of five (5) years from the date of delivery to the end user, including coverage of light output, color stability, driver performance and fixture finish.

RAB's warranty is subject to all terms and conditions found at rablighting.com/warranty.

DIMENSIONS

R34-4, R34-4B

Weight: 0.24 lb

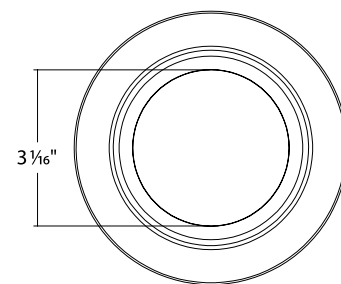
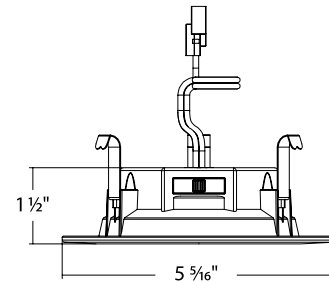

R34-6, R34-6B

Weight: 0.35 lb

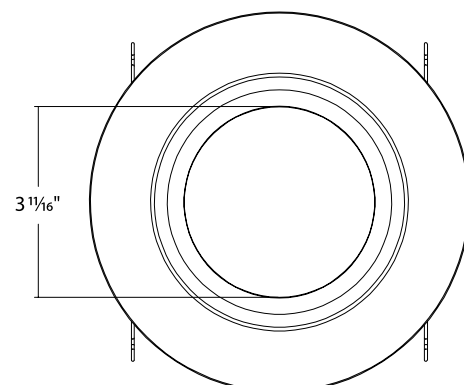
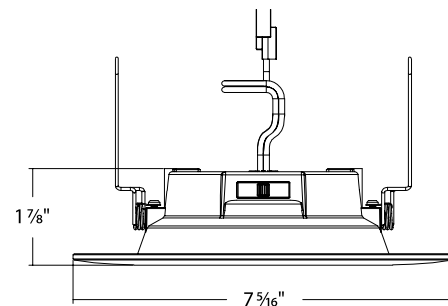

R34 CCT-Adjustable Retrofit Downlight



ACCESSORIES

Baffle Trims

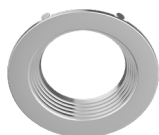

Brushed Nickel



Black



Bronze

Catalog Number	UPC	Description
DLTRIM/R4RB-BN-L	192552028219	4" Brushed nickel trim round baffle
DLTRIM/R4RB-BRZ-L	192552028226	4" Bronze trim round baffle
DLTRIM/R4RB-B-L	192552028202	4" Black trim round baffle
DLTRIM/R6RB-BN	192552000987	6" Brushed nickel trim round baffle
DLTRIM/R6RB-BRZ	192552022279	6" Bronze trim round baffle
DLTRIM/R6RB-B	192552001007	6" Black trim round baffle

Smooth Trims



Brushed Nickel



Black



Bronze

Catalog Number	UPC	Description
DLTRIM/R4RS-BN-L	192552028240	4" Brushed nickel trim round smooth
DLTRIM/R4RS-BRZ-L	192552028257	4" Bronze trim round smooth
DLTRIM/R4RS-B-L	192552028233	4" Black trim round smooth
DLTRIM/R6RS-BN	192552000925	6" Brushed nickel trim round smooth
DLTRIM/R6RS-BRZ	192552022255	6" Bronze trim round smooth
DLTRIM/R6RS-B	192552000949	6" Black trim round smooth

Retrofit Band



Catalog Number	UPC	Description
RFLED-RETROBAND	192552013710	Retrofit band with friction clips

Housings



NDCANIC4R



NDCANIC6R



RDCANIC4R



RDCANIC6R

Catalog Number	UPC	Description
NDCANIC4R	19813702346	4" New construction housing
RDCANIC4R	19813702322	4" Retrofit housing
NDCANIC6R	19813702353	6" New construction housing
RDCANIC6R	19813702339	6" Retrofit housing

Emergency Backup Driver

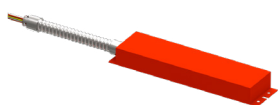

DRI-21-EMGR-DC-D10



DRI-25-EMGR-DC

Catalog Number	UPC	Description
DRI-21-EMGR-DC-D10	192552028264	Emergency driver 21W 0-10V T20
DRI-25-EMGR-DC	019813519180	Emergency driver 25W

R34 CCT-Adjustable Retrofit Downlight



ORDERING INFO

Catalog Number	Certification Model Number	UPC	Case Pack
R34-4	DLR0141(R34-4)	192552031141	6
R34-4B	DLR0142(R34-4B)	192552031158	6
R34-6	DLR0143(R34-6)	192552031165	6
R34-6B	DLR0144(R34-6B)	192552031172	6
R34-4/BP	DLR0141(R34-4)	192552018272	12
R34-4B/BP	DLR0142(R34-4B)	192552018289	12
R34-6/BP	DLR0143(R34-6)	192552018296	12
R34-6B/BP	DLR0144(R34-6B)	192552018302	12

ORDERING MATRIX

Family	Size/Wattage		Shape		CRI/Color Temp		Driver	Finish		Trim	Options	
R34	-											
	4	4", 7.5W	Blank	Round	Blank	90CRI, Field-Adjustable	Blank	120V,	Blank	White	Blank	1 Pack
	6	6", 10W				2700/3000/3500/4000/5000K		TRIAC/ELV			B	Bulk-12 Pack

R34 CCT-Adjustable Retrofit Downlight

Dimmer Compatibility List



R34-4 R34-4/BP
R34-4B R34-4B/BP
R34-6 R34-6/BP
R34-6B R34-6B/BP

Visit www.rablighting.com for periodic updates to this list or contact us at 888-722-1000 for questions or comments.

Number	Dimmers		Quantities			
	Dimmer Brand	Dimmer Model	1	4	6	8
1	RAB	XDIM	✓	✓	✓	✓
2	RAB	XDIM/LCB	✓	✓	✓	✓
3	LUTRON	MACL-153M	✓	✓	✓	✓
4	LUTRON	SCL-153P	✓	✓	✓	✓
5	LEVITON	Cat.NO.6674	✓	✓	✓	✓
6	LUTRON	DVCL-153P	✓	✓	✓	✓
7	LEVITON	NO.6672	✓	✓	✓	✓
8	LEGRAND	RHCL453PTC	✓	✓	✓	✓
9	LEGRAND	DCL453PTCCCV6	✓	✓	✓	✓
10	LEGRAND	HCL453PTCCCV6	✓	✓	✓	✓
11	LUTRON	CTCL-153PDH-WH	✓	✓	✓	✓
12	LUTRON	TGCL-153PH-WH	✓	✓	✓	✓
13	LEVITON	R12-06672-1LW	✓	✓	✓	✓
14	LEVITON	R50-IPL06-10M	✓	✓	✓	✓
15	LUTRON	DVWCL-153PH-WH	✓	✓	✓	✓

Slim, CCT-Adjustable SUMO

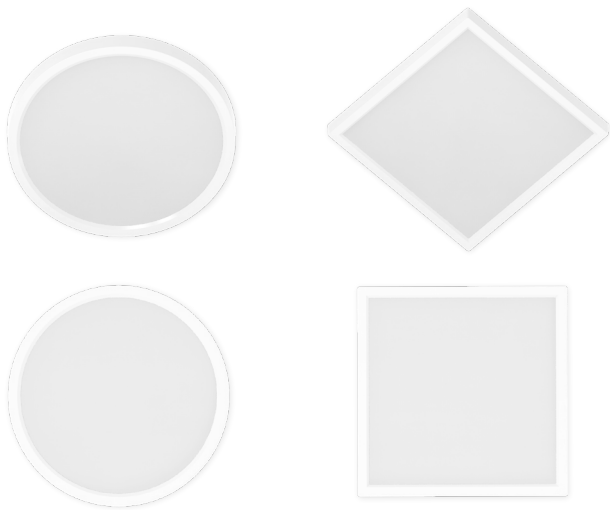

Round

Square

Slim Profile, 5", 7", 9" Round & Square, 5CCT Adjustable, 120V TRIAC Dimmable



PROJECT: _____

DATE: _____

TYPE: _____

PREPARED BY: _____



KEY FEATURES

- Super-slim design with less than 1" profile
- 5 color temperatures in 1 SKU (2700/3000/3500/4000/5000K)
- Wet and damp location rated can be used indoors or outdoors
- Easy to install on a wide variety of junction boxes
- Color trim accessories available
- 50,000-hr lifespan, Dimmable, & Title 24 compliant

PERFORMANCE

Catalog Number	Size	Wattage Equivalency	Input Wattage	Lumens	Efficacy	Dim Type	Input Voltage	Trim Style	CRI	L70 Lifespan
SUMO-R-5	5"	60W Incandescent	10W	890 lm	89 lm/W	TRIAC/ELV	120V	Smooth	90	50,000 hr
SUMO-R-7	7"	75W Incandescent	14W	1,200 lm	86 lm/W					
SUMO-R-7/BP	7"	75W Incandescent	14W	1,200 lm	86 lm/W					
SUMO-R-9	9"	100W Incandescent	18W	1,600lm	89 Lm/W					
SUMO-S-5	5"	60W Incandescent	10W	900 lm	90 lm/W					
SUMO-S-7	7"	75W Incandescent	14W	1,200 lm	86 lm/W					
SUMO-S-9	9"	100W Incandescent	18W	1,530 lm	85 lm/W					

PERFORMANCE (CONT'D)

Catalog Number	Shape	Wattage	CCT	Efficacy	Lumens	Equivalency
SUMO-R-5	Round	10W	2700K	83 lm/W	830 lm	60W
			3000K	84 lm/W	844 lm	
			3500K	88 lm/W	879 lm	
			4000K	90 lm/W	896 lm	
			5000K	89 lm/W	888 lm	
SUMO-R-7 SUMO-R-7/BP		14W	2700K	85 lm/W	1,190 lm	75W
			3000K	85 lm/W	1,194 lm	
			3500K	86 lm/W	1,203 lm	
			4000K	86 lm/W	1,208 lm	
			5000K	87 lm/W	1,218 lm	
SUMO-R-9		18W	2700K	84 lm/W	1,506 lm	100W
			3000K	84 lm/W	1,514 lm	
			3500K	89 lm/W	1,596 lm	
			4000K	90 lm/W	1,622 lm	
			5000K	90 lm/W	1,617 lm	
SUMO-S-5	Square	10W	2700K	86 lm/W	864 lm	60W
			3000K	89 lm/W	892 lm	
			3500K	92 lm/W	915 lm	
			4000K	93 lm/W	928 lm	
			5000K	94 lm/W	940 lm	
SUMO-S-7		14W	2700K	84 lm/W	1,172 lm	75W
			3000K	84 lm/W	1,179 lm	
			3500K	89 lm/W	1,250 lm	
			4000K	90 lm/W	1,261 lm	
			5000K	88 lm/W	1,238 lm	
SUMO-S-9		18W	2700K	82 lm/W	1,471 lm	100W
			3000K	82 lm/W	1,483 lm	
			3500K	84 lm/W	1,520 lm	
			4000K	86 lm/W	1,539 lm	
			5000K	83 lm/W	1,489 lm	

TECHNICAL SPECIFICATIONS

CONSTRUCTION

Product Type

Slim style, edge-lit surface mount downlight

Shape

Round & Square

Enclosure Material

Steel heatsink with robust thermal-performance polyester; UV-resistant polyester trim ring

Finish

White

Lens

Acrylic light guide diffuses light evenly and smoothly, without hotspots

INSTALLATION

Mounting

Mounting Driver on board design allows for extremely thin fixture design without a driver on back, making it simple to install on most common junction boxes. Accessory available to mount fixture to existing recessed housings, sold separately.

COMPLIANCE

Listing

UL Listed

Environment

Suitable for use in dry, damp, and wet environments.

IC Rated

No

Air Tight

No

DLC Listed

No. There is no product category on the Design Lights Consortium (DLC) Qualified Products List for this product to qualify under.

T20 Compliant

No.

T24 JA8 Compliant

Can be used to conform with the requirements of California Title 24 Part 6

California Energy Commission (CEC) Status

Lawful for Sales in California

NEC Compliant

Suitable for use in closets. Compliant with NEC Sec. 410.16 (A)(1) and 410.16 (C1).

IESNA LM-79 & LM80 Testing

RAB LED luminaires and LED components have been tested by an independent laboratory in accordance with IESNA LM-79 and LM-80.

FCC

Complies with Part 15 of the FCC Rules.

RoHS

Mercury and UV free. RoHS-compliant components.

ELECTRICAL

Dimmable

Yes, dimmable down to 10% on compatible TRIAC/ELV dimming systems.

THD

≤20%

Power Factor

≥0.9

Flicker

≤30%

Input Voltage

120V

Operating Frequency

60Hz

Operating Temperature

-4°F to 104°F (-20°C to 40°C)

LED CHARACTERISTICS

Beam Angle

110°

Color Temperature

Field-adjustable dip switch 2700/3000/3500/4000/5000K

Color Accuracy (CRI)

>90

R9 Value

High color performance with R9 greater than or equal to 50

Color Consistency

4-step MacAdam Ellipse binning to achieve consistent fixture-to-fixture color

Color Stability

LED color temperature is warranted to shift no more than 200K in color temperature over a 5-year period.

Color Uniformity

RAB's range of Correlated Color Temperature follows the guidelines of the American National Standard for Specifications for the Chromaticity of Solid State Lighting (SSL) Products, ANSI C78.377-2017.

OTHER

Warranty

RAB warrants that our LED products will be free from defects in materials and workmanship for a period of five (5) years from the date of delivery to the end user, including coverage of light output, color stability, driver performance and fixture finish.

RAB's warranty is subject to all terms and conditions found at rablighting.com/warranty.

Slim, CCT-Adjustable SUMO



DIMENSIONS

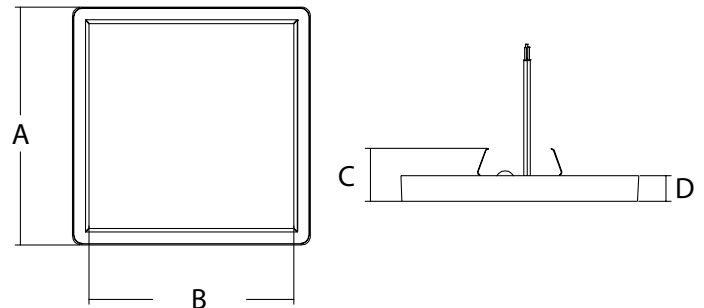
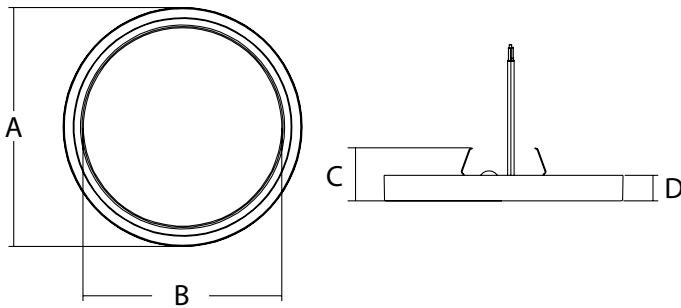

Catalog Number	Weight	A	B	C	D
SUMO-R-5	0.81 lb	5 ½"	4 ⅞"	1 ¼"	9/16"
SUMO-R-7	1.08 lbs	7"	6 ⅜"	1 ¼"	9/16"
SUMO-R-9	1.52 lbs	9"	8 ⅜"	1 ¼"	9/16"

Catalog Number	Weight	A	B	C	D
SUMO-S-5	0.90 lb	5 ½"	4 ⅞"	1 ¼"	9/16"
SUMO-S-7	1.26 lbs	7"	6 ⅜"	1 ¼"	9/16"
SUMO-S-9	1.80 lbs	9"	8 ⅜"	1 ¼"	9/16"

ACCESSORIES

Note: See Downlight Accessory Compatibility Guide at rablighting.com.

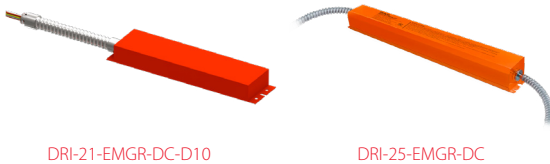

Catalog Number	UPC	Description
DRI-21-EMGR-DC-D10	192552028264	Emergency battery backup driver (field installed) T20 Compliant
DRI-25-EMGR-DC	019813519180	Emergency battery backup driver (field installed)

5.5" Color trim



7" Color trim



9" Color trim



Catalog Number	UPC	Description
SUMO-TRIM-R-5-BLK	192552039918	Color trim for 5.5" SM round black smooth
SUMO-TRIM-R-5-BN	192552039925	Color trim for 5.5" SM round brushed nickel smooth
SUMO-TRIM-R-5-BRZ	192552039932	Color trim for 5.5" SM round bronze smooth
SUMO-TRIM-R-7-BLK	192552039949	Color trim for 7" SM round black smooth
SUMO-TRIM-R-7-BN	192552039956	Color trim for 7" SM round brushed nickel smooth
SUMO-TRIM-R-7-BRZ	192552039963	Color trim for 7" SM round bronze smooth
SUMO-TRIM-R-9-BLK	192552039970	Color trim for 9" SM round black smooth
SUMO-TRIM-R-9-BN	192552039987	Color trim for 9" SM round brushed nickel smooth
SUMO-TRIM-R-9-BRZ	192552039994	Color trim for 9" SM round bronze smooth

ORDERING INFO

Catalog Number	Certification Model Number	UPC	Case Pack
SUMO-R-5	DLS0174(SUMO-R-5)	192552028844	4
SUMO-R-7	DLS0175(SUMO-R-7)	192552028851	4
SUMO-R-7/BP	DLS0175(SUMO-R-7)	192552018319	12
SUMO-R-9	DLS0176(SUMO-R-9)	192552028868	4
SUMO-S-5	DLS0177(SUMO-S-5)	192552028875	4
SUMO-S-7	DLS0178(SUMO-S-7)	192552028882	4
SUMO-S-9	DLS0179(SUMO-S-9)	192552028899	4

ORDERING MATRIX

Family	Shape		Size		Color Temperature		Driver	Finish	Qty Case Pack		
SUMO	-		-								
	R	Round	5	5.5" (10W)	Blank	Field-Adjustable	Blank	120V, Blank	White	Blank	1 Unit
	S	Square	7	7" (14W)	2700/3000/3500/4000/5000K			TRIAC/ELV		Blank	12-Pc Bulk Pack
			9	9" (18W)							

Slim, CCT-Adjustable SUMO

Dimmer Compatibility List



SUMO-R-5 SUMO-S-5
 SUMO-R-7 SUMO-S-7
 SUMO-R-7/BP SUMO-S-9
 SUMO-R-9

Visit www.rablighting.com for periodic updates to this list or contact us at 888-722-1000 for questions or comments.

Number	Dimmers		Quantities			
	Dimmer Brand	Dimmer Model	1	4	6	8
1	RAB	XDIM	✓	✓	✓	✓
2	RAB	XDIM/LCB	✓	✓	✓	✓
3	LUTRON	MACL-153M	✓	✓	✓	✓
4	LUTRON	SCL-153P	✓	✓	✓	✓
5	LEVITON	Cat.NO.6674	✓	✓	✓	✓
6	LUTRON	DVCL-153P	✓	✓	✓	✓
7	LEVITON	NO.6672	✓	✓	✓	✓
8	LEGRAND	RHCL453PTC	✓	✓	✓	✓
9	LEGRAND	DCL453PTCCCV6	✓	✓	✓	✓
10	LEGRAND	HCL453PTCCCV6	✓	✓	✓	✓
11	LUTRON	CTCL-153PDH-WH	✓	✓	✓	✓
12	LUTRON	TGCL-153PH-WH	✓	✓	✓	✓
13	LEVITON	R12-06672-1LW	✓	✓	✓	✓
14	LEVITON	R50-IPL06-10M	✓	✓	✓	✓
15	LUTRON	DVWCL-153PH-WH	✓	✓	✓	✓

CCT-Adjustable WFD34 Recessed Downlight, Contractor Pack **RAB**

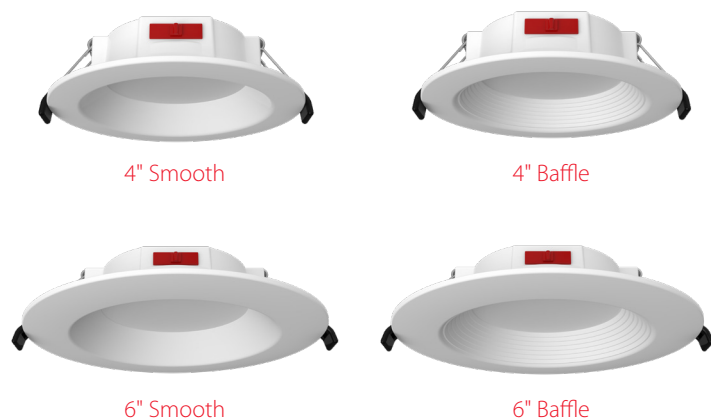

4" & 6", Smooth & Baffle, CCT-Adjustable,
120V, TRIAC Dimmable



PROJECT: _____

DATE: _____

TYPE: _____

PREPARED BY: _____



KEY FEATURES

- Recessed canless LED downlights designed for easy installation into new construction or remodel applications.
- **5 selectable color temperatures** in each fixture (2700/3000/3500/4000/5000K).
- **No housing required** and includes pre-wired junction box. IC and Air-Tight rated.
- **Available in smooth & baffle trims**, wet location rated, and CEC Title 24 compliant.
- Packaged in bulk case quantities of 12

PERFORMANCE

Catalog Number	Size	Trim Style	Wattage Equivalency	Input Wattage	Lumens	Efficacy (lm/W)	Dim Type	Input Voltage	Beam Angle	Color Temperature	CRI	L70 Lifespan	Environment								
WFD34-4/BP	4"	Smooth	40W Incandescent	7W	650 lm	86	TRIAC/ELV	120V	90°	Field adjustable via dip switch 2700/3000/3500/4000/5000K	90	30,000 hrs	Wet								
WFD34-4B/BP		Baffle																			
WFD34-6/BP	6"	Smooth	75W Incandescent	9.5W	900 lm	84															
WFD34-6B/BP		Baffle																			

4" WFD34 Smooth

Catalog Number	Wattage	Color Temperature (CCT)	Lumens (lm)	Efficacy (lm/W)	Equivalency
WFD34-4/BP	7W	2700K	593	85.3	40W Incandescent
		3000K	613	89.2	
		3500K	635	90.7	
		4000K	637	94.8	
		5000K	625	90.7	

4" WFD34 Baffle

Catalog Number	Wattage	Color Temperature (CCT)	Lumens (lm)	Efficacy (lm/W)	Equivalency
WFD34-4B/BP	7W	2700K	583	83.5	40W Incandescent
		3000K	606	88.7	
		3500K	623	91.5	
		4000K	635	93.7	
		5000K	628	90.7	

CCT-Adjustable WFD34 Recessed Downlight, Contractor Pack **RAB**

6" WFD34 Smooth

Catalog Number	Wattage	Color Temperature (CCT)	Lumens (lm)	Efficacy (lm/W)	Equivalency
WFD34-6/BP	9.5W	2700K	829	90.8	75W Incandescent
		3000K	868	93.8	
		3500K	909	95.7	
		4000K	878	93.7	
		5000K	850	93.0	

6" WFD34 Baffle

Catalog Number	Wattage	Color Temperature (CCT)	Lumens (lm)	Efficacy (lm/W)	Equivalency
WFD34-6B/BP	9.5W	2700K	816	88.3	75W Incandescent
		3000K	854	90.1	
		3500K	891	95.3	
		4000K	861	94.2	
		5000K	845	90.9	

TECHNICAL SPECIFICATIONS

CONSTRUCTION

Product Type

Canless Recessed Downlight

Size

4", 6"

Shape

Round

Enclosure Material

Dead front (non-metallic) trim for corrosive environments.

Finish

White

Lens Finish

Polycarbonate light diffuser distributes light evenly and smoothly for general lighting applications.

ELECTRICAL

Dimmable

Yes, dimmable down to 10% on compatible TRIAC/ELV dimming systems. See Dimmer Compatibility List.

Input Voltage

120V

Operating Frequency

60 Hz

Operating Temperature

-4°F to 104°F (-20°C to 40°C)

Power Factor

0.9

Flicker

<30%

LED CHARACTERISTICS

Beam Angle

90°

Color Temperature

Field adjustable via dip switch 2700/3000/3500/4000/5000K

Color Accuracy (CRI)

90

R9 Value

High color performance with R9 greater than 50

Color Consistency

<5-step (2700K & 5000K); <7-step (3000/3500/4000K) MacAdam Ellipse binning to achieve consistent fixture-to-fixture color.

COMPLIANCE

Listings

UL Listed

Environment

Suitable for use indoors and outdoors in dry, damp, or wet environments.

IC Rated

Suitable for direct contact with insulation. Type IC inherently protected, suitable for direct contact to air permeable insulation and cULus listed for damp locations. Not for use in direct contact with spray foam insulation, consult NEMA LSD57-2013.

Air Tight

Airtight certified per ASTM-E283.

California Title 24 JA8 Compliant

Can be used to conform with the requirements of California Title 24 Part 6.

California Energy Commission (CEC) Status

Lawful for Sales in California

NEC Compliant

Suitable for use in closets. Compliant with NEC Sec. 410.16 (A)(1) and 410.16 (C3).

IESNA LM-79 & LM80 Testing

RAB LED luminaires and LED components have been tested by an independent laboratory in accordance with IESNA LM-79 and LM-80.

RoHS

Mercury and UV free. RoHS-compliant components.

FCC

Complies with Part 15 of the FCC Rules

TECHNICAL SPECIFICATIONS (CONTINUED)

REMOTE DRIVER CONSTRUCTION

Remote Driver/Junction Box

- Aluminum driver / junction box with captive hinged junction box cover.
- Listed for (6) #12 AWG 90°C splice conductors, 2-in, 2-out plus (2) ground.
- Integral keyhole mounting slots facilitate direct mounting to building structure or new construction mounting frame.

Mounting

- Utilizes a remote driver with built-in junction box and quick disconnect; Eliminates the need for traditional downlight housings.
- Integral keyhole mounting tabs facilitate direct mounting to building structures or new construction mounting frames (sold separately).

WARRANTY

The RAB 3-year, limited warranty covers light output, driver performance and paint finish. RAB's warranty is subject to all terms and conditions found at rablighting.com/warranty.

DIMENSIONS

4" SMOOTH

Weight 5.31lbs

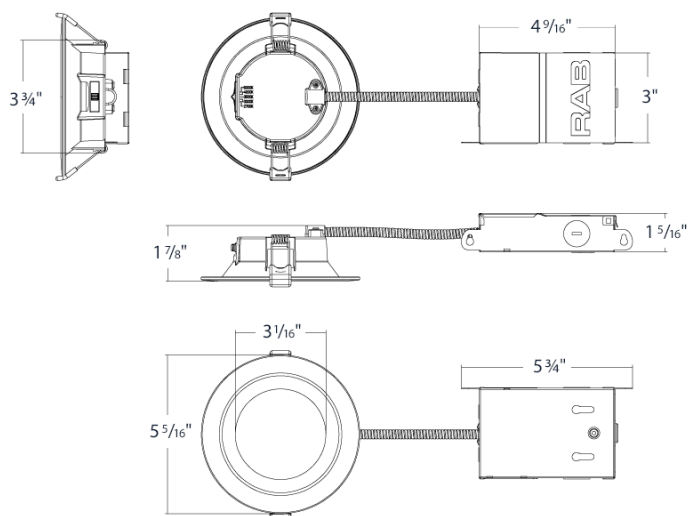

4" BAFFLE

Weight 5.31lbs

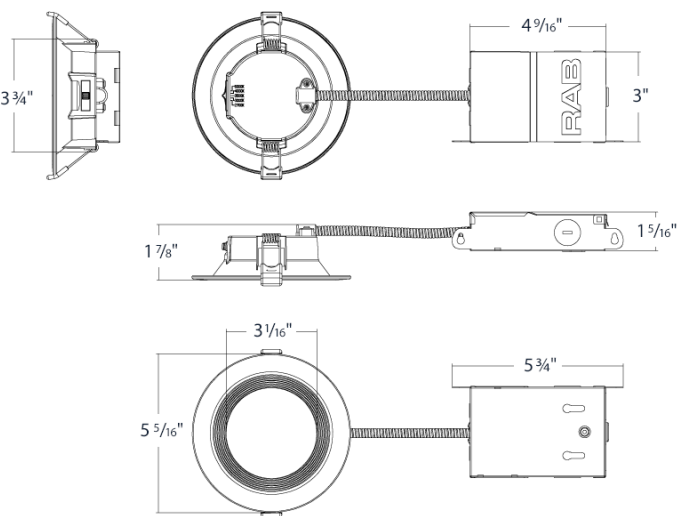

6" SMOOTH

Weight 7.34lbs

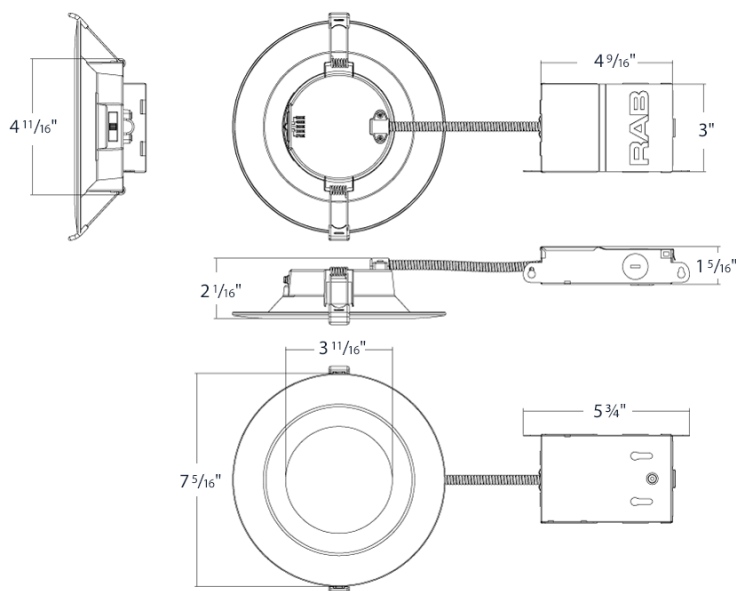

6" BAFFLE

Weight 7.34lbs

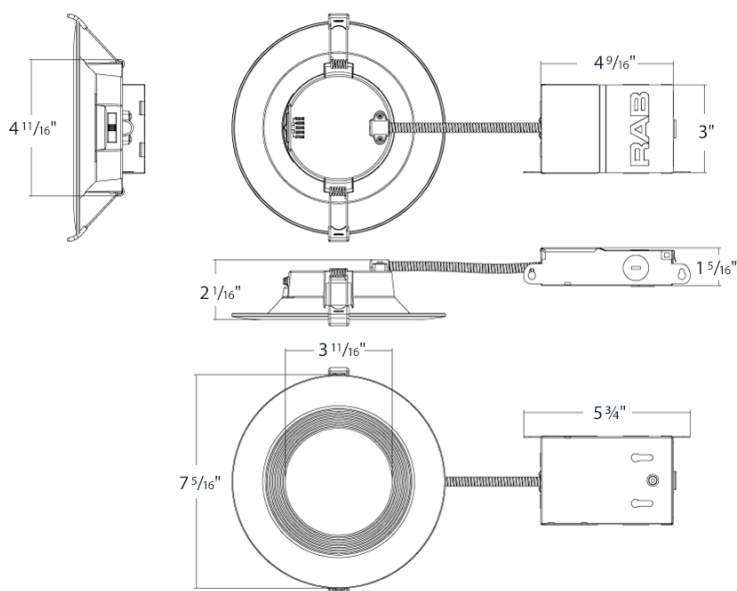

CCT-Adjustable WFD34 Recessed Downlight, Contractor Pack

RAB

ORDERING INFO

Catalog Number	Model Number	UPC	Case Pack
WFD34-4/BP	DLW0142(WFD34-4)	192552046152	12
WFD34-4B/BP	DLW0143(WFD34-4B)	192552046169	12
WFD34-6/BP	DLW0144(WFD34-6)	192552046176	12
WFD34-6B/BP	DLW0145(WFD34-6B)	192552046183	12

ORDERING MATRIX

Family	Size/Wattage		Shape		CRI/Color Temp			Driver	Finish		Trim		Options			
WFD34	-															
	4 6	4"/7W 6"/9.5W	Blank	Round	Blank	90CRI, 2700/3000/3500/4000/5000K CCT Adjustable			Blank	120V, TRIAC/ELV	Blank	White	Blank B	Smooth Baffle	/BP	Bulk 12-Pack

Dimmer Compatibility List

WFD34-4/BP WFD34-4B/BP

WFD34-6/BP WFD34-6B/BP

Visit www.rablighting.com for periodic updates to this list or contact us at 888-722-1000 for questions or comments.

Dimmers			Lamp Quantities				Dimming Level
Dimmer Brand	Series	Dimmer Model	1	4	8	10	
LUTRON	Maestro C-L	MACL-153M	✓	✓	✓	✓	10-100%
LUTRON	Skylark C-L	SCL-153P	✓	✓	✓	✓	10-100%
LEVITON	Sureslide	Cat.NO.6674	✓	✓	✓	✓	10-100%
LUTRON	Diva C-L	DVCL-153P	✓	✓	✓	✓	10-100%
LUTRON	Skylark	CTCL-153PDH-WH	✓	✓	✓	✓	10-100%
LUTRON	Toggler	TGCL-153PH-WH	✓	✓	✓	✓	10-100%
LUTRON	Diva C-L	DVWCL-153PH-WH	✓	✓	✓	✓	10-100%
RAB		XDIM	✓	✓	✓	✓	10-100%

CCT-Adjustable WFR34, Contractor Pack



4" & 6", Smooth & Baffle, CCT Adjustable,
120V TRIAC Dimmable



PROJECT:

DATE:

TYPE:

PREPARED BY:



KEY FEATURES

- Slim, canless, LED recessed downlights designed for easy installation into new construction or remodel applications.
- **5 selectable color temperatures** in each fixture (2700/3000/3500/4000/5000K).
- **No housing required** and includes pre-wired junction box. IC and Air-Tight rated.
- **Available in smooth & baffle trims**, wet location rated, and CEC Title 24 compliant.
- Packaged in bulk case quantities of 12

PERFORMANCE

Catalog Number	Size	Trim Style	Wattage Equivalency	Input Wattage	Lumens	Efficacy (lm/W)	Dim Type	Input Voltage	Beam Angle	Color Temperature	CRI	L70 Lifespan	Environment							
WFR34-4/BP	4"	Smooth	40W Incandescent	9W	650 lm	72	TRIAC/ELV	120V	110°	Field adjustable via dip switch 2700/3000/3500/4000/5000K	90	30,000 hrs	Wet							
WFR34-4B/BP		Baffle																		
WFR34-6/BP	6"	Smooth	75W Incandescent	13W	1000 lm	69														
WFR34-6B/BP		Baffle																		

4" WFR34 Smooth

Catalog Number	Wattage	Color Temperature (CCT)	Lumens (lm)	Efficacy (lm/W)	Equivalency
WFR34-4/BP	9W	2700K	547	60.9	40W Incandescent
		3000K	601	67.6	
		3500K	638	72.8	
		4000K	653	74.2	
		5000K	625	69.6	

4" WFR34 Baffle

Catalog Number	Wattage	Color Temperature (CCT)	Lumens (lm)	Efficacy (lm/W)	Equivalency
WFR34-4B/BP	9W	2700K	535	59.4	40W Incandescent
		3000K	589	65.8	
		3500K	616	69.7	
		4000K	631	71.0	
		5000K	604	67.2	

CCT-Adjustable WFR34, Contractor Pack



6" WFR34 Smooth

Catalog Number	Wattage	Color Temperature (CCT)	Lumens (lm)	Efficacy (lm/W)	Equivalency
WFR34-6/BP	13W	2700K	897	70.7	75W Incandescent
		3000K	949	75.6	
		3500K	1,019	82.4	
		4000K	1,040	83.8	
		5000K	1,015	80.4	

6" WFR34 Baffle

Catalog Number	Wattage	Color Temperature (CCT)	Lumens (lm)	Efficacy (lm/W)	Equivalency
WFR34-6B/BP	13W	2700K	865	67.9	75W Incandescent
		3000K	909	72.0	
		3500K	969	77.7	
		4000K	990	78.6	
		5000K	965	75.5	

TECHNICAL SPECIFICATIONS

CONSTRUCTION

Product Type

Slim, canless wafer downlights

Size

4", 6"

Shape

Round

Enclosure Material

Dead front (non-metallic) trim for corrosive environments. Aluminum back plate for effective heat dissipation.

Finish

White

Lens Finish

Polycarbonate light diffuser distributes light evenly and smoothly for general lighting applications.

ELECTRICAL

Dimmable

Yes, dimmable down to 10% on compatible TRIAC/ELV dimming systems. See Dimmer Compatibility List.

Input Voltage

120V

Operating Frequency

60 Hz

Operating Temperature

-4°F to 104°F (-20°C to 40°C)

Power Factor

0.9

Flicker

<30%

LED CHARACTERISTICS

Beam Angle

110°

Color Temperature

Field adjustable via dip switch 2700/3000/3500/4000/5000K

Color Accuracy (CRI)

90

R9 Value

High color performance with R9 greater than 50

Color Consistency

<5-step (2700K & 5000K); <7-step (3000/3500/4000K) MacAdam Ellipse binning to achieve consistent fixture-to-fixture color.

COMPLIANCE

Listings

UL Listed

Environment

Suitable for use indoors and outdoors in dry, damp, or wet environments.

IC Rated

Suitable for direct contact with insulation. Type IC inherently protected, suitable for direct contact to air permeable insulation and cULus listed for damp locations. Not for use in direct contact with spray foam insulation, consult NEMA LSD57-2013.

California Title 24 JA8 Compliant

Can be used to conform with the requirements of California Title 24 Part 6.

California Energy Commission (CEC) Status

Lawful for Sales in California

NEC Compliant

Suitable for use in closets. Compliant with NEC Sec. 410.16 (A)(1) and 410.16 (C3).

IESNA LM-79 & LM80 Testing

RAB LED luminaires and LED components have been tested by an independent laboratory in accordance with IESNA LM-79 and LM-80.

RoHS

Mercury and UV free. RoHS-compliant components.

FCC

Complies with Part 15 of the FCC Rules

CCT-Adjustable WFR34, Contractor Pack



TECHNICAL SPECIFICATIONS (CONTINUED)

REMOTE DRIVER CONSTRUCTION

Remote Driver/Junction Box

- Aluminum driver / junction box with captive hinged junction box cover.
- Listed for (6) #12 AWG 90°C splice conductors, 2-in, 2-out plus (2) ground.
- Integral keyhole mounting slots facilitate direct mounting to building structure or new construction mounting frame.

Mounting

- Utilizes a remote driver with built-in junction box and quick disconnect; Eliminates the need for traditional downlight housings.
- Integral keyhole mounting tabs facilitate direct mounting to building structures or new construction mounting frames (sold separately).

WARRANTY

The RAB 3-year, limited warranty covers light output, driver performance and paint finish. RAB's warranty is subject to all terms and conditions found at rablighting.com/warranty.

DIMENSIONS

4" SMOOTH

Weight .72lbs

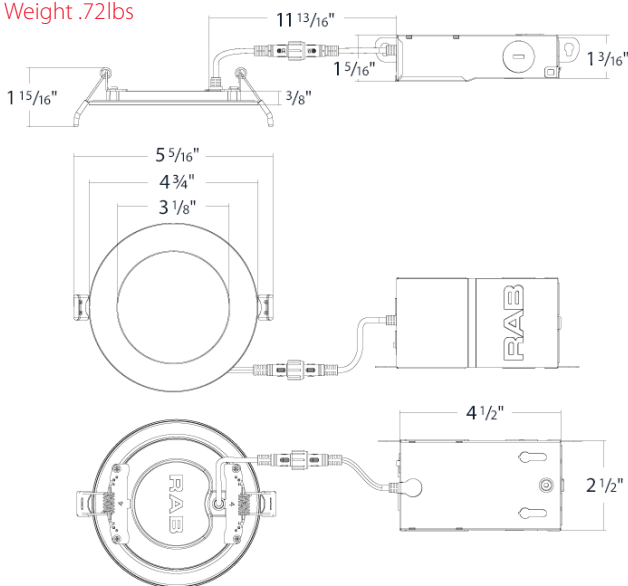

4" BAFFLE

Weight .72lbs

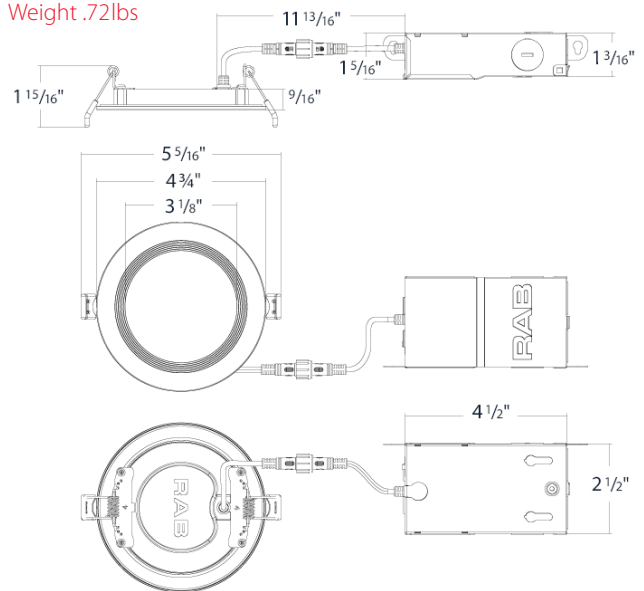

6" SMOOTH

Weight .94lbs

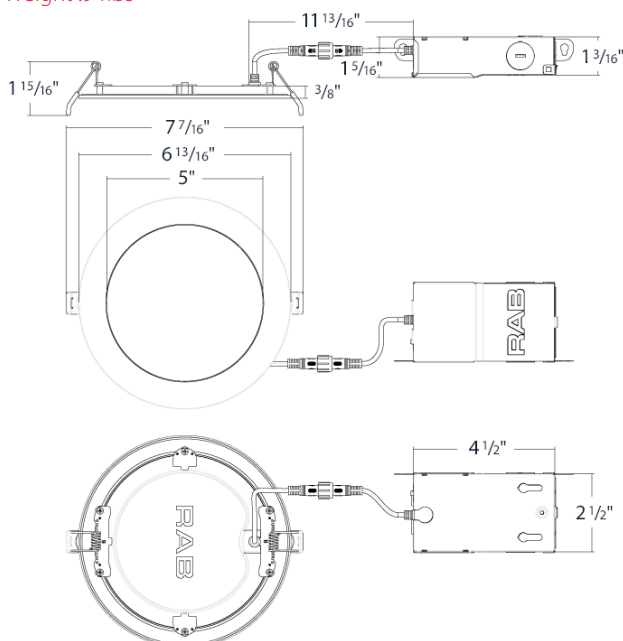

6" BAFFLE

Weight .94lbs

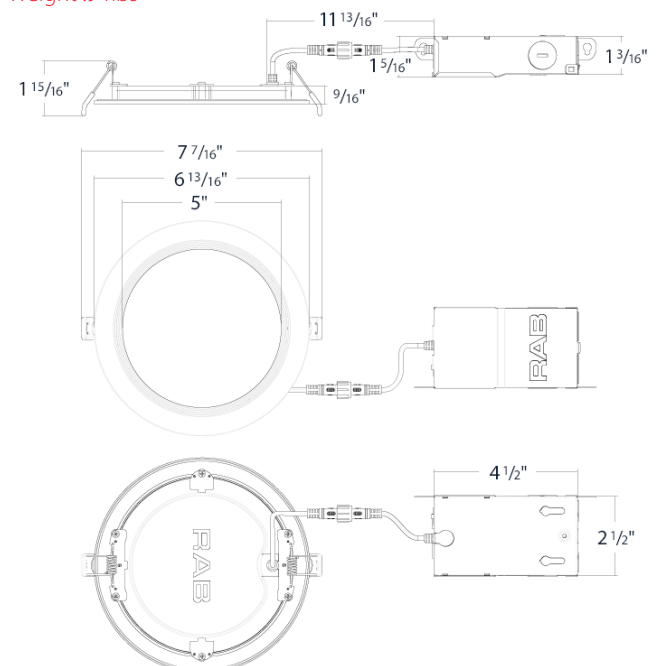

CCT-Adjustable WFR34, Contractor Pack



ORDERING INFO

Catalog Number	Model Number	UPC	Case Pack
WFR34-4/BP	DLW0146(WFR34-4)	192552046114	12
WFR34-4B/BP	DLW0147(WFR34-4B)	192552046121	12
WFR34-6/BP	DLW0148(WFR34-6)	192552046138	12
WFR34-6B/BP	DLW0149(WFR34-6B)	192552046145	12

ORDERING MATRIX

Family	Size/Wattage	Shape	CRI/Color Temp	Driver	Finish	Trim	Options
WFR34	<div><div>-</div><div>4 4"/9W 6 6"/13W</div></div>	<div><div></div><div>Blank Round</div></div>	<div><div></div><div>Blank 90CRI, 2700/3000/3500/4000/5000K CCT Adjustable</div></div>	<div><div></div><div>Blank 120V, TRIAC/ELV</div></div>	<div><div></div><div>Blank White</div></div>	<div><div></div><div>Blank B Smooth Baffle</div></div>	<div><div></div><div>/BP Bulk 12-Pack</div></div>

CCT-Adjustable WFR34, Contractor Pack



Dimmer Compatibility List

WFR34-4/BP WFR34-4B/BP
WFR34-6/BP WFR34-6B/BP

Visit www.rablighting.com for periodic updates to this list or contact us at 888-722-1000 for questions or comments.

Dimmers		Lamp Quantities						Dimming Level
Dimmer Brand	Dimmer Model	1	2	3	4	5	6	
LUTRON	SCL-153P	✓	✓	✓	✓	✓	✓	10-100%
LUTRON	DVCL-153P	✓	✓	✓	✓	✓	✓	10-100%
LEGRAND	DCL453PTCCCV6	✓	✓	✓	✓	✓	✓	10-100%
LUTRON	TGCL-153PH-WH	✓	✓	✓	✓	✓	✓	10-100%
LEVITON	R50-IPL06-10M	✓	✓	✓	✓	✓	✓	10-100%
LUTRON	DVWCL-153PH-WH	✓	✓	✓	✓	✓	✓	10-100%
RAB	XDIM	✓	✓	✓	✓	✓	✓	10-100%
RAB	DRA012M3-500	✓	✓	✓	✓	✓	✓	10-100%

LED Ready Downlight Housings



NDCANIC4R



NDCANIC6R



RDCANIC4R



RDCANIC6R

4" & 6", IC Air-Tight LED Dedicated Housings, New Construction & Remodel



AIRTIGHT



IC RATED



DAMP
RATED



120V

PROJECT:

DATE:

TYPE:

PREPARED BY:



KEY FEATURES

- IC rated for direct contact with insulation
- Quick connect provided for electrical connection to the LED trim
- Air-tight in accordance to ASTM E283
- Damp location (*Wet location when used with compatible luminaire*)
- 24-1/2" bar hangers included with captive nails and alignment foot

TECHNICAL SPECIFICATIONS

CONSTRUCTION

Product Type

IC Air-Tight LED Dedicated Recessed housings

Size

4", 6"

Housing

0.040 aluminum housing with riveted cap adjusts for ceiling thicknesses from 5/8" to 1-1/4"

Nailer Bars

Two 13-3/4" to 24-1/2" adjustable bar hangers with captive nails are included on frame. Hanger bars have T-Bar slot and alignment feet. Bar hangers are parallel to junction box, but can be repositioned 90° perpendicular to junction box if desired. "L" Shaped bar hanger foot to align to bottom of construction joist. A T-Bar notch allows easy installation in a suspended ceiling.

Junction Box

Prewired 25 cubic inch 0.064" thick galvanized steel box with seven 1/2" trade size knockouts and snap on covers. All leads are #18AWG wire, the ground wire is connected to the bottom, and quick connectors are supplied on all leads. Maximum of 8 no. 12 AWG through branch circuit conductors suitable for at least 90°C permitted in junction box.

Romex Strain Relief

Junction box includes two Romex tabs with two slots at each tab for NM-cables of 12/2 to 14/2. The strain relief allows for easy installation and less materials.

Junction Box

ND - New construction housing

RD - Remodel housing

ELECTRICAL

Dimmable

Specified by downlight

Input Voltage

120V

Operating Temperature

122°F (50°C) max.

Socket

Quick connect for LED downlights

COMPLIANCE

Listings

UL Listed

Environment

Suitable for use indoors in dry and damp environments.

IC Rating

Suitable for direct contact with insulation.

Type IC inherently protected, suitable for direct contact to air permeable insulation and cULus listed for damp locations. Not for use in direct contact with spray foam insulation, consult NEMA LSD57-2013.

Air Tight

Airtight certified per ASTM-E283

California Title 24 JA8 Compliant

Can be used to conform with the requirements of California Title 24 Part 6.

California Energy Commission (CEC) Status

Lawful for Sale in California

RoHS

Mercury and UV free. RoHS-compliant components.

TECHNICAL SPECIFICATIONS (CONT'D)

INSTALLATION

Compatible Products

R34, R4R, R6R, R34X, SUMO, DISK34

OTHER

Warranty

The RAB 5-year, limited warranty covers light output, driver performance and paint finish. RAB's warranty is subject to all terms and conditions found at rablighting.com/warranty.

DIMENSIONS

NDCANIC4R

Weight: 1.76 lb

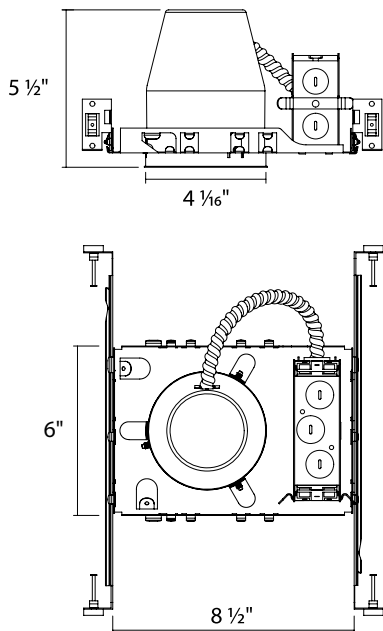

NDCANIC6R

Weight: 2.12 lb

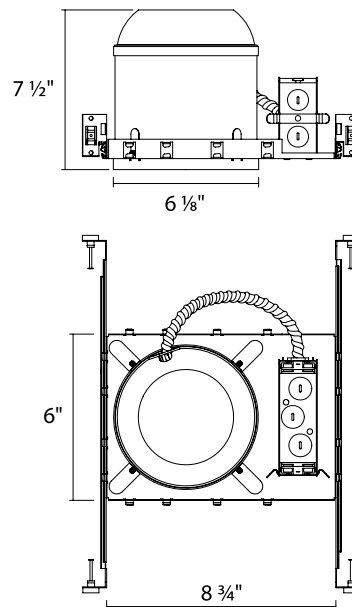

RDCANIC4R

Weight: 1.1 lbs

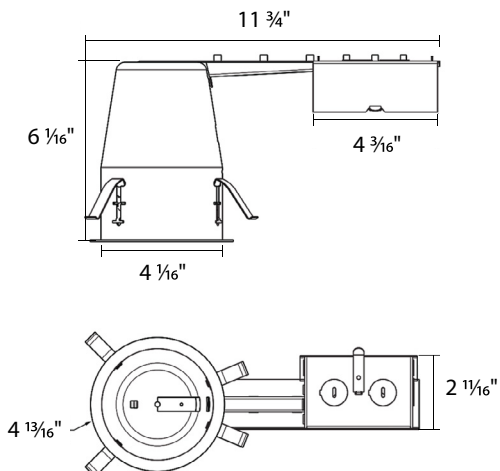

RDCANIC6R

Weight: 1.19 lbs

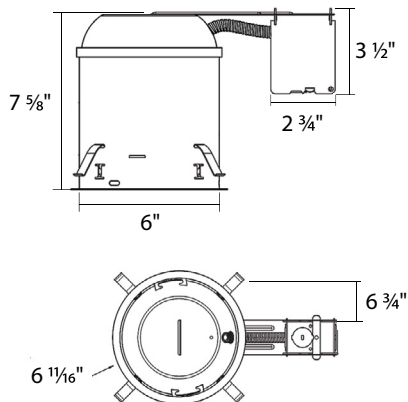

ORDERING INFO

Catalog	UPC	Case Pack
NDCANIC4R	019813702346	6
NDCANIC6R	019813702353	6
RDCANIC4R	019813702322	6
RDCANIC6R	019813702339	6

ORDERING MATRIX

Family	IC / Air-Tight		Size/Wattage		Shape	
NDCAN						
New Construction	IC	IC Rated & Air-Tight	4	4"	R	Round
RDCAN			6	6"		
Remodel						