

# INSTRUCTIONS

## T5HE/T5HO Ballast Compatible Glass



RAB Lighting is committed to creating high-quality, affordable, well-designed and energy-efficient LED lighting and controls that make it easy for electricians to install and end users to save energy. We'd love to hear your comments. Please call the Marketing Department at 888-RAB-1000 or email: [marketing@rablighting.com](mailto:marketing@rablighting.com)

T5HO-9-24G-8XX-DIR  
T5HO-18-36G-8XX-DIR  
T5HO-25-48G-8XX-DIR  
T5HE-6-24G-8XX-DIR  
T5HE-9-36G-8XX-DIR  
T5HE-13-48G-8XX-DIR



### IMPORTANT

#### READ CAREFULLY BEFORE INSTALLING FIXTURE. RETAIN THESE INSTRUCTIONS FOR FUTURE REFERENCE.

RAB LED tubes must be wired in accordance with the National Electrical Code and all applicable local codes. Proper grounding is required for safety. THIS PRODUCT MUST BE INSTALLED IN ACCORDANCE WITH THE APPLICABLE INSTALLATION CODE BY A PERSON FAMILIAR WITH THE CONSTRUCTION AND OPERATION OF THE PRODUCT AND THE HAZARDS INVOLVED.

#### WARNING:

1. Risk of shock. Disconnect power before installation.
2. LED T5 lamp for use only with products described and installed in accordance with product specifications. LED T5 lamp to be operated with fluorescent electronic ballast.
3. RISK OF FIRE, USE ONLY IN PLACE OF FLUORESCENT LAMPS SPECIFIED ON LABEL. RISK OF ELECTRIC SHOCK-DO NOT USE WHERE DIRECTLY EXPOSED TO WATER, SUITABLE FOR DAMP LOCATIONS.
4. DIRECT REPLACEMENT FOR 24W/550mmT5/G5/HF, 39W/850mmT5/G5/HF, 54W/1150mmT5/G5/HF, 14W/550mmT5/G5/HF, 21W/850mmT5/G5/HF, 28W/1150mmT5/G5/HF LAMPS ONLY
5. For the compatible ballast list, please refer to RAB's website - [rablighting.com](http://rablighting.com).

### INSTALLATION INSTRUCTIONS

1) Turn Power OFF

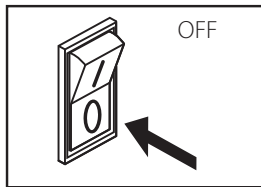

2) Remove lens or diffuser (if applicable)

3) Remove existing fluorescent lamps from the luminaire.

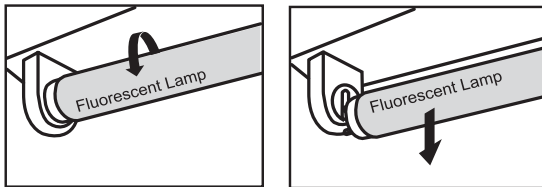

4) Bring LED lamp to luminaire and insert lamp pins into luminaire lamp holders

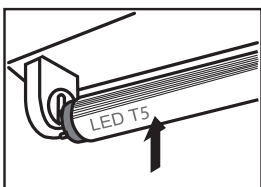

5) Rotate LED lamp until lamp locks in place. Ensure that the LED lamp front points away from the back of the luminaire.

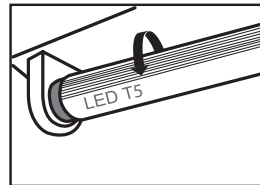

6) Place lens or diffuser back in place (if applicable)

7) Switch power ON.

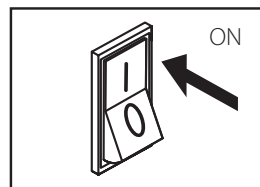

# INSTRUCTIONS

## T5HE/T5HO Ballast Compatible Glass



RAB Lighting is committed to creating high-quality, affordable, well-designed and energy-efficient LED lighting and controls that make it easy for electricians to install and end users to save energy. We'd love to hear your comments. Please call the Marketing Department at 888-RAB-1000 or email: [marketing@rablighting.com](mailto:marketing@rablighting.com)

### SAFETY INFORMATION

---

1. Check the lamp before installation, if there is any damage caused during transportation, do not install.
2. Maintenance should be carried out by technical personnel only.
3. Keep the lamp away from flame or high temperature objects.
4. Only for indoor use.
5. If the glass lamp tube is broken, the lamp must be disposed immediately!

### MAINTENANCE NOTES

---

1. Disconnect lamp from power supply before any maintenance.
2. Clean luminaire with dry cloth.
3. Do not clean the lamp with corrosive chemicals.

**DO NOT INSTALL THIS LAMP IN A PRE-HEATED LUMINAIRE.**

**THIS LAMP ONLY OPERATES ON ELECTRONIC BALLASTS. IF LAMP DOES NOT LIGHT WHEN THE LUMINAIRE IS ENERGIZED, REMOVE LAMP FROM LUMINAIRE AND CONTACT LAMP MANUFACTURER OR QUALIFIED ELECTRICIAN.**

**CAUTION, RISK OF FIRE - IF THE LAMP OR LUMINAIRE EXHIBITS UNDESIREABLE OPERATION (BUZZING, FLICKERING, ETC.), IMMEDIATELY TURN OFF POWER, REMOVE LAMP FROM LUMINAIRE AND CONTACT RAB.**

**THIS DEVICE IS NOT INTENDED FOR USE WITH EMERGENCY EXITS.**



© 2020 RAB LIGHTING Inc.  
Northvale, New Jersey 07647 USA

#### Easy Answers

[rablighting.com](http://rablighting.com)  
Visit our website for product info

Tech Help Line  
Call our experts: 888 722-1000

e-mail  
Answered promptly - [sales@rablighting.com](mailto:sales@rablighting.com)

Free Lighting Layouts  
Answered online or by request

Ballast Compatible T5

**RAB WARRANTY:** RAB's warranty is subject to all terms and conditions found at [rablighting.com/warranty](http://rablighting.com/warranty).