



High-end, new construction LED downlights in 6" make installation a breeze when you're framing out a space from the ground up or when you have access from the top of the ceiling. .

Color: Silver trim specular silver cone Weight: 2.4 lbs

Project:	Type:
Prepared By:	Date:

Driver Info		LED Info	
Type	Sold Separately	Watts	N/A
120V	N/A	Color Temp	3500K (Warm Neutral)
208V	N/A	Color Accuracy	90 CRI
240V	N/A	L70 Lifespan	100,000 Hours
277V	N/A	Lumens	N/A
Input Watts	See Rough-in*	Efficacy	N/A

Technical Specifications

Compliance

UL Listed:
Suitable for wet locations covered ceiling

Energy Star Approved:
ENERGY STAR® Version 2.0 Certified

Construction

Trim Component:
This component must be ordered with New Construction Round Rough-In in order to make a complete fixture. [See here for New Construction Round Rough-In.](#)

Housing:
Professional-grade, die-cast aluminum construction

Trim Ring:
Silver powder coated die cast trim ring

Trim Cone:
Specular silver round trim cone

Drop Ceiling Installation:
NDLED can be installed in drop ceiling tiles when using optional c-channel bars and following local construction codes

Aperture Size:
6" Trim Module

Easy Installation:
The EZ-Connector makes installation easy

Junction Box:
Integral junction box with wiring capacity for Min 90°C supply conductors
4 in 4 out

Air Tight:
Housing certified Air Tight as per ASTM-E283

Electrical
Dimming Driver:
0 - 10V (at 120-277V), TRIAC and ELV (at 120V only).
[See dimmer compatibility guide here.](#)

Dimming:
Dimmable. Requires rough-in with dimming driver.

Optical
Optics:
80° beam spread with specular thermoplastic optics and Nanostructure lens technology for smooth light output and high efficiency

LED Characteristics
Color Consistency:
3-step MacAdam Ellipse binning to achieve consistent fixture-to-fixture color

Other
5-Year, No-Compromise Warranty:
RAB warrants that our LED products will be free from defects in materials and workmanship for a period of five (5) years from the date of delivery to the end user, including coverage of light output, color stability, driver performance and fixture finish. RAB's warranty is subject to all terms and conditions found at rablighting.com/warranty.

Dimensions

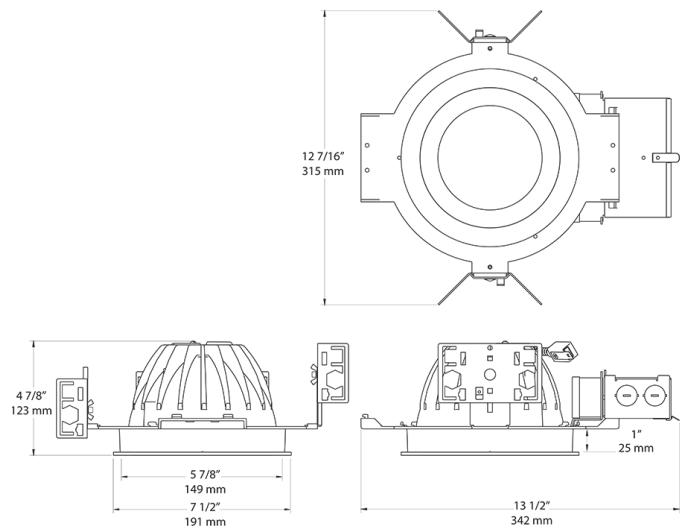

Features

- Butterfly bracket allows mounting with bar stock, "C" channel, 1/2" conduit or nailer bars
- Low-profile design allows for installation in ceilings with limited space
- Absolute White 3-step consistency and black body accurate
- Nanostructure lens eliminates "hot spots" providing smooth and efficient light

Ordering Matrix

Family	Size	Shape	Driver	Beam Spread	Color Temp	CRI	Cone Color	Trim Color
NDLED	6	R	D	80	YN	HC	S	S
<p>6 = 6" R = Round D = Universal Dimming 50 = 50 degrees N = 4000K Neutral Blank = 82 CRI S = Specular S = Silver</p> <p>80 = 80 degrees YN = 3500K Warm Neutral HC = 92 CRI M = Matte Silver W = White W = White</p> <p>W = Wall Washer YY = 2700K Residential Warm B = Black</p>								